

Technical Data

| No. of Positions | DIM"A" | DIM"B" |
|------------------|--------|--------|
| 18 | 22.86 | 20.32 |
| 20 | 25.40 | 22.86 |
| 22 | 27.94 | 25.40 |
| 24 | 30.48 | 27.94 |
| 28 | 35.56 | 33.02 |
| 32 | 40.64 | 38.10 |
| 40 | 50.80 | 48.26 |
| 48 | 60.96 | 58.42 |

Material:

Pin(outer sleeve): Brass,machined CuZn38Pb2
 Clip(contact 4 finger): Beryllium Copper,heat treated
 Plating(outer sleeve):
 Tin plated:2µm/80µ"Ni, 5µm/200m"Sn
 Gold Plated:2µm/80µ"Ni, Full gold
 Plating(contact): 2µm/80µ"Ni, gold or Tin plated
 Insulator(black): Glass filled thermoplastic polyester
 UL94V-0

Electrical:

Current rating: 3Amps/contact max.
 Contact resistance: ≤4mΩ/contact
 Insulation resistance: ≥1000MΩ at V=100V
 Operating voltage: 60VAC/DC

Mechanical:

Average insertion force with steel pin of Ø0.43mm/0.17": <250g
 Average withdrawal force with steel pin of Ø0.43mm/0.17": >50g min.
 Mechanical life cycle:min.200
 Operating temperatures: Gold Plated:-55°C to+105°C
 Tin plated:-40°C to+105°C

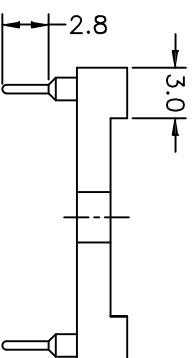
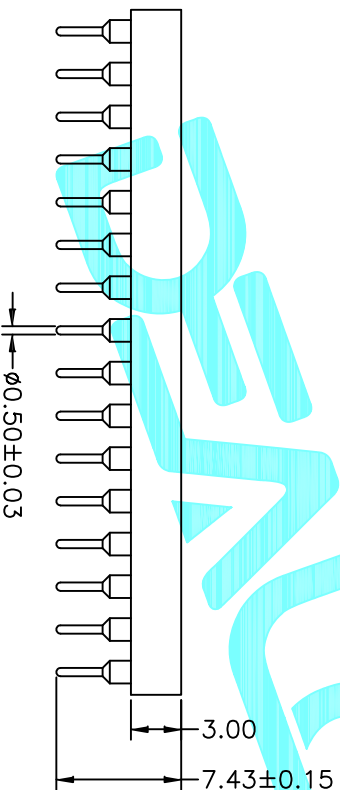
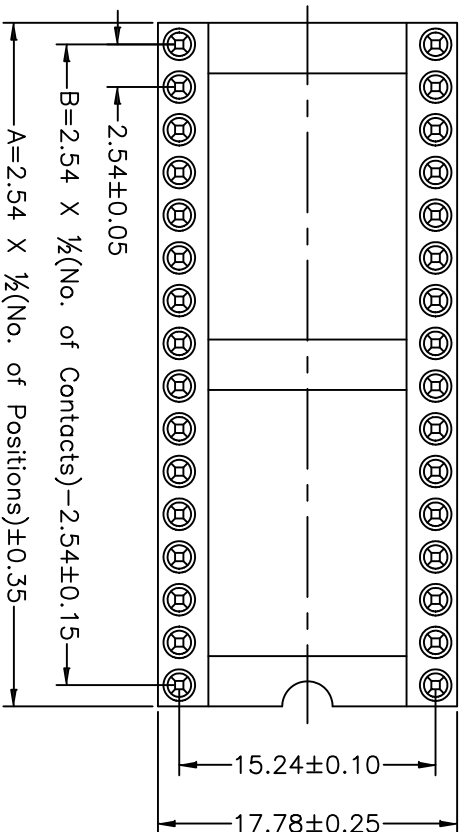

| APPROVALS | | DATE | DRAWING NO. | |
|---------------------|----------|-----------|-----------------------------------|-----------------|
| DRAWN | G.M.Chen | 2015/5/29 | ELECTRONICS CO.,LTD | |
| CHECKED | | | TITLE: 2.54mmPitch IC Sockets DIP | |
| APPROVALS | | | PART NO. | IC254R-22-XX-73 |
| TOLERANCES ARE | | | UNIT: mm | SCALE: 1:1 |
| 30 ^{±0.15} | ±0.30 | ANGLE | | SHEET 1 OF 1 |
| 10 ^{±0.10} | ±0.20 | | | PROJ. |
| 5 ^{±0.10} | ±0.15 | ±2° | | |

| ECN NO. | REV. | DATE. | DESCRIPTION. |
|---------|------|-------|--------------|
| | A | | NEW |