

THIS COPY IS PROVIDED ON A RESTRICTED BASIS AND IS NOT TO BE USED IN ANY WAY DETRIMENTAL TO THE INTERESTS OF PANDUIT CORP.

PANDUIT PART #	STUD SIZE		DIMENSIONS in. [mm]				
	ENGLISH	METRIC	L ± .03 [0,51]	W ± .01 [0,25]	C ± .02 [0,38]	M ± .03 [0,51]	H ± .01 [0,25]
PV18-4R	#4	--	.84 [21,3]	.25 [6,4]	.22 [5,6]	.69 [17,5]	.12 [3,1]
PMV1-3RB	--	M3	.82 [20,83]	.23 [5,84]	.22 [5,59]	.70 [17,78]	.13 [3,30]
PV18-6R	#6	M3,5	.86 [21,8]	.25 [6,4]	.22 [5,6]	.70 [17,8]	.15 [3,8]
PV18-8R	#8	M4	.91 [23,1]	.31 [7,9]	.26 [6,6]	.78 [19,8]	.17 [4,3]
PV18-10R	#10	--	.94 [23,9]	.31 [7,9]	.27 [6,9]	.78 [19,8]	.20 [5,1]
PMV1-5RB	--	M5	.91 [23,11]	.35 [8,89]	.29 [7,37]	.75 [19,05]	.21 [5,33]
PV18-14R	1/4"	M6	1.11 [28,2]	.46 [11,7]	.37 [9,4]	.88 [22,4]	.27 [6,9]
PV18-56R	5/16"	M8	1.11 [28,2]	.46 [11,7]	.39 [9,9]	.88 [22,4]	.34 [8,6]
PV18-38R	3/8"	--	1.19 [30,2]	.53 [13,5]	.42 [10,7]	.96 [24,4]	.40 [10,2]
PV18-12R	1/2"	M12	1.42 [36,1]	.72 [18,3]	.53 [13,5]	1.06 [26,9]	.52 [13,2]

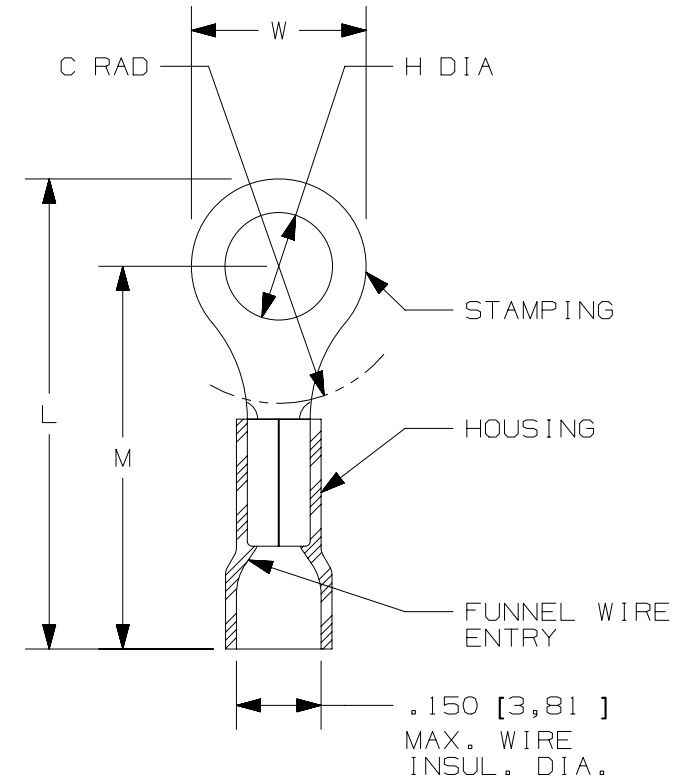

NOTES:

- USED FOR:
 - A. 22-16 AWG [0,5-1,5 mm²] SOLID OR STRANDED COPPER WIRE
 - B. 221°F [105°C] MAX. OPERATING TEMPERATURE
 - C. 600V. MAX. BLDG WIRE (1000 V. MAX. IN SIGNS, FIXTURES & LUMINAIRES)
- INSTALLATION TOOLS PANDUIT APPROVED:
 - A. UL APPROVED: CT-100A, CT-600-A (CT-550CH) CT-1550, CT-1551, CT-2500 (CT-2550CH)
 - B. PANDUIT APPROVED: CT-160, CT-260, CT-400
- WIRE STRIP LENGTH: 5/16 ^{+1/32}/₀ [7,9 ^{+0,8}/₀]
- MATERIAL:
 - A. STAMPING: .032" [0,8] THK COPPER, TIN PLATED
 - B. HOUSING: VINYL, RED
- SEE www.panduit.com FOR PACKAGE QUANTITIES INDICATED BY PART NUMBER SUFFIX
- DIMENSIONS IN BRACKETS ARE METRIC EQUIVALENT



LISTED
587H
E52164



CERTIFIED
LR31212

TITLE #22-18 BARREL FUNNELED VINYL INSULATED RING TONGUE, .150 [3,81] MAX WIRE INSUL DIA.				
CUSTOMER DRAWING				
ITEM REVISION NAME N41268BA/11		PANDUIT TM		
DATASET FILE NAME N41268BA_DC/11A				
UNLESS OTHERWISE SPECIFIED, DIMENSIONAL TOLERANCES ARE: IN [mm]			MATERIAL: SEE NOTES	
.x ± .1 [2,54] .xxx ± .005 [0,127] .xx ± .01 [0,25] ANGLES ± 5°			DRAWING NUMBER: N41268BA-DC	
THIRD ANGLE PROJECTION			DRAWING NUMBER: N41268BA-DC	
DRAWN BY DAW	DATE -	CHK CJH	SCALE N.T.S.	SHEET 1 OF 1

11	07.12.12	BDK	LCA	VMB	ADDED PMV1-3RB AND PMV1-5RB. ADDED METRIC EQUIVALENT. CHANGE PACKAGING NOTE. REVISED INSTALLATION TOOLS NOTE. BROUGHT DRAWING TO CURRENT STANDARDS.	N41268BA-DC
REV	DATE	BY	CHK	APR	DESCRIPTION	ECN

D10100DA/12