

PCB Layout

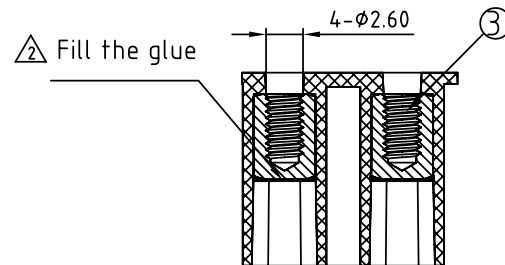
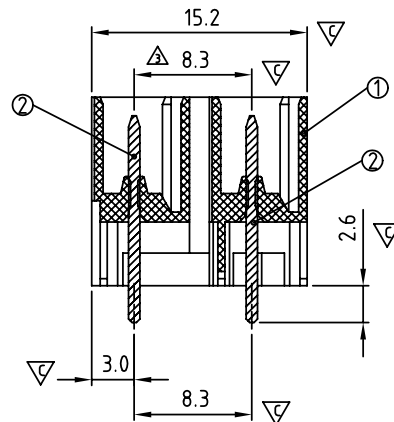
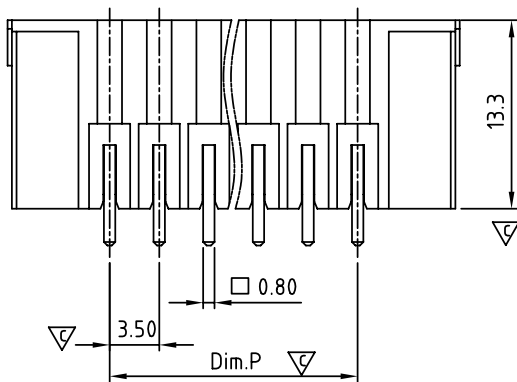

SECTION Q-Q

DIMENSION

Dim.L	$(N/2-1) \times 3.5 + 14.4$
Dim.P	$(N/2-1) \times 3.5$
Dim.A	$(N/2-1) \times 3.5$

N = Number of poles

	TOL		
	2×2P-2×5P	2×6P-2×16P	2×17P-2×24P
Dim.L	±0.20	±0.30	±0.40
Dim.P	±0.15	±0.25	±0.30
Dim.A	±0.15	±0.25	±0.30

SIGN	DATE	DESCRIPTION	APPROVER
△	9/17'10	How to order is changed	Runner
△	04/16'12	Flange nut is changed	Runner
△	04/16'12	The dimension is added	Runner

THIS IS CAD DRAWING, DO NOT REVISE MANUALLY!!!

Material:

- Item ① Terminal(housing): PA66 30% GF (UL94V-0)
- Item ② Contact pin of short: Copper Tin plated
- Item ③ Flange screw NUT: Brass M 2.5

Electrical:

- Voltage rating: 160V
- Current rating: 5.5A
- Withstanding Voltage: 1.32 KV
- Operating temperature: -40°C to +115°C
- Soldering temperature: 250°C ±10°C/5 Sec

- APPROVAL:
- Critical dimension:

KE xx 1 2 x 0 xxxx G

- No. OF POLES
- 04: 2×2 POLES
 - 06: 2×3 POLES
 - ...
 - 48: 2×24 POLES

COLOR

- 0 Black (RAL9005)
- 2 Red (RAL3001/D)
- 3 Orange(RAL2011/P)
- 4 Yellow(RAL1018/A)
- 5 Green(RAL6018/T)
- 6 Blue (RAL5015/A)
- 8 Grey(RAL7035/D)

RoHS compliant
(lead<4%)
In copper Alloy

A00 0: "@" Mark
A00 A: "ANYTEK" Mark
Any special item by customer request.
please contact sales department.

ANYTEK

CUSTOMER COPY

ALL RIGHTS RESERVED. REPRODUCTION OR ISSUE TO THIRD PARTIES IN ANY FORM WHATSOEVER IS NOT PERMITTED WITHOUT WRITTEN AUTHORITY FROM THE PROPRIETOR. PROPERTY OF ANYTEK TECHNOLOGY CO., LTD

TITLE		KE 3.5mm With Flange Series (Vertical) DIP type			
PART NO.		KExx12x0xxxxG		DWG NO. 8KE0012	
APPROVED	CHECKED	DESIGNED	DRAWN	CUST NO.	
		Runner 2012.04.16	Runner 2010.04.12		
				Tolerance	
				UNIT: mm	
				SCALE: NONE	
				X. ±0.50	
				X.X ±0.30	
				X.XX ±0.10	
				X° ±1°	
				SHEET: 01/01	
				REV.: D	