

LOOSE PIECE		SPECIFICATIONS				
MATERIAL NUMBER	ENGINEERING NUMBER	STUD SIZE	"S" ±.005 [0.13]	"W" ±.010 [0.25]	"C" MIN.	"L" MAX.
191340008	A-335-06	6	.146 [3.71]	.316 [8.02]	.303 [7.70]	.778 [19.76]
191340009	A-335-08	8	.173 [4.39]			
191340010	A-335-10	10	.198 [5.03]			

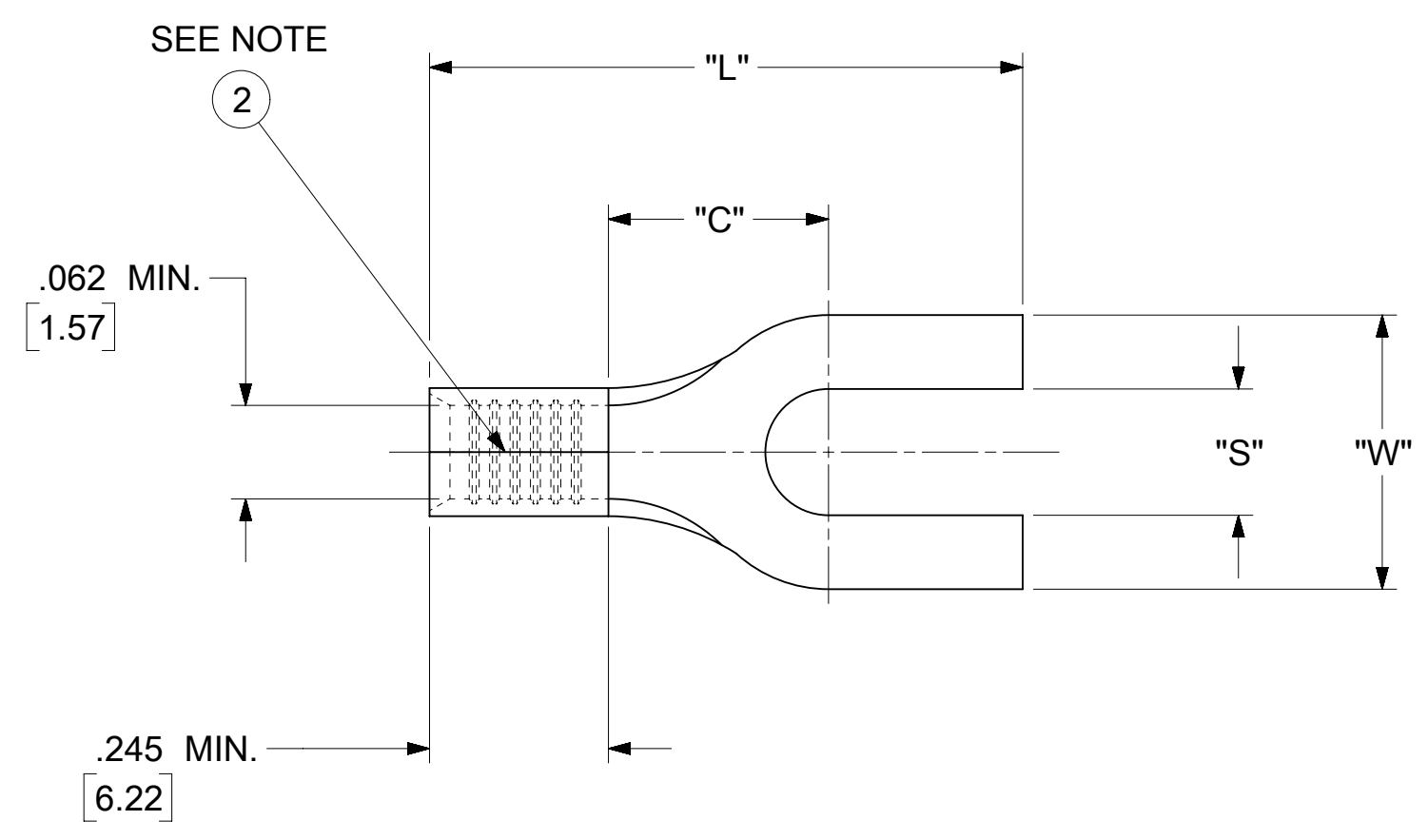

- NOTES:
- MATERIAL:  
 TERMINAL: COPPER (STOCK TKN .028 <sup>+0.001</sup>/<sub>-0.000</sub> [0.71])  
 PLATING: ELECTRO-TIN (.0003 MIN).
  - BRAZED SEAM
  - WIRE SIZE: 22-18 AWG  
 .25-1.5 MM<sup>2</sup>
  - "UL" LISTING #E32244  
 "CSA" LISTING #18689
  - ALL DIMENSIONS IN INCHES/[MM].
  - PARTS ARE ROHS COMPLIANT.
  - DIMS. SHOWN ARE FOR REFERENCE ONLY.

SYMBOLS	THIS DRAWING CONTAINS INFORMATION THAT IS PROPRIETARY TO MOLEX ELECTRONIC TECHNOLOGIES, LLC AND SHOULD NOT BE USED WITHOUT WRITTEN PERMISSION				
	DIMENSION UNITS	SCALE		CURRENT REV DESC:	
▽ = 0	INCH/MM	NTS		EC NO: 625846 DRWN: ABENJAMINLW 2019/09/04 CHK'D: GROJAS01 2019/10/17 APPR: JMACNEIL 2019/10/18	
▽ = 0	GENERAL TOLERANCES (UNLESS SPECIFIED)				
▽ = 0		MM	INCH		
▽ = 0	4 PLACES	±	---	±	---
▽ = 0	3 PLACES	±	---	±	.005
▽ = 0	2 PLACES	±	0.13	±	.01
▽ = 0	1 PLACE	±	0.25	±	---
▽ = 0	0 PLACES	±	---	±	---
▽ = 0	ANGULAR TOL	±	0.5 °		
□ = 0	DRAFT WHERE APPLICABLE MUST REMAIN WITHIN DIMENSIONS		THIRD ANGLE PROJECTION		DRAWING
▽ = 0			C-SIZE		SERIES
				19134	MATERIAL NUMBER
				SEE TABLE	CUSTOMER
				GENERAL MARKET	SHEET NUMBER
				1 OF 1	

**molex**

SPADE TONGUE TERMINAL  
VERSAKRIMP 300-SERIES

PRODUCT CUSTOMER DRAWING

DOCUMENT NUMBER: ACD30302 | DOC TYPE: PSD | DOC PART: 001 | REVISION: A

MATERIAL NUMBER: SEE TABLE | CUSTOMER: GENERAL MARKET | SHEET NUMBER: 1 OF 1