

LOOSE PIECE		TAPE MOUNTED		SPECIFICATIONS		
MATERIAL NUMBER	ENGINEERING NUMBER	MATERIAL NUMBER	ENGINEERING NUMBER	STUD SIZE	"S" ±.005 [0.13]	"H" REF
190670043	E-957-08	---	---	8	.173 [4.39]	1.172 [29.77]
190670045	E-957-10	190670046	E-957-10T	10	.198 [5.03]	
190670047	E-957-14	190670048	E-957-14T	1/4	.265 [6.73]	
190670052	E-957-38	190670053	E-957-38T	3/8	.390 [9.91]	
190670055	E-957-56	190670056	E-957-56T	5/16	.328 [8.33]	
190670059	E-957-76	---	---	7/16	.453 [11.51]	

B1

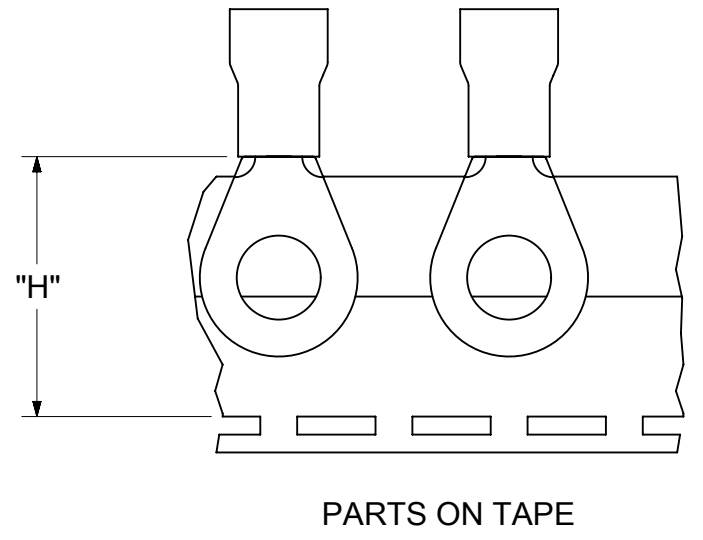
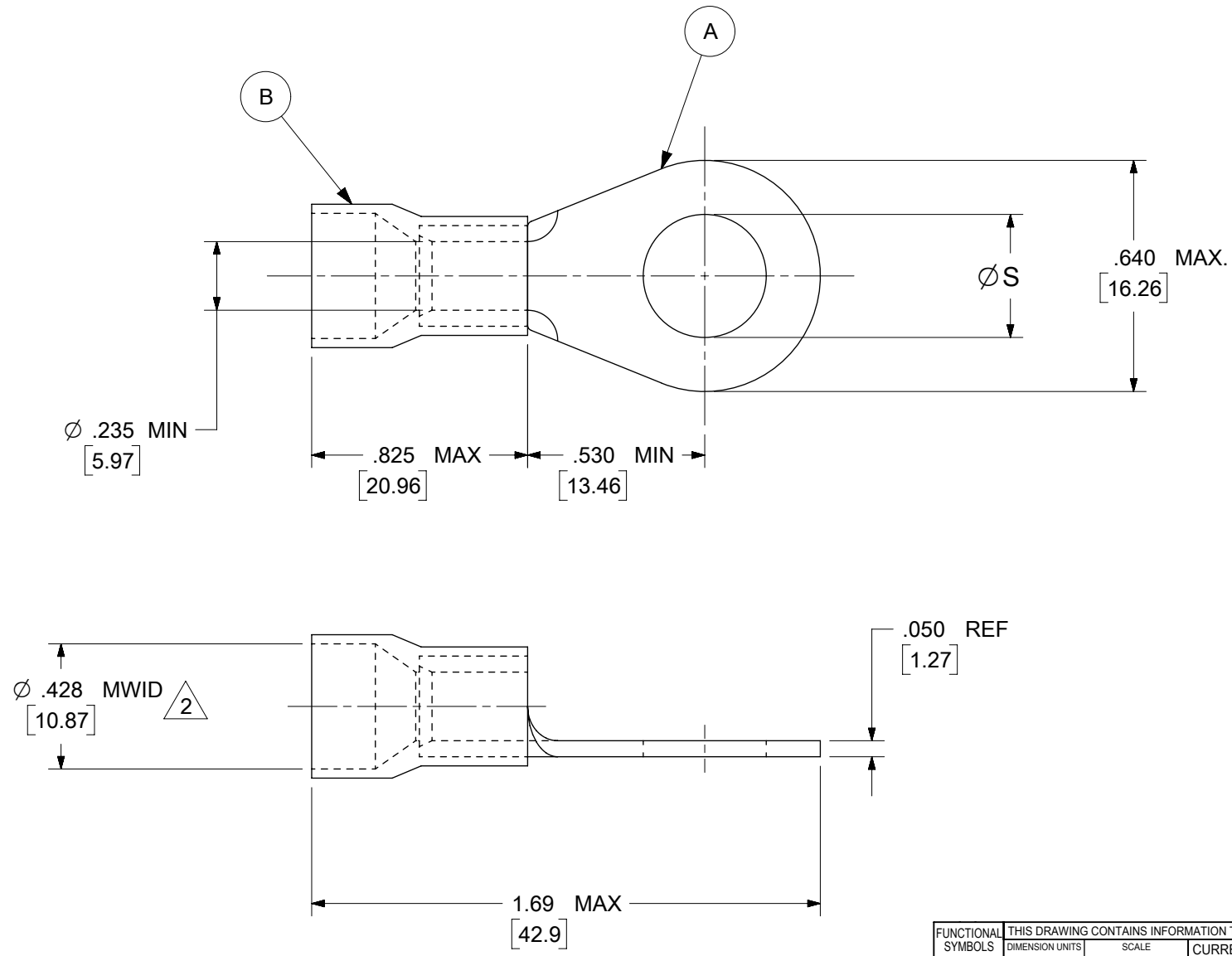

- NOTES:
- MATERIAL:
    - (A). TERMINAL: COPPER ALLOY
    - PLATING: ELECTRO-TIN (.0003 MIN.)
    - (B). INSULATION: NYLON, COLOR CODED BLUE
  - MWID: MAXIMUM WIRE INSULATION DIAMETER
  - WIRE SIZE: 6 AWG  
16 MM<sup>2</sup>
  - ALL COMPONENTS ARE RoHS COMPLIANT.
  - DIMS. SHOWN ARE FOR REFERENCE ONLY.

THIS DRAWING CONTAINS INFORMATION THAT IS PROPRIETARY TO MOLEX ELECTRONIC TECHNOLOGIES, LLC AND SHOULD NOT BE USED WITHOUT WRITTEN PERMISSION										
FUNCTIONAL SYMBOLS	DIMENSION UNITS	SCALE	CURRENT REV DESC: MIGRATED TO ECTR/NX AND ADDED TAPED P/NS TO TABLE							
$\nabla_A = 0$	INCH/MM	NTS	EC NO: 639324 DRWN: ABENJAMINLW 2020/06/05 CHK'D: DMYRICK 2020/06/10 APPR: JMACNEIL 2020/06/11 INITIAL REVISION: DRWN: EHILE 2006/10/20 APPR: JMACNEIL 2006/10/20							
$\nabla_E = 0$	GENERAL TOLERANCES (UNLESS SPECIFIED)									
$\nabla_P = 0$	MM	INCH								
DIVISIONAL SYMBOLS	4 PLACES ± --- ± ---	3 PLACES ± --- ± ---								
	1 PLACE ± --- ± ---	0 PLACES ± --- ± ---	PRODUCT CUSTOMER DRAWING DOCUMENT NUMBER: SD-19067-013 DOC TYPE: PSD DOC PART: 001 REVISION: B1							
	ANGULAR TOL ± ---		DRAFT WHERE APPLICABLE MUST REMAIN WITHIN DIMENSIONS		THIRD ANGLE PROJECTION	DRAWING	SERIES	MATERIAL NUMBER	CUSTOMER	SHEET NUMBER
						B-SIZE	19067	SEE CHART	GENERAL MARKET	1 OF 1