

| REV. | DESCRIPTION | DATE       |
|------|-------------|------------|
| A    | New Drawing | 2022/03/01 |

Compliance with:  
 PCIe4.0(16GTS),  
 USB4 Gen3(40Gbps),  
 USB3.2 Gen2(10Gbps).  
 Mating with:  
 "BBBD-XXXG1063BCLI-C"

Specifications:  
 Current Rating: 0.3A AC,DC  
 Voltage Rating: 30V AC,DC  
 Contact Resisittance: 80m ohm.Max  
 Insulation Resisittance: 1000M ohm.Min  
 Withstanding Voltage: 150V AC/Minute  
 Operating Temperature Range:-55°C~+85°C

Material:  
 Insulator: Temp Plastic(UL94V-0)  
 Insulator Color: Black  
 Contact: Copper Alloy  
 Plated: Gold Plated

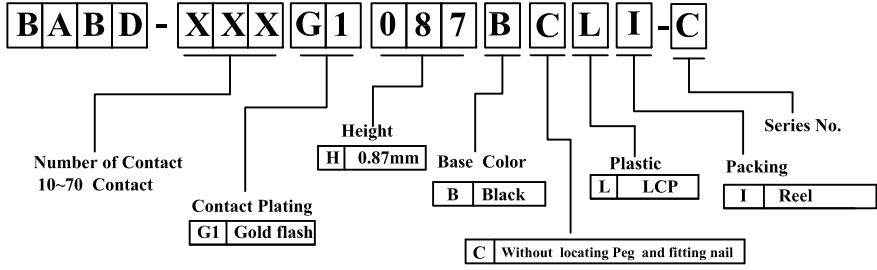
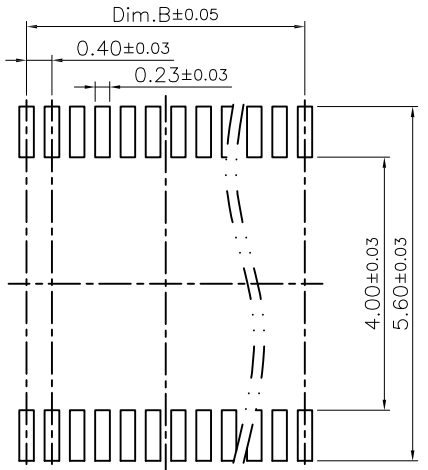
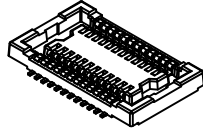
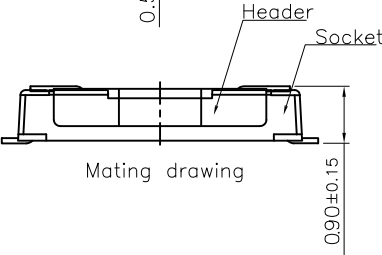
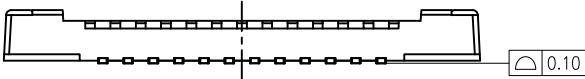
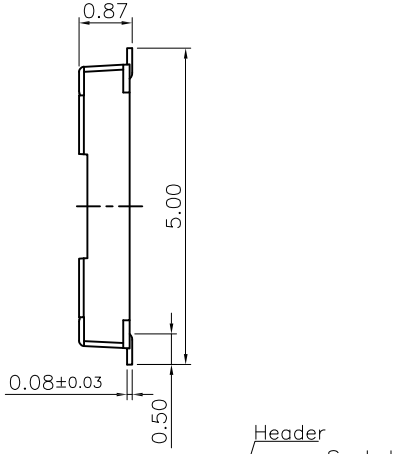
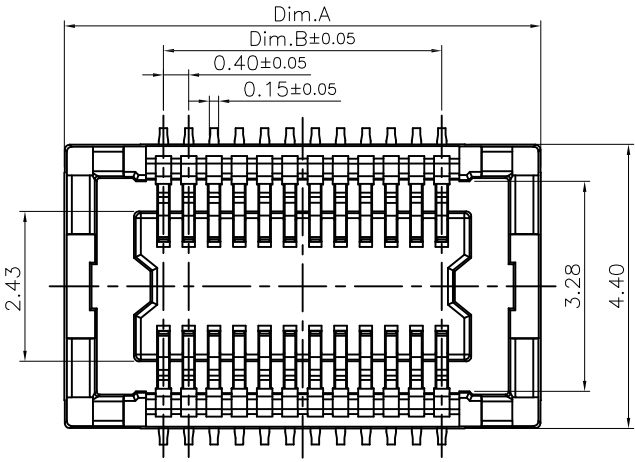

| Circuits | Dim.A | Dim.B | Circuits | Dim.A | Dim.B |
|----------|-------|-------|----------|-------|-------|
| 10       | 4.70  | 1.60  | 40       | 10.70 | 7.60  |
| 20       | 6.70  | 3.60  | 50       | 12.70 | 9.60  |
| 24       | 7.50  | 4.40  | 60       | 14.70 | 11.60 |
| 30       | 8.70  | 5.60  | 70       | 16.70 | 13.60 |

RoHS compliant

**Superior Tech Co., Ltd.**

|                          |  |                 |  |                                    |  |
|--------------------------|--|-----------------|--|------------------------------------|--|
| <b>General Tolerance</b> |  | <b>TITLE</b>    |  | <b>PH 0.4mm Female BTB MH0.9mm</b> |  |
| X. ± 0.5                 |  | <b>DRAWN</b>    |  | <b>DATE</b>                        |  |
| .X ± 0.3                 |  | Tom             |  | 03-01-22'                          |  |
| .XX ± 0.2                |  | <b>CHECK</b>    |  | <b>NO.</b>                         |  |
| .XXX ± 0.1               |  | <b>APPROVED</b> |  | T230                               |  |
| Angle ± 5°               |  |                 |  | <b>PART NO.</b>                    |  |
|                          |  |                 |  | BABD-XXXG1087BCLI-C                |  |
|                          |  |                 |  | <b>CUSTOMER NO.</b>                |  |
|                          |  |                 |  | DK                                 |  |

|             |             |              |  |
|-------------|-------------|--------------|--|
| <b>REV.</b> | <b>UNIT</b> | <b>SCALE</b> |  |
| A           | mm          | 1:1          |  |

(Q2-R03-01A) ST-R05-07

| REV. | DESCRIPTION | DATE       |
|------|-------------|------------|
| A    | New Drawing | 2022/03/24 |

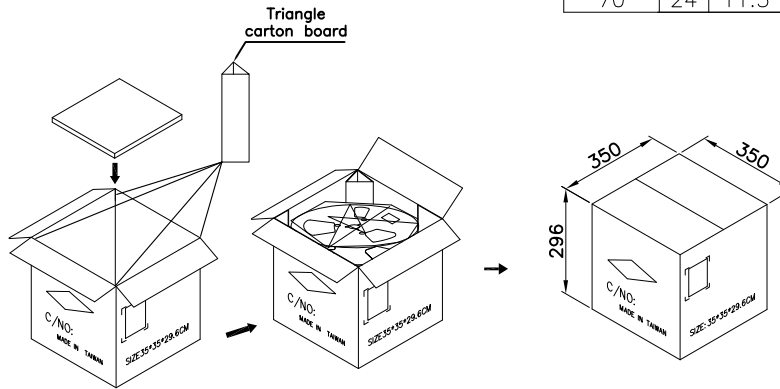
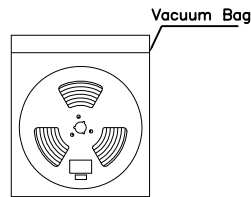
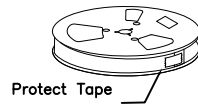
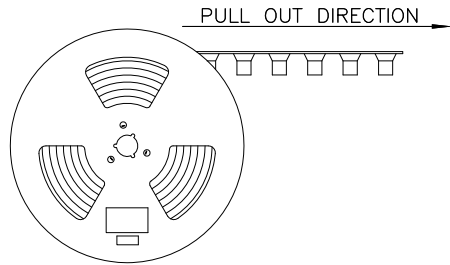
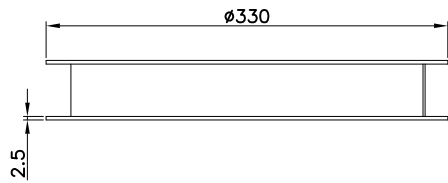

Note:

- 1.All dimensions meet EIA-481-D requirements.
- 2.Material: Transparent Conductive Polystyrene Alloy 100% recyclable.
- 3.Thickness :  $0.4 \pm 0.05\text{mm}$
- 4.Component load per 13" reel reel :5000 pcs.
- 5.Carton Size:  
Carton Size:350\*350\*296(MM)

| Pin No. | W  | F    | PCS/R | R/CTN | Q'TY   |
|---------|----|------|-------|-------|--------|
| 10      | 16 | 7.5  | 5000  | 12    | 60,000 |
| 20      | 16 | 7.5  | 5000  | 12    | 60,000 |
| 24      | 16 | 7.5  | 5000  | 12    | 60,000 |
| 30      | 16 | 7.5  | 5000  | 12    | 60,000 |
| 40      | 24 | 11.5 | 5000  | 9     | 45,000 |
| 50      | 24 | 11.5 | 5000  | 9     | 45,000 |
| 60      | 24 | 11.5 | 5000  | 9     | 45,000 |
| 70      | 24 | 11.5 | 5000  | 9     | 45,000 |

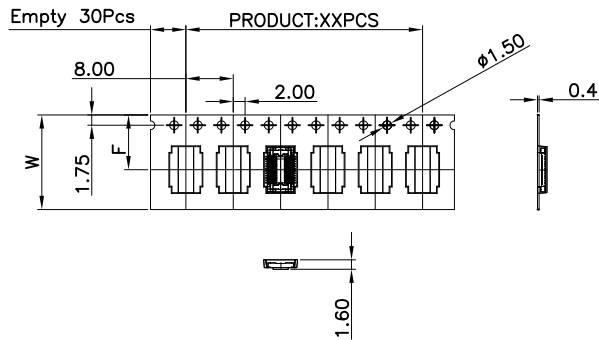

For Reel width (dimension W) 16/24mm.

RoHS compliant

**Superior Tech Co., Ltd.**

| General Tolerance |               | TITLE           | BABD-XXXG1087BCLI-C_Packing |                     |
|-------------------|---------------|-----------------|-----------------------------|---------------------|
| X.                | $\pm 0.5$     | DRAWN<br>Jacky  | DATE                        | NO.                 |
| .X                | $\pm 0.3$     |                 | 03-24-22'                   | T230                |
| .XX               | $\pm 0.2$     | CHECK<br>Tom    | DATE                        | PART NO.            |
| .XXX              | $\pm 0.1$     |                 | 03-24-22'                   | BABD-XXXG1087BCLI-C |
| Angle             | $\pm 5^\circ$ | APPROVED<br>Tom | DATE                        | CUSTOMER NO.        |
|                   |               |                 | 03-24-22'                   | DK                  |

| REV. | UNIT | SCALE |
|------|------|-------|
| A    | mm   | 1:5   |

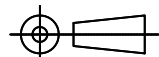

(Q2-R03-01A) ST-R05-07