

NOTES:

1. REFER TO THE BOM FOR MATERIAL INFORMATION;
2. THE EXTERNAL ADHESIVE (P/N:2178530018) MOLEX IS NOT PASTED ON THE PRODUCT, AND THE CUSTOMER CHOOSES TO PASTE IT ON THE A/B FACE OF THE PRODUCT.
3. ANTENNA B FACES THE SKY, PLEASE REFER TO THE DIRECTION OF THE ARROW ON THE SIDE OF THE PRODUCT.

REV	DATE	DESCRIPTION
A1	2022/10/28	FIRST RELEASE

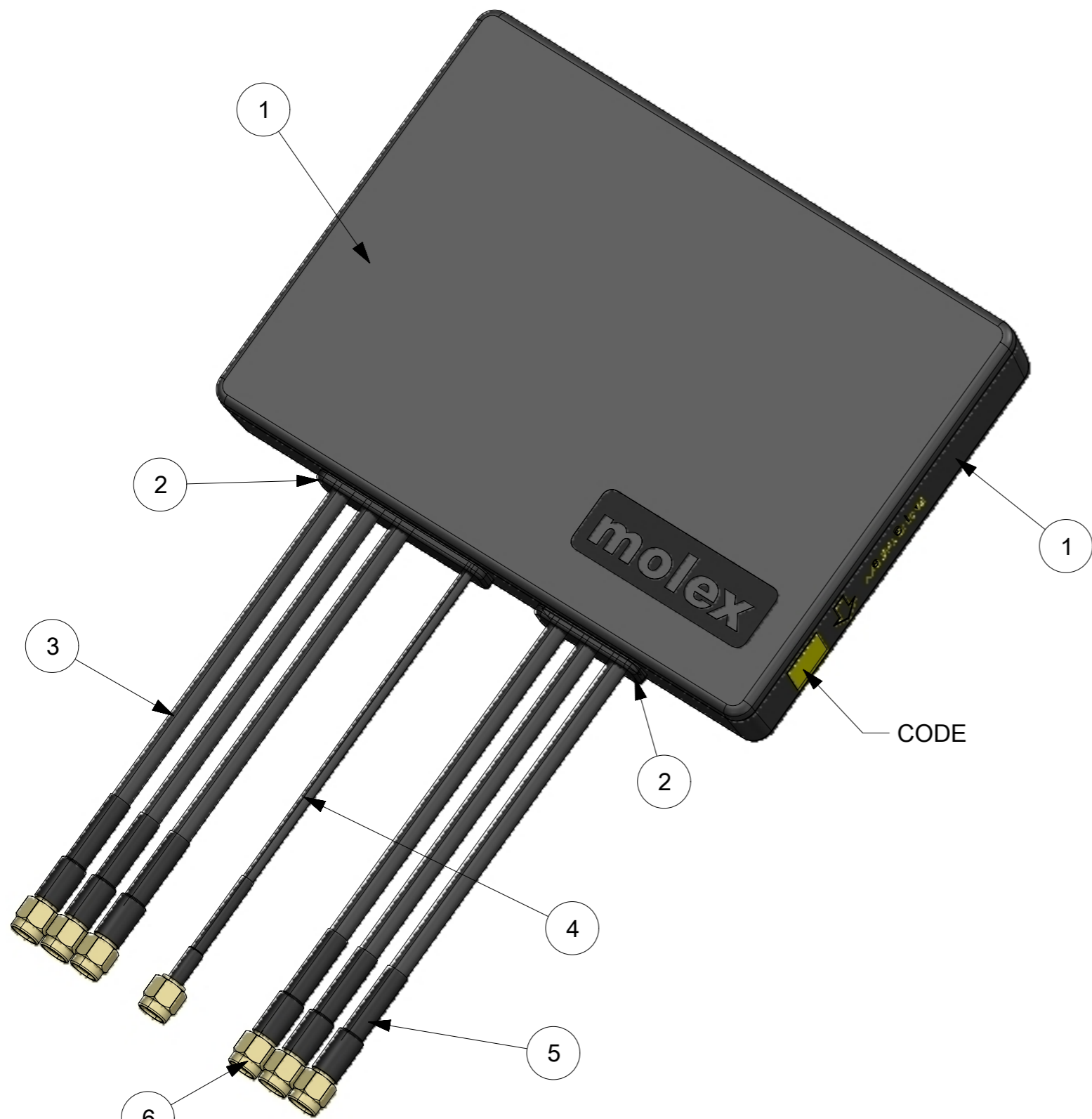

3D VIEW

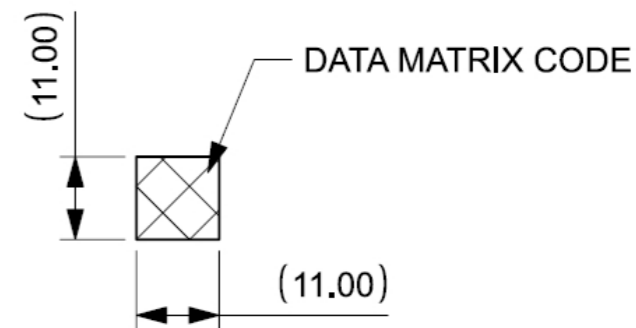

DATA MATRIX CODE

SIZE:11X11mm

CODING:7IN1 ANTENNA#2178531000#XXXXXXXXXX#XXXX

PROJECT NAME MOLEX P/N YEAR MONTH DATE ROLLING NO.

FOR EXAMPLE:7 IN 1 ANTENNA#2178531000#20210906#0005
 MEANS PROJECT:7IN1 ANTENNA, PRODUCT:2178531000
 THE FIFTH PRODUCT ON SEP6, 2021

BOM TABLE-A			
LTEM	PART NAME	QTY	REMARK
1	HOUSING	2 PCS	PC&ABS BLACK
2	SEALING RING	2 PCS	SILICONE BLACK
3	CABLE-1	6 PCS	Ø5MM BLACK JACK
4	CABLE-2	1 PCS	Ø2.8MM BLACK JACK
5	HEAT SHRINK TUBE	7 PCS	BLACK IN COLOR
6	CONNECTOR	7 PCS	SMA STRAIGHT CABLE PLUGS (MALE) GOLD PLATING

FUNCTIONAL SYMBOLS	THIS DRAWING CONTAINS INFORMATION THAT IS PROPRIETARY TO MOLEX ELECTRONIC TECHNOLOGIES, LLC AND SHOULD NOT BE USED WITHOUT WRITTEN PERMISSION		CURRENT REV DESC:		molex					
	▽A = 0	mm	1:1	EC NO: 726265						
▽E = 0	GENERAL TOLERANCES (UNLESS SPECIFIED)		DRWN: KCHENG06	2022/10/28	MOLEX MULTI-HUB ANTENNA 7-IN-1					
▽F = 0	ANGULAR TOL ± °		CHK'D: HORACM1	2022/10/28						
DIVISIONAL SYMBOLS	4 PLACES	±	APPR: HORACM1	2022/10/28	PRODUCT CUSTOMER DRAWING					
	3 PLACES	± 1.5	INITIAL REVISION:	DOCUMENT NUMBER						
	2 PLACES	± 2.0	DRWN: KCHENG06	2022/03/15	2178531000					
	1 PLACE	± 3.0	APPR: HORACM1	2022/10/14	PSD 000 A1					
0 PLACES	±	DRAFT WHERE APPLICABLE MUST REMAIN WITHIN DIMENSIONS	THIRD ANGLE PROJECTION	DRAWING	SERIES	MATERIAL NUMBER	CUSTOMER	DOC TYPE	DOC PART	REVISION
			⊗	A3-SIZE	217853	2178531000	GENERAL MARKET			1 OF 3

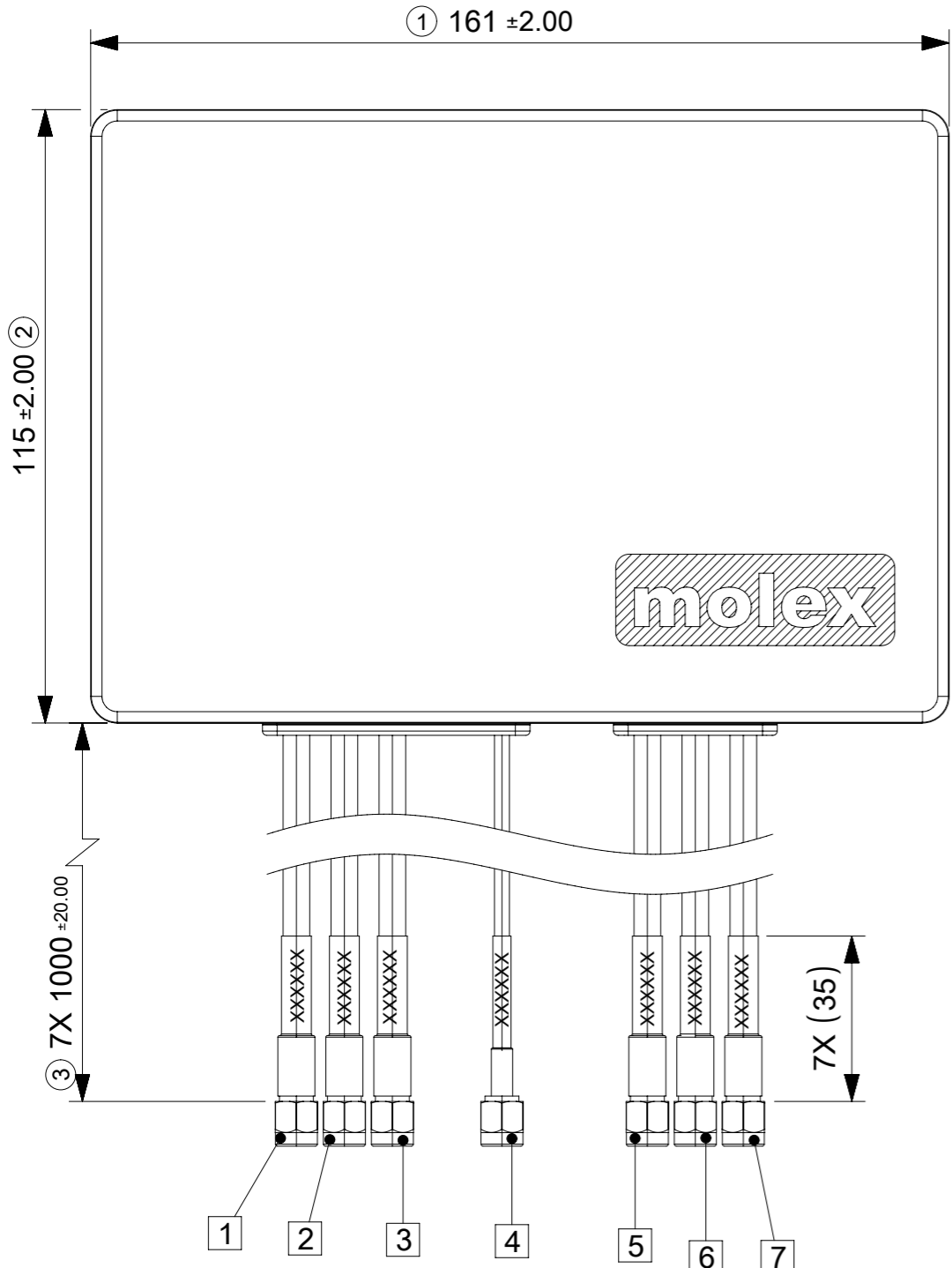

TOP VIEW

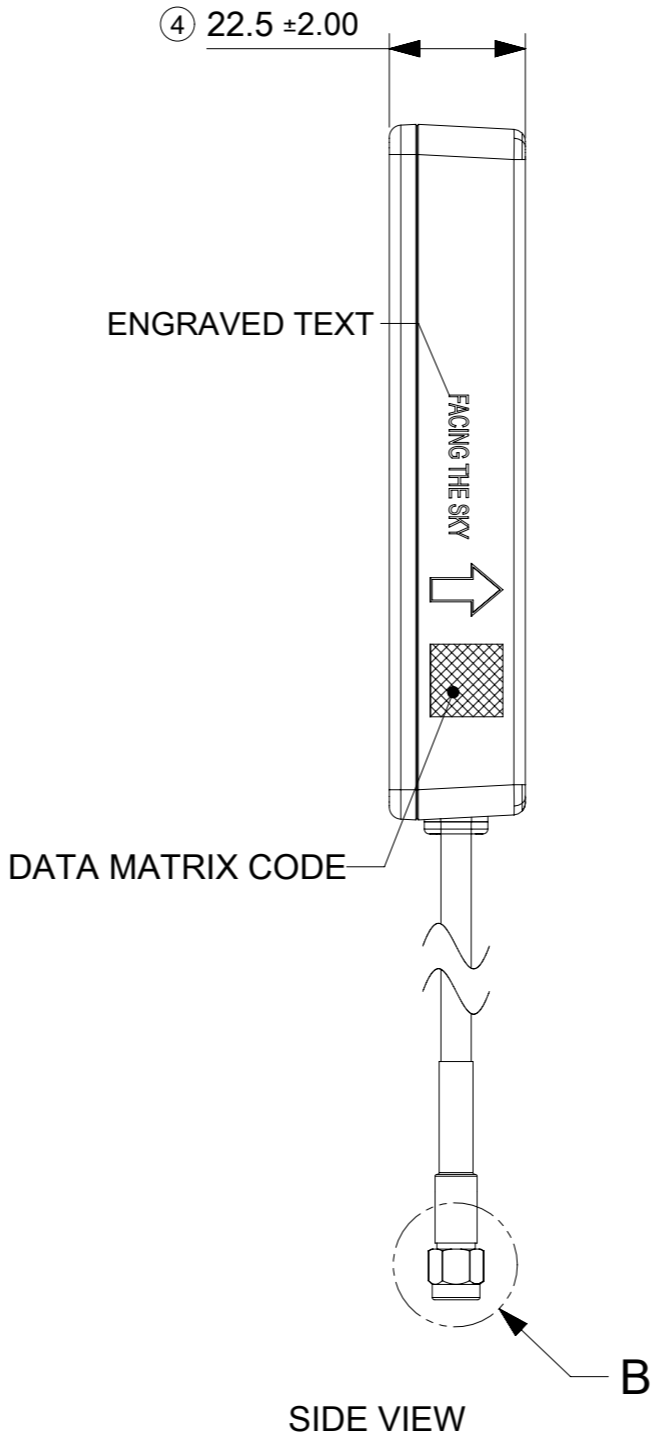

SIDE VIEW

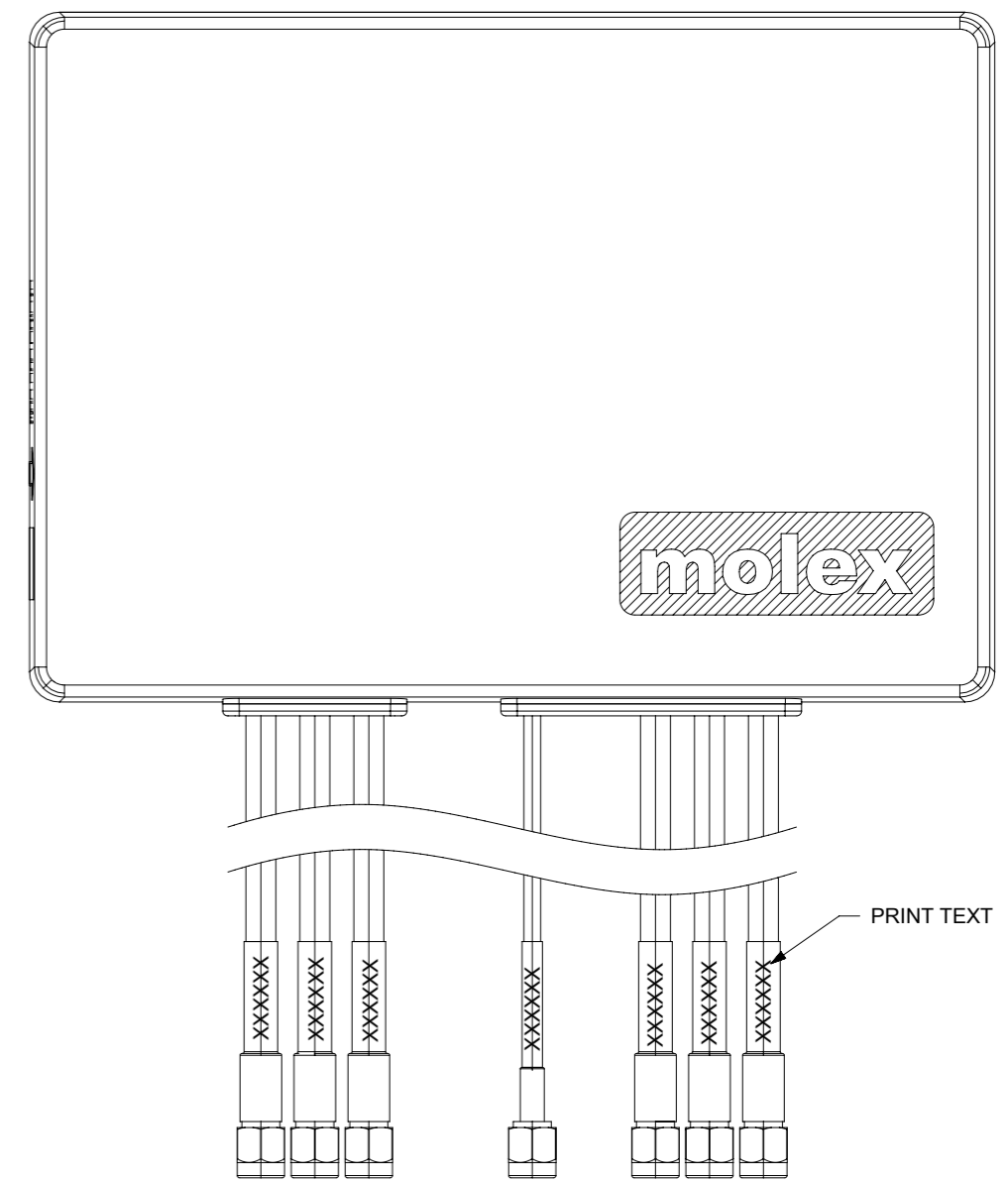

BOTTOM VIEW

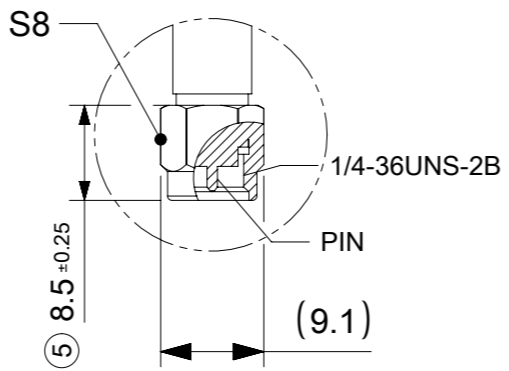

DETAIL B
SCALE 3:2

CABLE INFORMATION		
LTEM	REMARK	PRINT TEXT
1	Ø5±0.15	5G High Band-2
2		WIFI-2
3		LTE/5G Full Band-2
4	Ø2.8±0.15	GNSS
5	Ø5±0.15	WIFI-1
6		LTE/5G Full Band-1
7		5G High Band-1

FUNCTIONAL SYMBOLS $\nabla_A = 0$ $\nabla_E = 0$ $\nabla_F = 0$	DIMENSION UNITS mm	SCALE 1:1	THIS DRAWING CONTAINS INFORMATION THAT IS PROPRIETARY TO MOLEX ELECTRONIC TECHNOLOGIES, LLC AND SHOULD NOT BE USED WITHOUT WRITTEN PERMISSION		
	GENERAL TOLERANCES (UNLESS SPECIFIED)		CURRENT REV DESC:		
	ANGULAR TOL ± °		molex		
	4 PLACES ±		MOLEX MULTI-HUB ANTENNA 7-IN-1		
DIVISIONAL SYMBOLS 3 PLACES ± 1.5 2 PLACES ± 2.0 1 PLACE ± 3.0 0 PLACES ±	EC NO: 726265 DRWN: KCHENG06 APPR: HORACM1		2022/10/28 2022/10/28 2022/10/28		
	INITIAL REVISION: DRWN: KCHENG06 APPR: HORACM1		PRODUCT CUSTOMER DRAWING		
	DRAFT WHERE APPLICABLE MUST REMAIN WITHIN DIMENSIONS		DOCUMENT NUMBER 2178531000		
	THIRD ANGLE PROJECTION		DOC TYPE DOC PART REVISION PSD 000 A1		
A3-SIZE		SERIES 217853		MATERIAL NUMBER 2178531000	
CUSTOMER GENERAL MARKET		SHEET NUMBER 2 OF 3			

EXTERNAL ADHESIVE(P/N:2178530018):

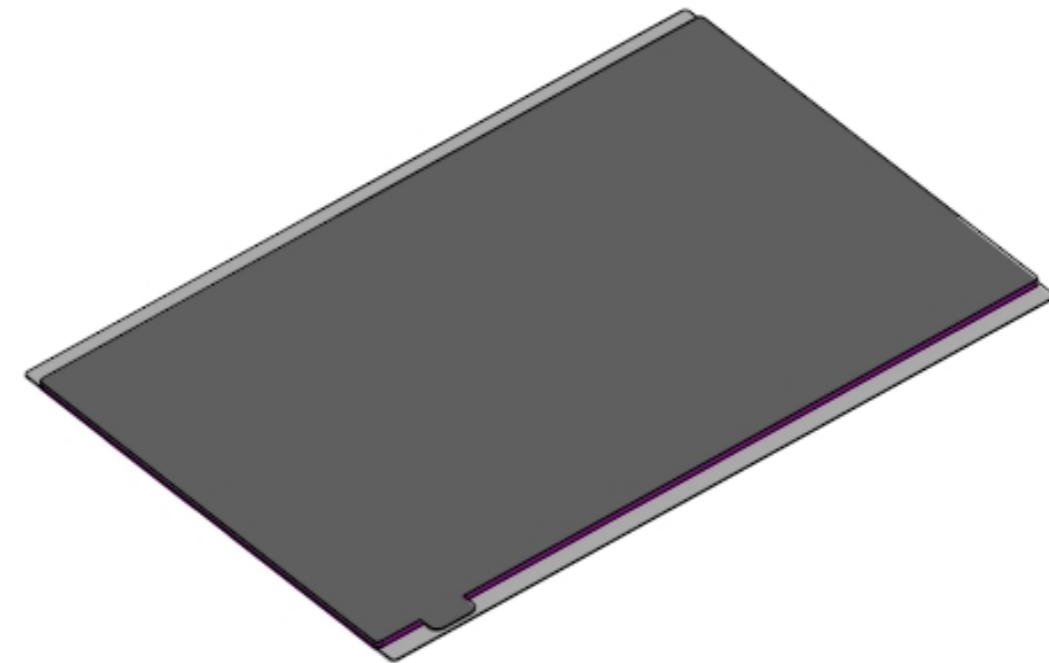
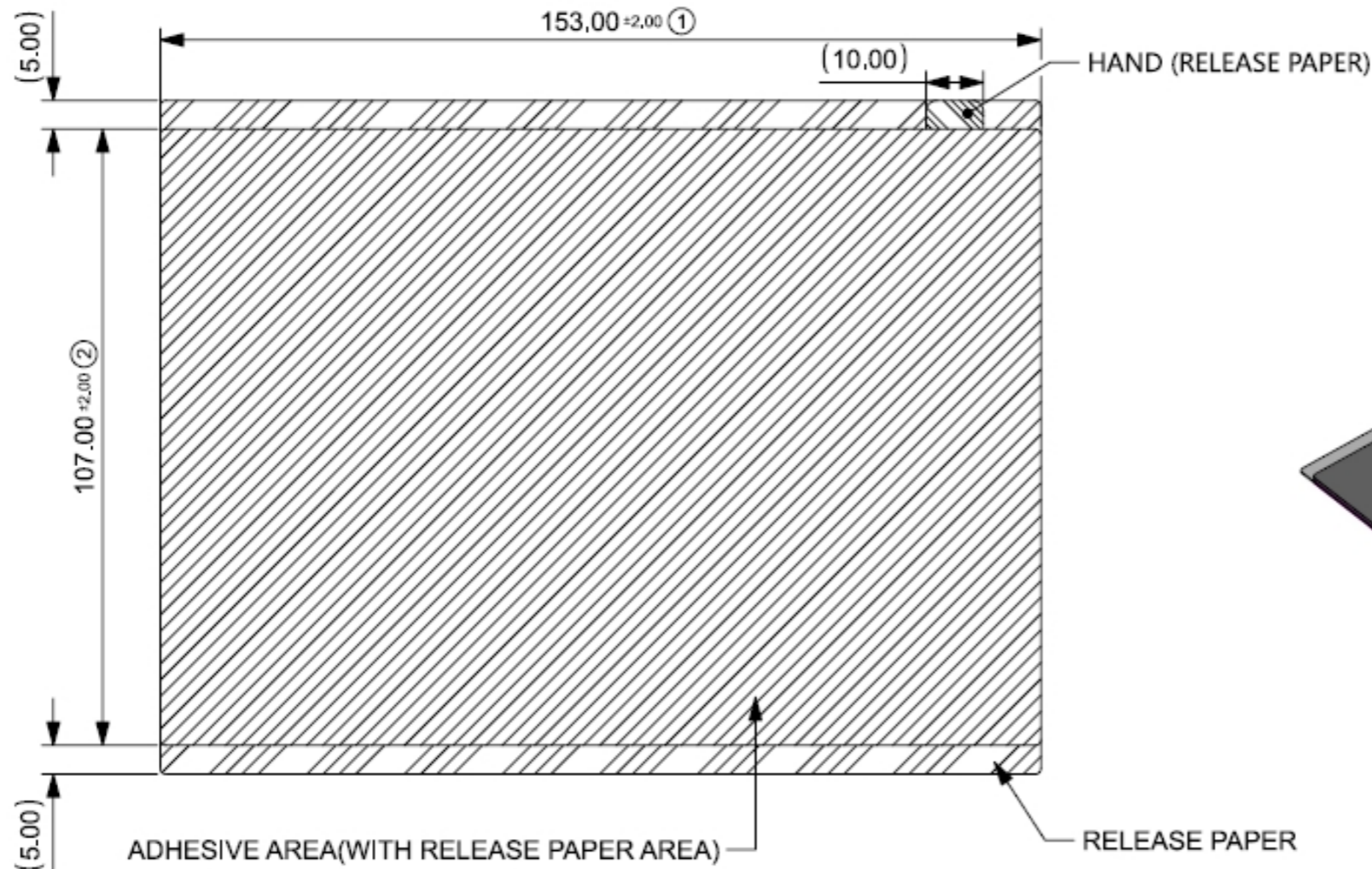

3D VIEW

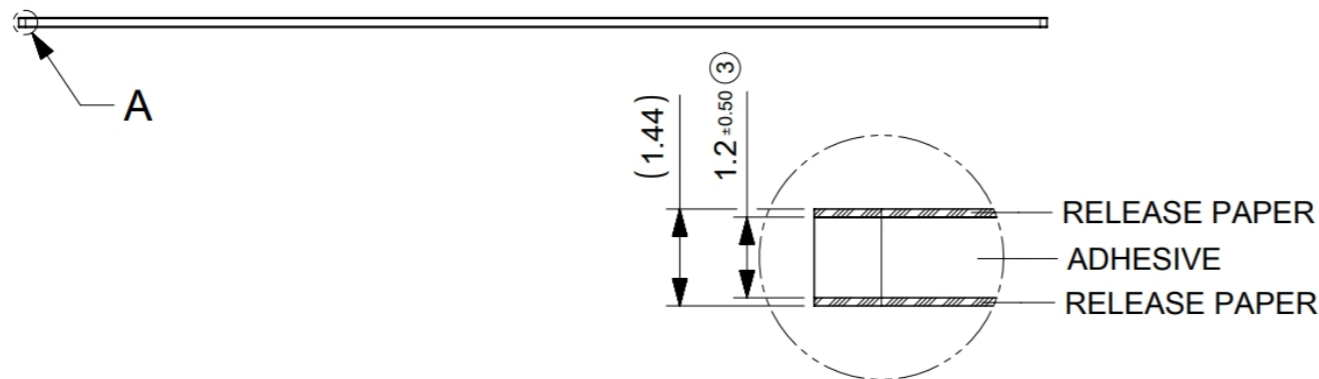

DETAIL A
SCALE 10:1

- NOTES:
1. MATERIAL THICKNESS 1.2MM, COLOR: BLACK.

FUNCTIONAL SYMBOLS	THIS DRAWING CONTAINS INFORMATION THAT IS PROPRIETARY TO MOLEX ELECTRONIC TECHNOLOGIES, LLC AND SHOULD NOT BE USED WITHOUT WRITTEN PERMISSION						
	$\nabla_A = 0$ $\nabla_E = 0$ $\nabla_V = 0$	DIMENSION UNITS: mm SCALE: 1:1				CURRENT REV DESC: EC NO: 726265 DRWN: KCHENG06 CHK'D: HORACM1 APPR: HORACM1	2022/10/28 2022/10/28 2022/10/28
DIVISIONAL SYMBOLS	GENERAL TOLERANCES (UNLESS SPECIFIED)		PRODUCT CUSTOMER DRAWING				
	ANGULAR TOL ± °		DOCUMENT NUMBER				
	4 PLACES ±		2178531000				
	3 PLACES ± 1.5		DOC TYPE DOC PART REVISION				
2 PLACES ± 2.0		PSD 000 A1					
1 PLACE ± 3.0		INITIAL REVISION:					
0 PLACES ±		DRWN: KCHENG06 2022/03/15					
DRAFT WHERE APPLICABLE MUST REMAIN WITHIN DIMENSIONS		THIRD ANGLE PROJECTION	DRAWING	SERIES	MATERIAL NUMBER	CUSTOMER	SHEET NUMBER
			A3-SIZE	217853		GENERAL MARKET	3 OF 3