

Features

- Ultra low leakage: nA level
- Operating voltage: 36V
- Low clamping voltage
- Complies with following standards:
 - IEC 61000-4-2 (ESD) immunity test
 - Air discharge: $\pm 20\text{kV}$
 - Contact discharge: $\pm 15\text{kV}$
 - IEC61000-4-4 (EFT) 40A (5/50ns)
 - IEC61000-4-5 (Lightning) 6A (8/20 μs)
- RoHS Compliant

Dimensions SOT-23

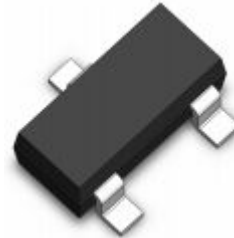

Applications

- Cellular Handsets and Accessories
- Notebooks and Handhelds
- Portable Instrumentation
- Set Top Box
- Industrial Controls
- Server and Desktop PC

Pin Configuration

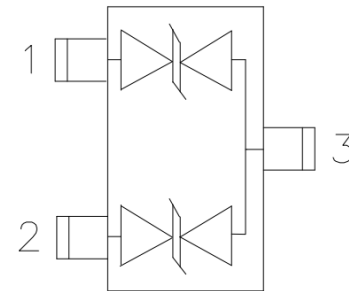

Mechanical Characteristics

- Package: SOT-23
- Lead Finish: Lead Free
- UL Flammability Classification Rating 94V-0
- Quantity Per Reel: 3,000pcs
- Reel Size: 7inch
- Device Marking: DB2

Absolute Maximum Ratings (T_{amb}=25°C unless otherwise specified)

| Parameter | Symbol | Value | Unit |
|--|------------------|-------------|------|
| Peak Pulse Power (8/20 μs) | P _{pp} | 360 | W |
| ESD per IEC 61000-4-2 (Air) | V _{ESD} | ± 20 | Kv |
| ESD per IEC 61000-4-2 (Contact) | | ± 15 | |
| Operating Temperature Range | T _J | -55 to +125 | °C |
| Storage Temperature Range | T _{STJ} | -55 to +150 | °C |

Electrical Characteristics (TA=25°C unless otherwise specified)

| Parameter | Symbol | Test Condition | Min | Typ | Max | Unit |
|-------------------------|-----------|--------------------------------------|-----|-----|-----|---------|
| Reverse Working Voltage | V_{RWM} | | | | 36 | V |
| Breakdown Voltage | V_{BR} | $I_T = 1mA$ | 40 | | | V |
| Reverse Leakage Current | I_R | $V_{RWM} = 36V$ | | | 1 | μA |
| Clamping Voltage | V_C | $I_{PP} = 6A$ (8 x 20 μs pulse) | | | 60 | V |
| Junction Capacitance | C_J | $V_R = 0V, f = 1MHz$ | | 15 | | pF |

Typical Performance Characteristics ($T_A=25^\circ\text{C}$ unless otherwise Specified)

Figure 1: Peak Pulse Power vs. Pulse Time

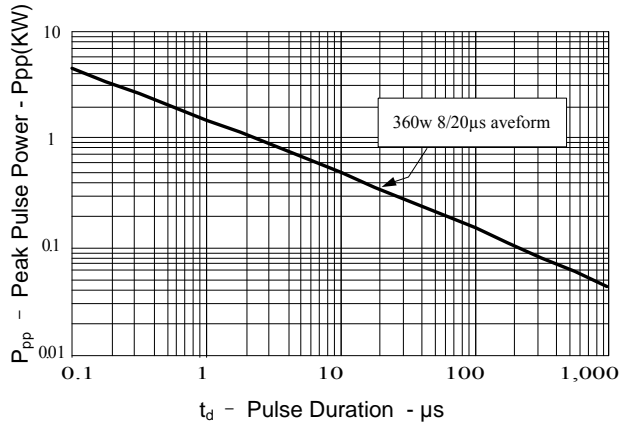

Figure 2: Power Derating Curve

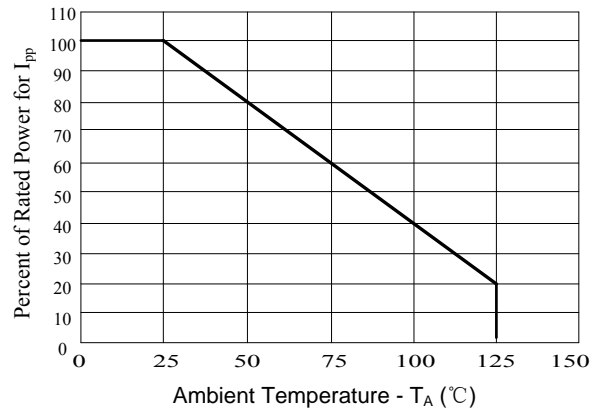

Figure3: Pulse Waveform

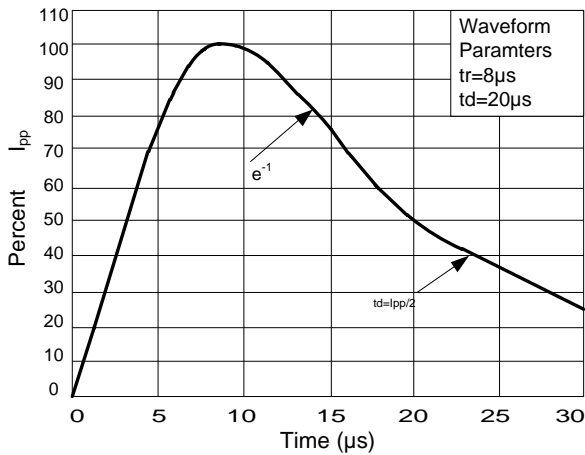
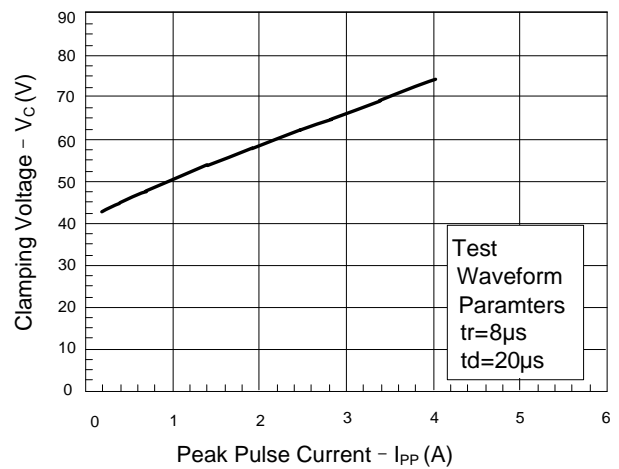
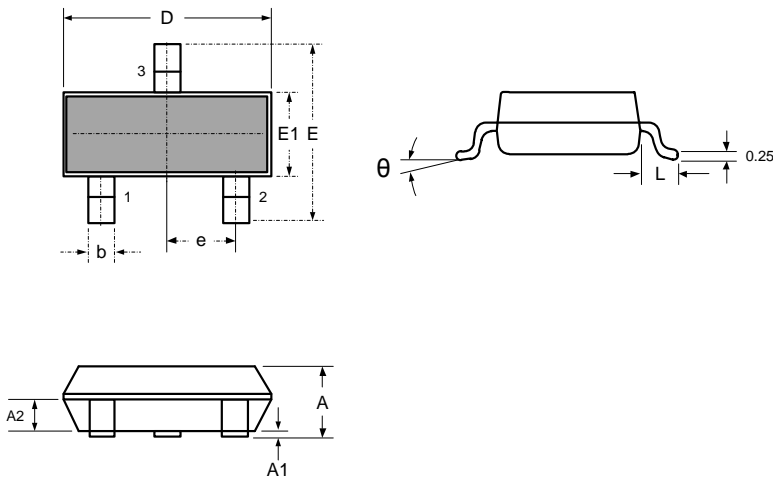

Figure 4: Clamping Voltage vs. Ipp



SOT-23 Package Outline & Dimensions



| SYMBOL | DIMENSIONS | | | |
|----------|------------|-------|-----------|-------|
| | MILLIMETER | | INCHES | |
| | MIN | MAX | MIN | MAX |
| A | 0.900 | 1.150 | 0.035 | 0.045 |
| A1 | 0.000 | 0.100 | 0.000 | 0.004 |
| A2 | 0.900 | 1.050 | 0.035 | 0.041 |
| D | 2.800 | 3.000 | 0.110 | 0.118 |
| b | 0.300 | 0.500 | 0.012 | 0.020 |
| E | 2.250 | 2.550 | 0.089 | 0.100 |
| E1 | 1.200 | 1.400 | 0.047 | 0.055 |
| e | 0.950 BSC | | 0.037 BSC | |
| L | 0.300 | 0.500 | 0.012 | 0.020 |
| θ | 0 | 8° | 0 | 8° |

NOTICE

Leiditech reserves the right to make modifications, enhancements, improvements, corrections or other changes without further notice to any product herein. Leiditech does not assume any liability arising out of the application or use of any product described herein.