

SURFACE MOUNT BATTERY CLIPS/CONTACTS

AVAILABLE ON TAPE AND REEL

- "Flow-Hole" SMT solder tail design for increased joint strength
- Tin-Nickel plating is ideal for lead free, high temperature soldering
- Matte Tin Plate for lower soldering temperatures ideal where other temperature sensitive components are being used



Refer to page 34 for Battery Contact Layout & Mounting Details

"AAAA" - "A27"

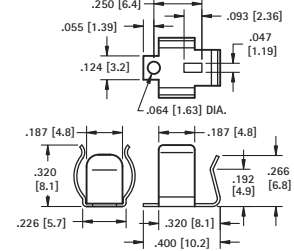

MATERIAL: .010 (.25) Spring Steel

TIN-NICKEL PLATE		MATTE TIN PLATE	
CAT. NO.	ON TAPE & REEL	CAT. NO.	ON TAPE & REEL
50	50TR	550	550TR

Tape & Reel Spec's: 24mm wide; 16mm pitch; 13 inch reel, (500 pieces per reel)

Pad Layout

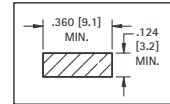

"AAA" - "N" - "A23"

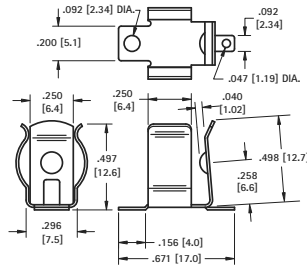

MATERIAL: .010 (.25) Spring Steel

TIN-NICKEL PLATE		MATTE TIN PLATE	
CAT. NO.	ON TAPE & REEL	CAT. NO.	ON TAPE & REEL
55	55TR	555	555TR

Tape & Reel Spec's: 32mm wide; 16mm pitch; 13 inch reel, (300 pieces per reel)

Pad Layout

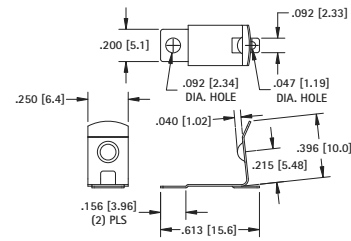
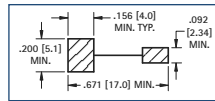

MATERIAL: .010 (.25) Spring Steel

TIN-NICKEL PLATE		MATTE TIN PLATE	
CAT. NO.	ON TAPE & REEL	CAT. NO.	ON TAPE & REEL
56	56TR	556	556TR

Tape & Reel Spec's: 32mm wide; 20mm pitch; 13 inch reel, (250 pieces per reel)

Pad Layout

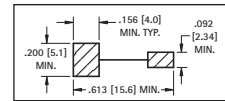

"AA" - "CR2" - "A"

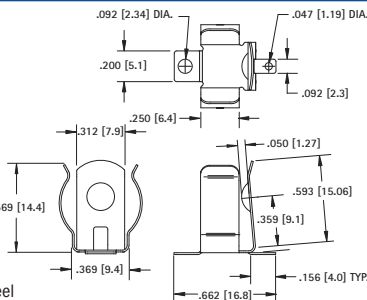

MATERIAL: .012 (.30) Spring Steel

TIN-NICKEL PLATE		MATTE TIN PLATE	
CAT. NO.	ON TAPE & REEL	CAT. NO.	ON TAPE & REEL
53	53TR	553	553TR

Tape & Reel Spec's: 32mm wide; 24mm pitch; 13 inch reel, (150 pieces per reel)

Pad Layout

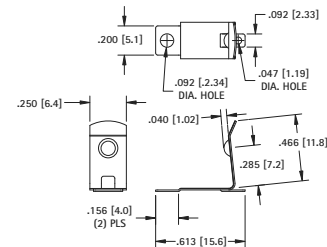
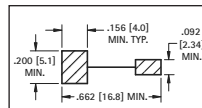

MATERIAL: .010 (.25) Spring Steel

TIN-NICKEL PLATE		MATTE TIN PLATE	
CAT. NO.	ON TAPE & REEL	CAT. NO.	ON TAPE & REEL
57	57TR	557	557TR

Tape & Reel Spec's: 32mm wide; 20mm pitch; 13 inch reel, (250 pieces per reel)

Pad Layout

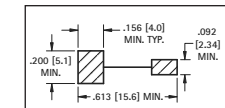

SURFACE MOUNT LEAF-SPRING CONTACTS

AVAILABLE ON TAPE AND REEL

- Economical & reliable contacts are ideal for surface mount applications
- Unique spring tension contacts adjust to variations in battery length
- Reliable spring tension contacts assure low contact resistance
- SMT solder tail with "flow-hole" design for increased joint strength

"AAA" - "AAAA" - "A23" - "N"

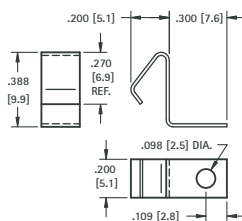

MATERIAL: .010 (.25) Spring Steel

TIN-NICKEL PLATE		MATTE TIN PLATE	
CAT. NO.	ON TAPE & REEL	CAT. NO.	ON TAPE & REEL
5230	5230TR	5330	5330TR

Tape and Reel Spec's: 24mm wide; 12mm pitch; 13 inch reel (400 pieces per reel)

"AA" - "CR2" - "A" - "9V"

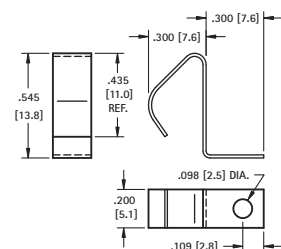

MATERIAL: .010 (.25) Spring Steel

TIN-NICKEL PLATE		MATTE TIN PLATE	
CAT. NO.	ON TAPE & REEL	CAT. NO.	ON TAPE & REEL
5231	5231TR	5331	5331TR

Tape and Reel Spec's: 32mm wide; 16mm pitch; 13 inch reel (250 pieces per reel)