

Meets IEEE 802.3at Standards.

Designed For 2.5G BASE-T Applications, Surface Mount Type.

Operating Temperature Range: -40 °C to +85 °C.

RoHS Compliant.

720mA Current Capability.

Part Number	Electrical Specifications @25°C						
	Turns Ratio (±5%)	OCL(uH Min) @100KHz,0.1V With 10.8mA DC Bias	CWW(pF Max) @100KHz,0.1V	DCR (Ω Max)	Insertion Loss (dB Max)	Return Loss (dB Min)	HI-POT (Vrms)
QA021G00	1CT:1CT	120	35	1.2	-0.8@1-100MHz -1.2@100-200MHz	-23@1.0-40MHz -23+15*Log10(F/40)@40-200MHz	1500

MECHANICAL

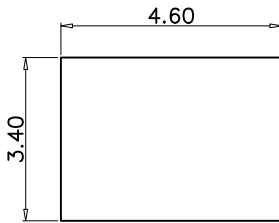

TOP VIEW

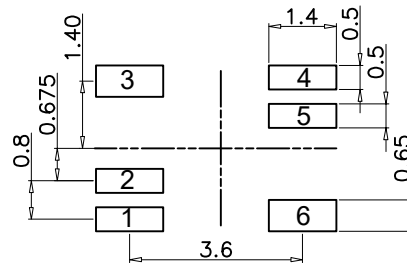

SUGGEST LAYOUT

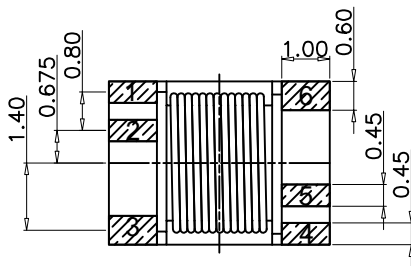

BOTTOM VIEW

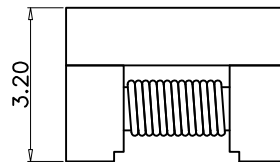

FRONT VIEW

Unless otherwise specified all tolerances are:±0.25 in mm

SCHEMATICS

