

REV.	ECN. NO.	APPD.
A		

NOTES:
 Current Rating:3.0AMP
 Contact Resistance:20mΩ max
 Withstand Voltage:500V AC/DC
 Insulation Resistance:1000MΩ mi
 Operation Temperature:-40°C to +105°C

Contact Material:Phosphor Bronze
 Contact plating:Au or Sn Over Ni
 Insulator Material:PBT or PA6 +30%GF(UL94V-0)
 Contact plated:Gold Flash

Recommended P.C.B Layout
 (PCB BOARD TOLERANCE±0.05)

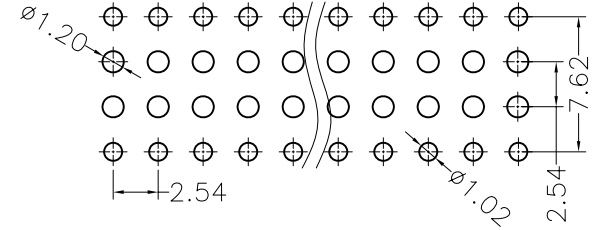
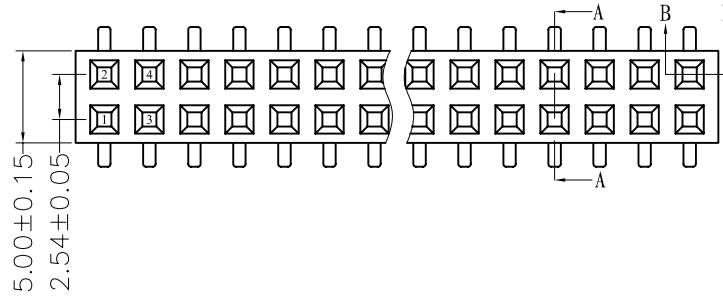

Ordering Information

MTF150-2XX WU1

No. of Pins per ROW:02-40PIN

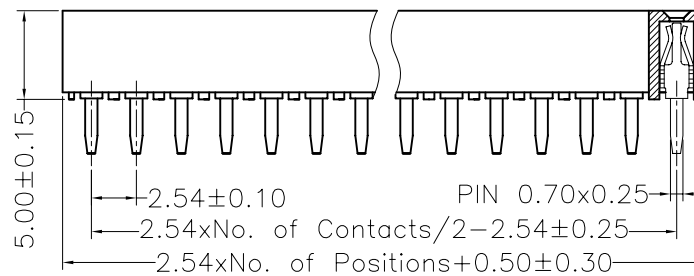

SECTION: B-B

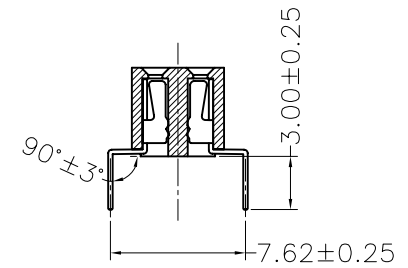

SECTION: A-A

X. ± 0.30	X.° ± 5°	UNITS mm	NAME(INTENDED USE)	MINTRON CO.,LTD.						
.X ± 0.20	.X° ± 2°	MAT'L	PART NO.(INTENDED USE)		TITLE: FH2.54 DUAL CENTIPEDE H=5.0					
.XX ± 0.10	.XX° ± 1°	FINISH	APPD: SUNNY	DWG NO.:						
.XXX ± 0.05	.XXX° ± 0.5°		Q'TY	CHKD: LISA	MTF150-2XXWU1					
FEMALE HEADER CONNECTOR			DR: ZOE 2006-11-28	<table border="1"> <tr> <td>SCALE</td> <td>SHEET</td> <td>REV.</td> </tr> <tr> <td>1/1</td> <td>1/1</td> <td>A</td> </tr> </table>	SCALE	SHEET	REV.	1/1	1/1	A
SCALE	SHEET	REV.								
1/1	1/1	A								