

4 CIRCUIT SHOWN

NOTES:

1. MATERIAL: SEE TABLE
2. FINISHES : SEE TABLE
3. "XX" REFERS TO THE NUMBER OF CIRCUITS.
4. ALL COMPONENTS ARE ROHS COMPLIANT.

9	2(XX)	SCREW W/WASHER, #6-32, PHIL-SLOT (OPT -49 -50)	BRASS	NICKEL PLATED
8	2(XX)	SCREW, #6-32, PHIL-SLOT (OPT -56)	STAINLESS STEEL	STAINLESS STEEL
7	2(XX)	SCREW W/WASHER, #6-32, PHIL-SLOT (OPT -50)	STEEL	ZN, CLEAR CHROMATE
6	2(XX)	SCREW, #6-32, PHIL-SLOT (OPT -49)	BRASS	NICKEL PLATED
5	2(XX)	SCREW, #6-32, SLOTTED (OPT -45)	STEEL	ZN, CLEAR CHROMATE
4	2(XX)	SCREW, #6-32, PHIL-SLOT (STD)	STEEL	ZN, CLEAR CHROMATE
3	XX	TERMINAL (USE W/OPT -49 SCREW)	BRASS	TIN PLATED
2	XX	TERMINAL, PLATE	BRASS	NICKEL PLATED
1	1	INSULATOR, DOUBLE ROW	THERMOPLASTIC	BLACK
ITEM	QTY.	DESCRIPTION	MATERIAL	FINISH

TOLERANCES			
MM	TOL	INCH	TOL
0-6	±0.25	0-.24	±.010
>6-30	±0.40	.24-1.18	±.016
>30-120	±0.50	1.18-4.76	±.020
>120	±0.80	>4.76	±.031

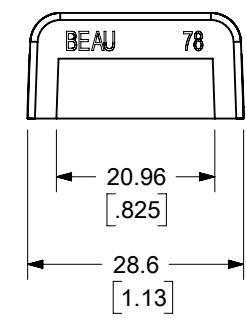

THIS DRAWING CONTAINS INFORMATION THAT IS PROPRIETARY TO MOLEX ELECTRONIC TECHNOLOGIES, LLC AND SHOULD NOT BE USED WITHOUT WRITTEN PERMISSION

FUNCTIONAL SYMBOLS: $\frac{A}{A} = 0$, $\frac{E}{E} = 0$, $\frac{F}{F} = 0$

DIMENSION UNITS: MM/INCH, SCALE: 1:1

GENERAL TOLERANCES (UNLESS SPECIFIED):

	MM	INCH
4 PLACES	±	±
3 PLACES	±	±
2 PLACES	±	±
1 PLACE	±	±
0 PLACES	±	±

ANGULAR TOL: ± °

DRAFT WHERE APPLICABLE MUST REMAIN WITHIN DIMENSIONS

THIRD ANGLE PROJECTION:

DRAWING: B-SIZE

SERIES: 38780

CURRENT REV DESC: REMOVED OBSOLETE PART NUMBERS AS PER PCN#512245.

EC NO: 739748

DRWN: SANTHN 2023/02/22

CHKD: GGA 2023/02/24

APPR: GGA 2023/02/24

INITIAL REVISION:

DRWN: CYORK 2006/01/23

APPR: RDEROSS 2006/01/23

DOCUMENT NUMBER: SD-38780-001

DOC TYPE: PSD

DOC PART: 001

REVISION: F3

MATERIAL NUMBER: SEE CHART

CUSTOMER: GENERAL MARKET

SHEET NUMBER: 1 OF 2

molex

11.11MM [0.438] DR BTS, CB ASY

PRODUCT CUSTOMER DRAWING

(F2)

NO. OF CIRCUITS "XX"	DIM. "A"		DIM. "B"		DIM. "C"		MATERIAL NO. (STD)	MATERIAL NO. (-49 OPT)	MATERIAL NO. (-50 OPT)	MATERIAL NO. (-56 OPT)	MATERIAL NO. (-10A IMP OPT)	MATERIAL NO. (-49 -50 OPT)
	MM	IN	MM	IN	MM	IN						
02	41.3	[1.62]	11.11	[.438]	32.83	[1.293]	387800102	387800202	387800302	387890014	387800502	387890401
03	52.4	[2.06]	22.23	[.875]	43.94	[1.730]	387800103	387800203	387800303	387890032	---	---
04	63.5	[2.50]	33.34	[1.313]	55.05	[2.168]	387800104	387800204	387800304	387890039	---	387890402
05	74.6	[2.94]	44.45	[1.750]	66.17	[2.605]	387800105	---	387800305	387890067	---	---
06	85.7	[3.37]	55.56	[2.188]	77.28	[3.043]	387800106	387800206	387800306	387890075	---	---
07	96.8	[3.81]	66.68	[2.625]	88.39	[3.480]	387800107	---	387800307	387890285	387800507	---
08	107.9	[4.25]	77.79	[3.063]	99.50	[3.918]	387800108	387800208	387800308	387890095	387800508	387890403
09	119.0	[4.69]	88.90	[3.500]	110.62	[4.355]	387800109	---	---	387890290	387800509	---
10	130.2	[5.12]	100.01	[3.938]	121.73	[4.793]	387800110	---	387800310	387890120	387800510	---
11	141.3	[5.56]	111.13	[4.375]	132.84	[5.230]	---	387800211	---	387890132	387800511	---
12	152.4	[6.00]	122.24	[4.813]	143.95	[5.668]	387800112	---	387800312	387890134	387800512	387890404
13	163.5	[6.44]	133.35	[5.250]	155.07	[6.105]	---	---	---	---	387800513	---
14	174.6	[6.87]	144.46	[5.688]	166.18	[6.543]	387800114	---	387800314	387890151	387800514	---
15	185.7	[7.31]	155.58	[6.125]	177.29	[6.980]	387800115	---	---	387890153	387800515	---
16	196.8	[7.75]	166.69	[6.563]	188.40	[7.418]	387800116	---	---	387890159	387800516	---
17	207.9	[8.19]	177.80	[7.000]	199.52	[7.855]	---	---	---	387890161	387800517	---
18	219.1	[8.62]	188.91	[7.438]	210.63	[8.293]	387800118	---	---	387890165	387800518	---
19	230.2	[9.06]	200.03	[7.875]	221.74	[8.730]	---	---	387800319	---	387800519	---
20	241.3	[9.50]	211.14	[8.313]	232.85	[9.168]	387800120	---	---	387890174	---	387890405
21	252.4	[9.94]	222.25	[8.750]	243.97	[9.605]	387800121	387800221	387800321	---	387800521	---
22	263.5	[10.37]	233.36	[9.188]	255.08	[10.043]	387800122	---	---	387890180	387800522	---
23	274.6	[10.81]	244.48	[9.625]	266.19	[10.480]	---	---	---	---	387800523	---
24	285.7	[11.25]	255.59	[10.063]	277.30	[10.918]	387800124	---	---	387890184	387800524	---
25	296.8	[11.69]	266.70	[10.500]	288.42	[11.355]	387800125	---	---	387890262	387800525	---
26	308.0	[12.12]	277.81	[10.938]	299.53	[11.793]	---	---	387800326	387890186	387800526	---
27	319.1	[12.56]	288.93	[11.375]	310.64	[12.230]	---	---	---	---	387800527	---
28	330.2	[13.00]	300.04	[11.813]	321.75	[12.668]	---	387800228	---	---	387800528	---
29	341.3	[13.44]	311.15	[12.250]	332.87	[13.105]	---	387800229	387800329	---	387800529	---
30	352.4	[13.87]	322.26	[12.688]	343.98	[13.543]	387800130	---	---	387890188	387800530	---

TOLERANCES			
MM	TOL	INCH	TOL
0-6	±0.25	0-.24	±.010
>6-30	±0.40	.24-1.18	±.016
>30-120	±0.50	1.18-4.76	±.020
>120	±0.80	>4.76	±.031

FUNCTIONAL SYMBOLS		THIS DRAWING CONTAINS INFORMATION THAT IS PROPRIETARY TO MOLEX ELECTRONIC TECHNOLOGIES, LLC AND SHOULD NOT BE USED WITHOUT WRITTEN PERMISSION	
FA = 0	MM/INCH	SCALE	1:1
FE = 0	GENERAL TOLERANCES (UNLESS SPECIFIED)		
FF = 0	MM	INCH	
	4 PLACES ±	±	±
	3 PLACES ±	±	± SEE CHART
	2 PLACES ±	±	± SEE CHART
	1 PLACE ±	±	± SEE CHART
	0 PLACES ±	±	±
	ANGULAR TOL ± °		
DIVISIONAL SYMBOLS		CURRENT REV DESC: REMOVED OBSOLETE PART NUMBERS AS PER PCN#512245.	
		EC NO: 739748	
		DRWN: SANTHN 2023/02/22	
		CHKD: GGA 2023/02/24	
		APPR: GGA 2023/02/24	
		INITIAL REVISION:	
		DRWN: CYORK 2006/01/23	
		APPR: RDEROSS 2006/01/23	
DRAFT WHERE APPLICABLE MUST REMAIN WITHIN DIMENSIONS		THIRD ANGLE PROJECTION	DRAWING
			B-SIZE
		SERIES	38780
DOCUMENT STATUS		DOCUMENT NUMBER	SD-38780-001
P1	RELEASE DATE	DOC TYPE	PSD
2023/02/24	09:10:34	DOC PART	001
		REVISION	F3
		MATERIAL NUMBER	SEE CHART
		CUSTOMER	GENERAL MARKET
		SHEET NUMBER	2 OF 2

