

633M/634M SERIES



Machined D-Sub Connectors: Right Angle, High Density, 0.350" (8.89mm) Footprint

Features:

- High density three contact rows with 0.350"(8.89mm) footprint, right angle bend with machined contacts
- 0.090"(2.29mm) contact spacing, 0.078"(1.98mm) row spacing
- Plug and receptacle in 15, 26, 44 or 62 contact sizes
- Pin and socket contact mating design with P.C. tail termination
- Metal shell provides EMI/RFI shielding, plug shell indents provide grounding and additional mating retention
- Grounding features include brackets and four prong boardlock for exceptional retention to P.C. board
- Mounting options for panel mount or connector mating include through hole, threaded inserts and threaded standoffs
- D-shaped connector mating outline provides polarization

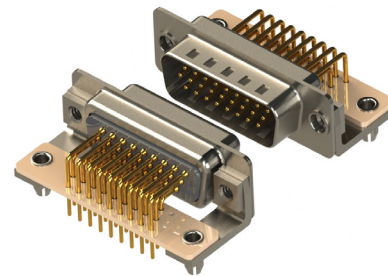

Specifications:

Insulator Material	PA9T, UL 94V-0, Color: Black or White (PA6T, UL 94V-0 for 62 Contacts)
Contact Material	Copper Alloy
Contact Plating	Gold Plating over Nickel All Over
Shell Material	Nickel Plated Steel
Current Rating	5 amps
Contact Resistance	10 Milliohms maximum
Dielectric Withstanding Voltage	5000 megaohms minimum
Insulation Resistance	1000 V AC rms at Sea Level
Operating Temperature	-55°C To +125°C

Ordering Code:

634-M15-263-BN1

SERIES: _____

633: PLUG (PIN)

634: RECEPTACLE (SOCKET)

MACHINED CONTACTS _____

NO. OF CONTACTS: _____

15 - 15 CONTACTS 26 - 26 CONTACTS

44 - 44 CONTACTS 62 - 62 CONTACTS

CONTACT FINISH CODE: _____

2 - GOLD FLASH PLATING

3 - 15 MICROINCHES OF GOLD PLATING

6 - 30 MICROINCHES OF GOLD PLATING

CONTACT CODE: _____

63 - STANDARD CONTACT TAIL LENGTH(3.50 ±0.40)

MOUNTING & GROUNDING OPTIONS:

1 - Ø3.05 THRU HOLE

2 - 4-40 UNC INSERT

3 - 4-40 UNC INSERT + STABILIZER PCB +
4 PRONG BOARD LOCK

4 - 4-40 UNC INSERT + STABILIZER PCB +
Ø3.20 DIA HOLE

5 - 4-40 UNC STANDOFF + STABILIZER PCB +
4 PRONG BOARD LOCK

6 - 4-40 UNC STANDOFF + STABILIZER PCB +
Ø3.20 DIA HOLE

SHELL PLATING CODE:

N - NICKEL

T - TIN

MATERIAL CODE:

B - BLACK

W - WHITE

MOUNTING & GROUNDING OPTIONS

CODE - 1
THRU HOLE

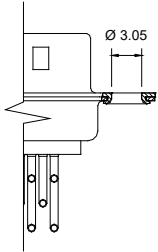

CODE - 2
4-40 UNC INSERT

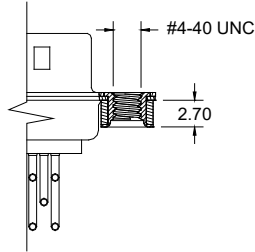

CODE - 3
4-40 UNC INSERT+PCB + BOARDLOCK

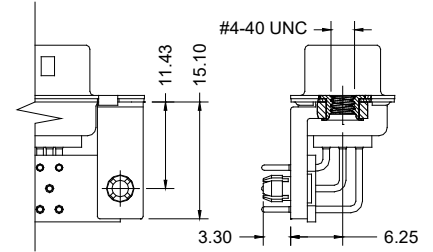

CODE - 4

4-40 UNC INSERT+PCB + THRU HOLE

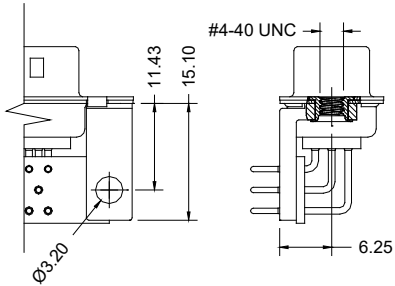

CODE - 5

4-40 UNC STANDOFF+PCB + BOARDLOCK

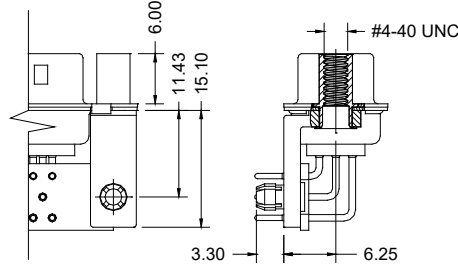

CODE - 6

4-40 UNC STANDOFF+PCB + THRU HOLE

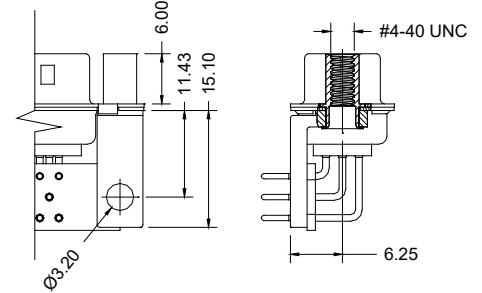

PLUG

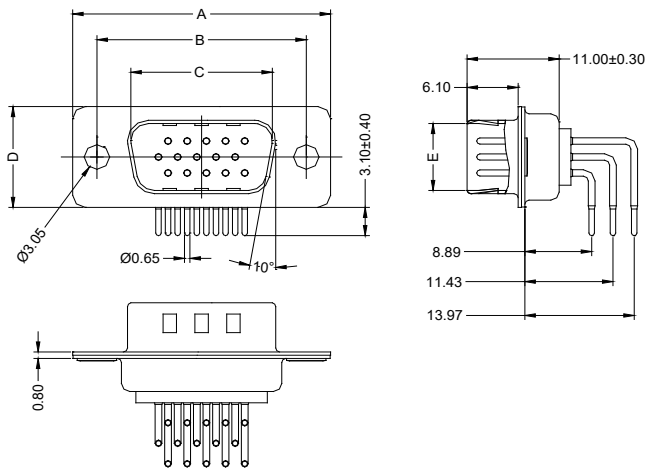

RECEPTACLE

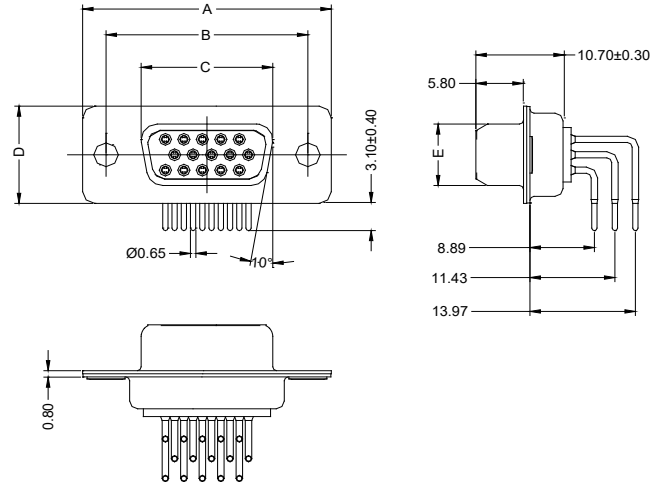

No. of pos.	A	B	C	D	E
15	30.80	25.00	16.90	12.50	8.30
26	39.20	33.30	25.25	12.50	8.30
44	53.05	47.05	38.95	12.50	8.30
62	69.40	63.50	55.40	12.50	8.30

No. of pos.	A	B	C	D	E
15	30.80	25.00	16.30	12.50	7.90
26	39.20	33.30	24.60	12.50	7.90
44	53.05	47.05	38.40	12.50	7.90
62	69.40	63.50	54.80	12.50	7.90

PCB LAYOUT FOR RECEPTACLE

PCB LAYOUT FOR PLUG

15 Pos

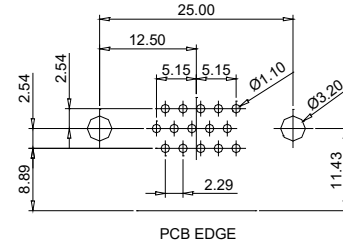
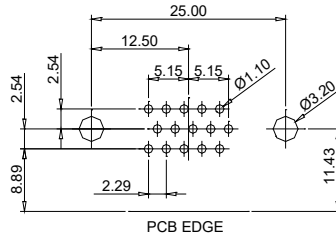

26 Pos

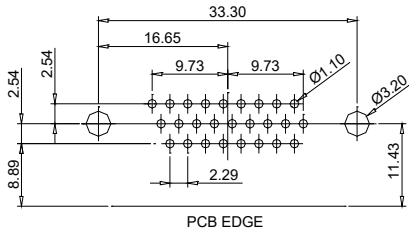

26 Pos

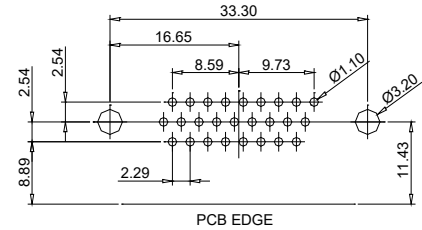

44 Pos

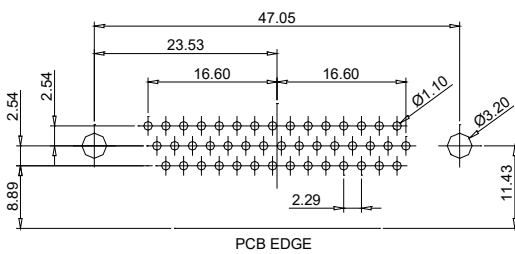

44 Pos

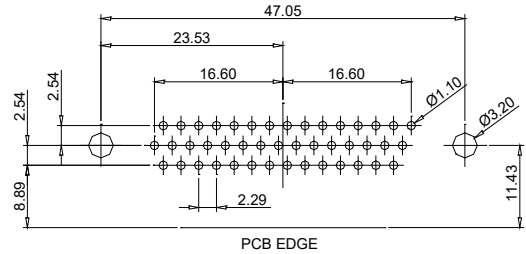

62 Pos

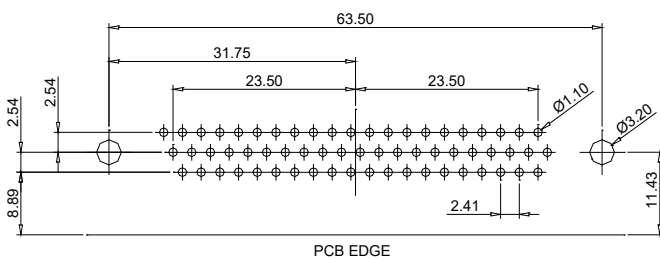

62 Pos

