

US1A THRU US1M

SURFACE MOUNT ULTRAFAST RECTIFIERS



VOLTAGE: 50~1000 Volts

CURRENT: 1.0 Amperes

SMA(DO-214AC)

Marking and Polarity

FEATURES

- The plastic package carries Underwriters Laboratory Flammability Classification 94V-0
- Idea for printed circuit board
- Glass passivated Junction chip
- Low reverse leakage
- High forward surge current capability
- High temperature soldering guaranteed 250°C/10 seconds at terminals

MECHANICAL DATA

- **Case:** Molded Plastic
- **Epoxy:** UL 94V-0 rate flame retardant
- **Polarity :** Polarity symbol marking on body
- **Mounting position:** Any
- **Weight:** App. 0.063 grams (0.0022 ounce)

TYPICAL APPLICATIONS

- For use in low voltage ,high frequency inverters ,DC/DC converters,LED driver, free wheeling ,and polarity protection applications

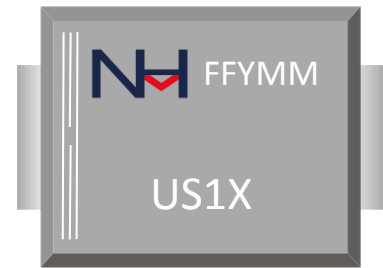

Remark:

- (1).NH=niuhang trademark;
- (2).FF=Production line,According to actual changes; YMM=Period code,According to actual changes;
- (3).US1X=Modle;X=A,B,D,G,J,K,M
- (4).White edge=Polarity mark

Maximum Ratings (Ratings at 25°C ambient temperature unless otherwise specified.)

| Parameter | Symbol | US 1A | US 1B | US 1D | US 1G | US 1J | US 1K | US 1M | Unit | |
|--|-------------|-------------|-------|-------|-------|-------|-------|-------|------|----|
| Maximum repetitive peak reverse voltage | V_{RRM} | 50 | 100 | 200 | 400 | 600 | 800 | 1000 | V | |
| Maximum RMS voltage | V_{RMS} | 35 | 70 | 140 | 280 | 420 | 560 | 700 | V | |
| Maximum DC blocking voltage | V_{DC} | 50 | 100 | 200 | 400 | 600 | 800 | 1000 | V | |
| Maximum average forward rectified current(see fig.1) | $I_{F(AV)}$ | 1.0 | | | | | | | A | |
| Peak forward surge current 8.3ms single half sine-wave superimposed on rated load (JEDEC method at rated TL) | I_{FSM} | 30 | | | | | | | A | |
| Maximum instantaneous forward voltage at 1.0 A (Note 1) | V_F | 1 | 1.4 | | 1.7 | | | | V | |
| Maximum instantaneous reversecurrent at rated DC blockingvoltage (Note 2) | I_{RRM} | 5 100 | | | | | | | uA | |
| Maximum Reverse Recovery Time (Note 3) | T_{RR} | 50 | | | | 75 | | | | nS |
| Typical junction capacitance (Note 4) | C_J | 15 | | | | | | | pF | |
| Operating junction and Storage temperature range | T_J | -55 to +150 | | | | | | | °C | |
| Storage temperature range | T_{STG} | -55 to +150 | | | | | | | | |

Thermal Characteristics (Ratings at 25°C ambient temperature unless otherwise specified)

| Parameter | Symbol | US1A THRU US1M | Unit |
|-------------------------------------|-----------------|----------------|------|
| Typical thermal resistance (Note 5) | $R_{\theta JA}$ | 50 | °C/W |
| | $R_{\theta JL}$ | 15 | |

Note: 1.Pulse test: 300 μs pulse width,1% duty cycle

2.Pulse test: pulse width≤40ms

3. Reverse Recovery Time test condition: IF=0.5A, IR=1.0A, IRR=0.25A

4.Measured at 1MHz and applied reverse voltage of 4.0V D.C.

5.Thermal resistance from junction to lead vertical P.C.B. mounted , 0.375"(9.5mm)lead length

US1A THRU US1M

SURFACE MOUNT ULTRAFAST RECTIFIERS



RATING AND CHARACTERISTIC CURVES

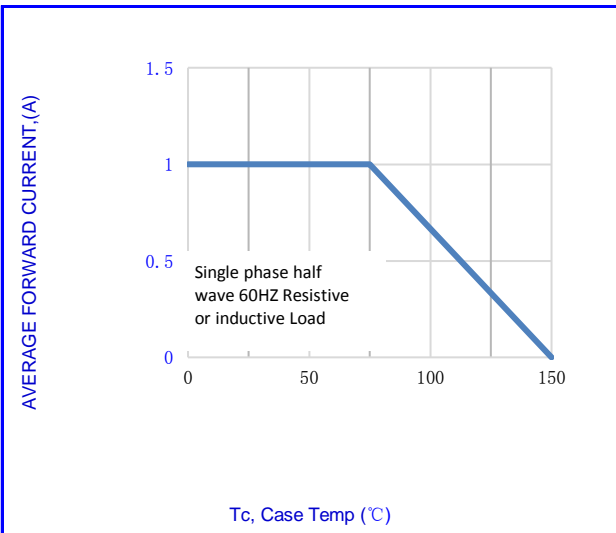

Fig.1-FORWARD CURRENT DERATING CURVE

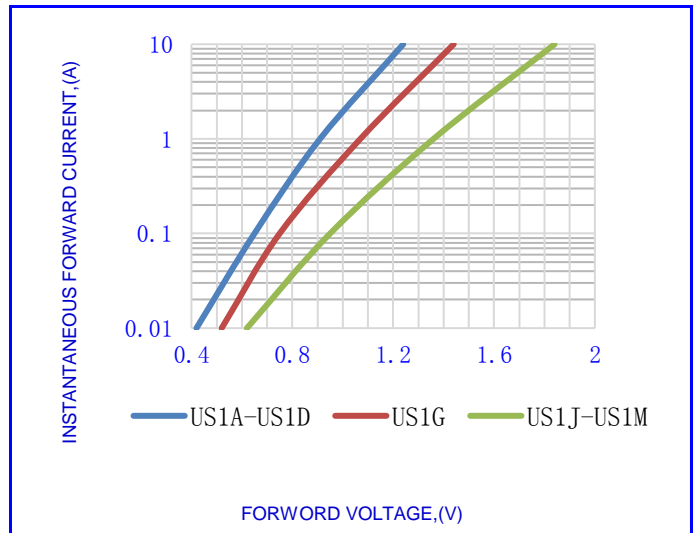

Fig.2- TYPICAL INSTANTANEOUS FORWARD

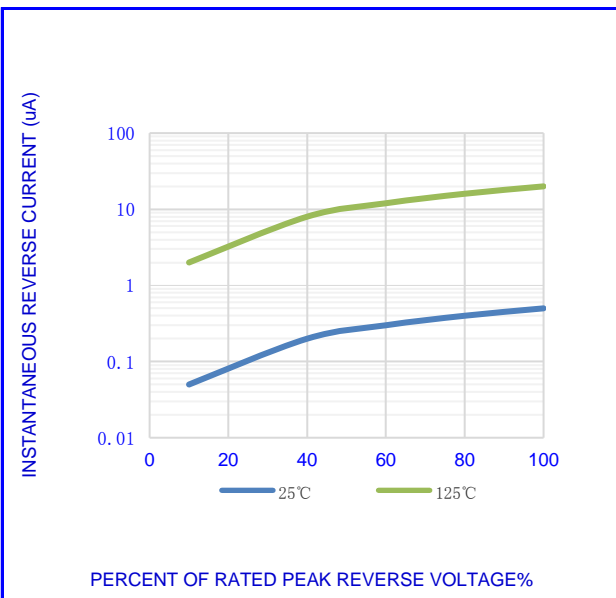

Fig.3- TYPICAL REVERSE CHARACTERISTICS

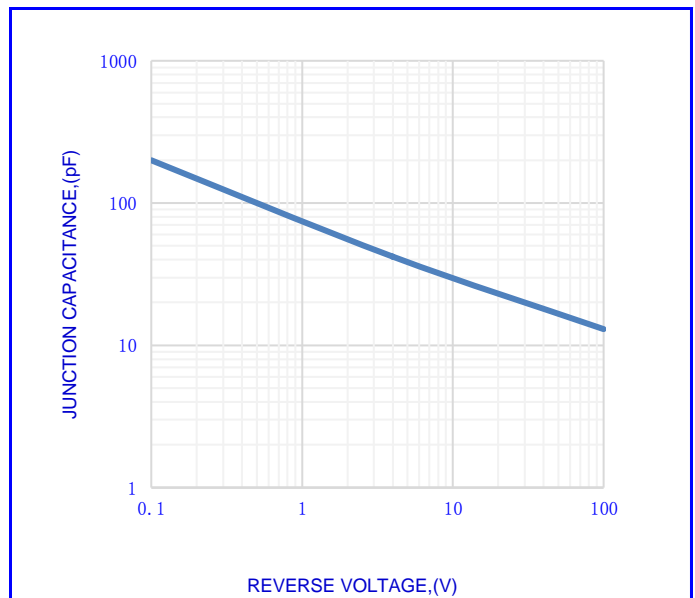

Fig.4- TYPICAL JUNCTION CAPACITANCE

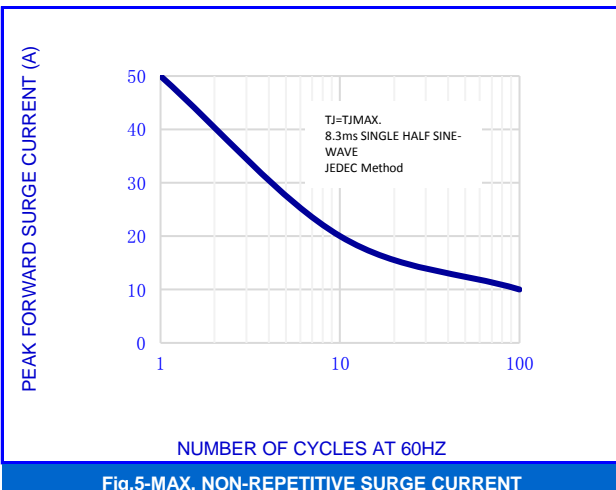

Fig.5-MAX. NON-REPETITIVE SURGE CURRENT

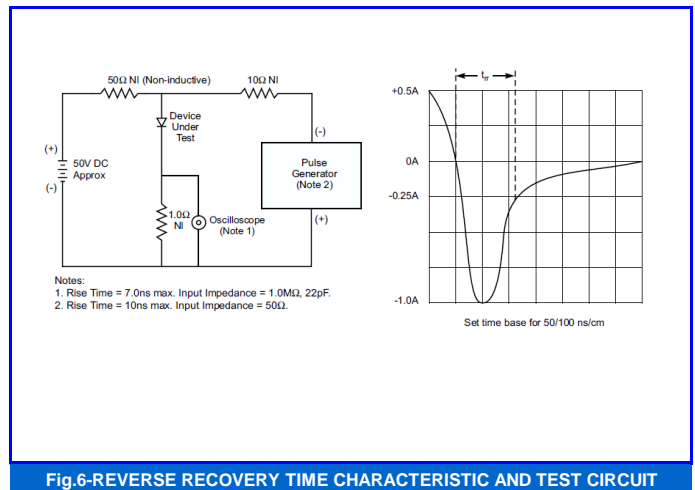

Fig.6-REVERSE RECOVERY TIME CHARACTERISTIC AND TEST CIRCUIT

US1A THRU US1M
SURFACE MOUNT ULTRAFAST RECTIFIERS



OUTLINE DRAWINGS

SMA(DO-214AC)

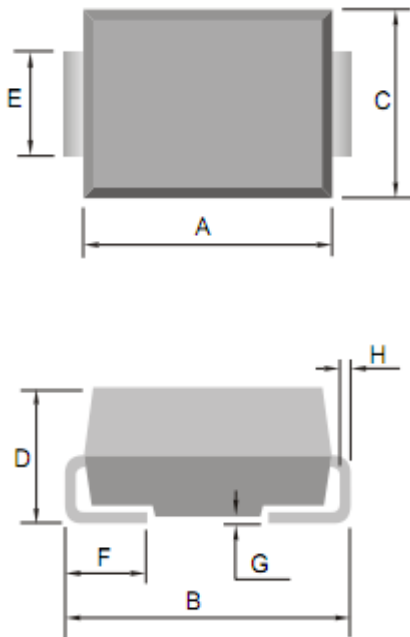

| OUTLINE DIMENSIONS | | | | | | |
|--------------------|------------|------|-------|--------|------|-------|
| Dim. | Milimeters | | | Inches | | |
| | Min. | Typ. | Max. | Min. | Typ. | Max. |
| A | 4.000 | - | 4.600 | 0.181 | - | 0.157 |
| B | 4.700 | - | 5.280 | 0.185 | - | 0.208 |
| C | 2.400 | - | 2.800 | 0.094 | - | 0.110 |
| D | 1.900 | - | 2.400 | 0.075 | - | 0.094 |
| E | 1.300 | - | 1.500 | 0.051 | - | 0.059 |
| F | 0.760 | - | 1.520 | 0.030 | - | 0.060 |
| G | 0.100 | - | 0.250 | 0.004 | - | 0.010 |
| H | 0.150 | - | 0.305 | 0.006 | - | 0.012 |

RECOMMENDED LAYOUT DRAWINGS

SMA(DO-214AC)

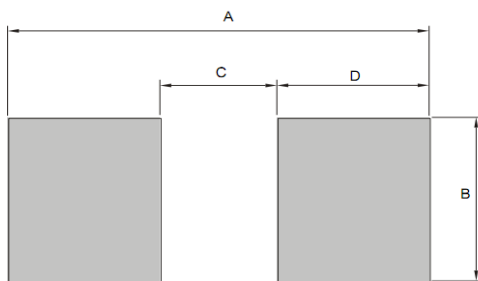

| RECOMMENDED MOUNTING PAD DIMENSIONS | | | | | | |
|-------------------------------------|------------|-------|------|--------|-------|------|
| Dim. | Milimeters | | | Inches | | |
| | Min. | Typ. | Max. | Min. | Typ. | Max. |
| A | - | 5.800 | - | - | 0.228 | - |
| B | - | 2.060 | - | - | 0.081 | - |
| C | - | 1.660 | - | - | 0.065 | - |
| D | - | 2.070 | - | - | 0.082 | - |

PACKING INFORMATION

SMA(DO-214AC)

| Package Method | Reel Size (mm) | Quantity (pcs/reel) | Inner Box Size | Quantity (pcs/Inner Box) | Carton Size LxWxH(mm) | Quantity (pcs/carton) |
|----------------|----------------|---------------------|----------------|--------------------------|-----------------------|-----------------------|
| Tape Reel | Φ330 | 5000 | 340x340x45 | 10000 | 360x360x470 | 100000 |

US1A THRU US1M

SURFACE MOUNT ULTRAFAST RECTIFIERS



Recommended wave soldering condition

| | | |
|-----------------|------------------|-----------------|
| Product | Peak Temperature | Soldering Time |
| Pb-free devices | 260 +0/-5 °C | 5 +1/-1 seconds |

Recommended temperature profile for IR reflow

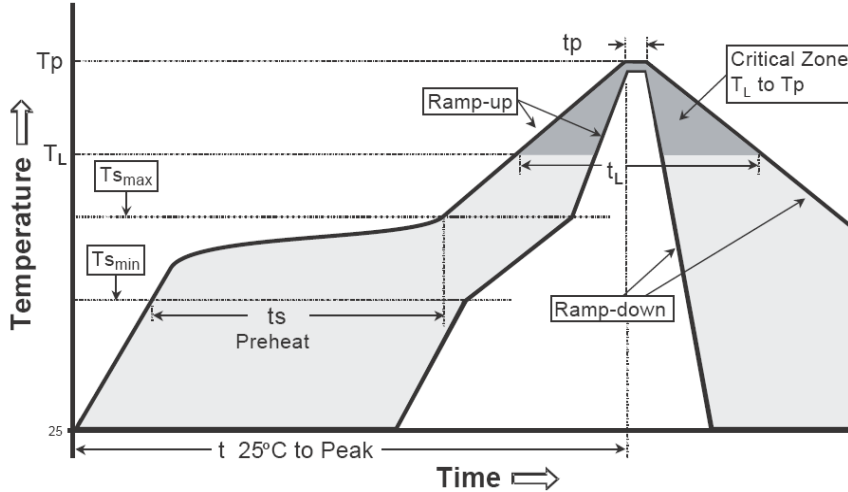

| Profile feature | Sn-Pb eutectic Assembly | Pb-free Assembly |
|--|----------------------------------|----------------------------------|
| Average ramp-up rate (Tsmax to Tp) | 3°C/second max. | 3°C/second max. |
| Preheat -Temperature Min(TS min) -Temperature Max(TS max) -Time(ts min to ts max) | 100°C 150°C 60-120 seconds | 150°C 200°C 60-180 seconds |
| Time maintained above: -Temperature (TL) - Time (tL) | 183°C 60-150 seconds | 217°C 60-150 seconds |
| Peak Temperature(TP) | 240 +0/-5 °C | 260 +0/-5 °C |
| Time within 5°C of actual peak temperature(tp) | 10-30 seconds | 20-40 seconds |
| Ramp down rate | 6°C/second max. | 6°C/second max. |
| Time 25 °C to peak temperature | 6 minutes max. | 8 minutes max. |

Note : All temperatures refer to topside of the package, measured on the package body surface.

US1A THRU US1M

SURFACE MOUNT ULTRAFAST RECTIFIERS



Disclaimer

- Reproducing and modifying information of the document is prohibited without permission from niuhang Electronics co., LTD
- Niuhan Electronics co., LTD. reserves the rights to make changes of the content herein the document anytime without notification.
- Niuhan Electronics co., LTD. disclaims any and all liability arising out of the application or use of any product including damages incidentally and consequentially occurred.
- Niuhan Electronics co., LTD. does not assume any and all implied warranties, including warranties of fitness for particular purpose, non-infringement and merchantability.
- Applications shown on the herein document are examples of standard use and operation. Customers are responsible in comprehending the suitable use in particular applications. Niuhan Electronics co., LTD. makes no representation or warranty that such applications will be suitable for the specified use without further testing or modification.
- The products shown herein are not designed and authorized for equipments requiring high level of reliability or relating to human life and for any applications concerning life-saving or life-sustaining, such as medical instruments, transportation equipment, aerospace machinery et cetera. Customers using or selling these products for use in such applications do so at their own risk and agree to fully indemnify Niuhan Electronics co., LTD. for any damages resulting from such improper use or sale.
- When the appearance of the product and chip size does not change, in order to product the customer quality, change the internal structure and the production process Niuhan can not notify