

# 1.View and size(视图及尺寸)

Main technical indicators(主要技术指标)	
1.Mating (插拔次数)	>3000
2.Working Temperature (温度)	-55~+150 °C
3.IP Rating (防护级别)	IP66/IP68
4. 振动	10Hz 2000Hz, acceleration 147m / S2, instantaneous break ≤ 1US/10Hz2000Hz加速度147m/S2, 瞬断≤1Us
5.盐雾	5% NaCl for 48 hours/5%NaCl雾气中48小时
6. 冲击	980m / S2, instantaneous ≤ 1 US, insulation resistance: > 3000 Ω (normal state)/980m/S2,,瞬间 ≤1 Us 绝缘电阻: > 3000 Ω (常态)
7.Diameter of socket end(插合端直径)	φ0.9
8.Testing Voltage (测试电压)	1500V
9.Working Voltage (工作电压)	1250V
10.Rated Current (额定电流)	10A
11.Shell material(壳体材质)	Brass (chromium plating) shell and chuck nut/( nickel plating) pin sleeve and middleware/黄铜(镀铬)外壳和夹头螺母/(镀镍)插销套和中间件
12.Pin Material(插针材料)	Copper alloy gold plating(铜合金镀金)
13.Insulator material(绝缘体材质)	PPS

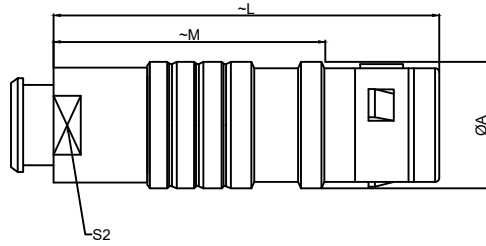

	A	L	M	S2
MM	φ16	52	36	12
in	0.63	2.05	1.42	0.47

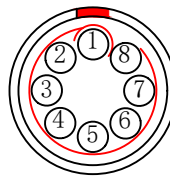

Welded surface (焊接面)

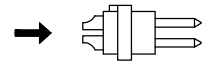

Solder core (焊接型公胶芯)

Sum up(总结)	
Series(系列)	K
Shell style/model (外壳样式/型号)	TGG: Straight plug, cable collet and nut for fitting a bend relief直塞、电缆夹头和螺母, 用于安装弯曲凸起
Button (按键)	A button(一个按键)
Termination type (终止类型)	Male solder(公焊锡)
Line diameter awg(线材直径)	30-22AWG
Cable diameterφ (电缆直径)	φ8.1-8.5MM
Matching parts(配件)	ZGG.2K.P08.CLL

	A	B	C√	ANGLE	
5-10	±0.02	±0.05	±0.1	0°-30°	±0.1°
50-100	±0.1	±0.15	±0.2	61°-90°	±0.5°
50-100	±0.15	±0.2	±0.25		
100-	±0.15%	±0.20%	±0.25%		

TGG.2K.P08.C L A C 85 H

- Model(型号) \_\_\_\_\_
  - Positioning pin(定位销) \_\_\_\_\_
  - Series(系列) \_\_\_\_\_
  - Needle core configuration(针芯配置) \_\_\_\_\_
  - Outer casing(外壳) \_\_\_\_\_
  - Insulator(绝缘体) \_\_\_\_\_
  - Needle core(针芯) \_\_\_\_\_
  - Type of clamp(线夹类型) \_\_\_\_\_
  - Cable diameter(电缆直径) \_\_\_\_\_
- SH means a sheath type, not a cover type.  
(H表示护套型, 不表示为不带护套型)

DESIGNED (设计)		DATE(日期)		SCALE(比例)	N/A(不适用)	MODEL TYPE 型号类型: TGG.2K.P08.CLAC85H
CHECKED (校对)		DATE(日期)		VIEW(视图)		PART NO. 2K8-core plug 名称: 2K8芯插头
APPROVED (审核)		DATE(日期)		UNIT(单位)	MM	DWG NO.:
REVISIONS			MATERIAL (材料)			
www.helloxkb.com www.helloxkb.cn			XKB INDUSTRIAL PRECISION CO.,LIMITED			WEIGHT(重量) SHEET(表) REVISION(修订)
						1/1 A0