

THIS DRAWING IS UNPUBLISHED. RELEASED FOR PUBLICATION
 © COPYRIGHT - By - ALL RIGHTS RESERVED.

LOC	DIST	REVISIONS			
P	LTR	DESCRIPTION	DATE	DWN	APVD
AF	50	H	REVISED PER ECR-13-005733	27AUG2013	KH PD

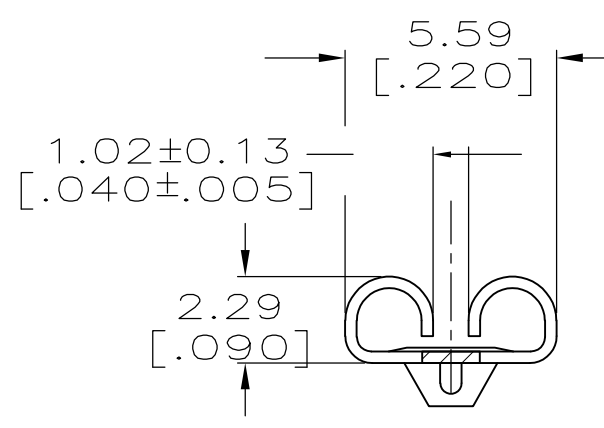
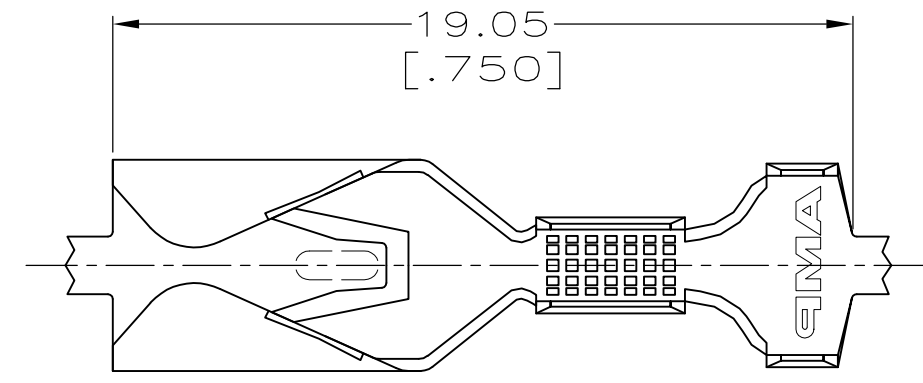

VIEW A-A

- 1 CONTINUOUS STRIP ON REELS.
- 2 TO BE USED WITH 60434 AND HOUSING 480252.
- 3 MAY BE USED WITH INDIVIDUAL 4.75 X 0.51 [0.187 X 0.020] THK TAB.
- 4 WIRE SIZE IS [#20-#16] AWG.
- 5 INSULATION RANGE IS 2.29-3.30 [0.090-0.130] DIA. OR TWO AT 2.79 [0.110] MAX.

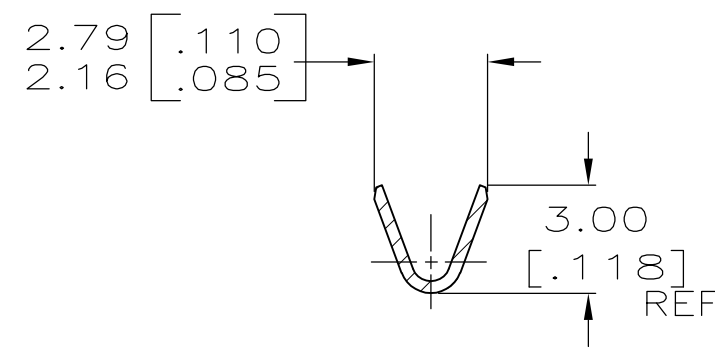
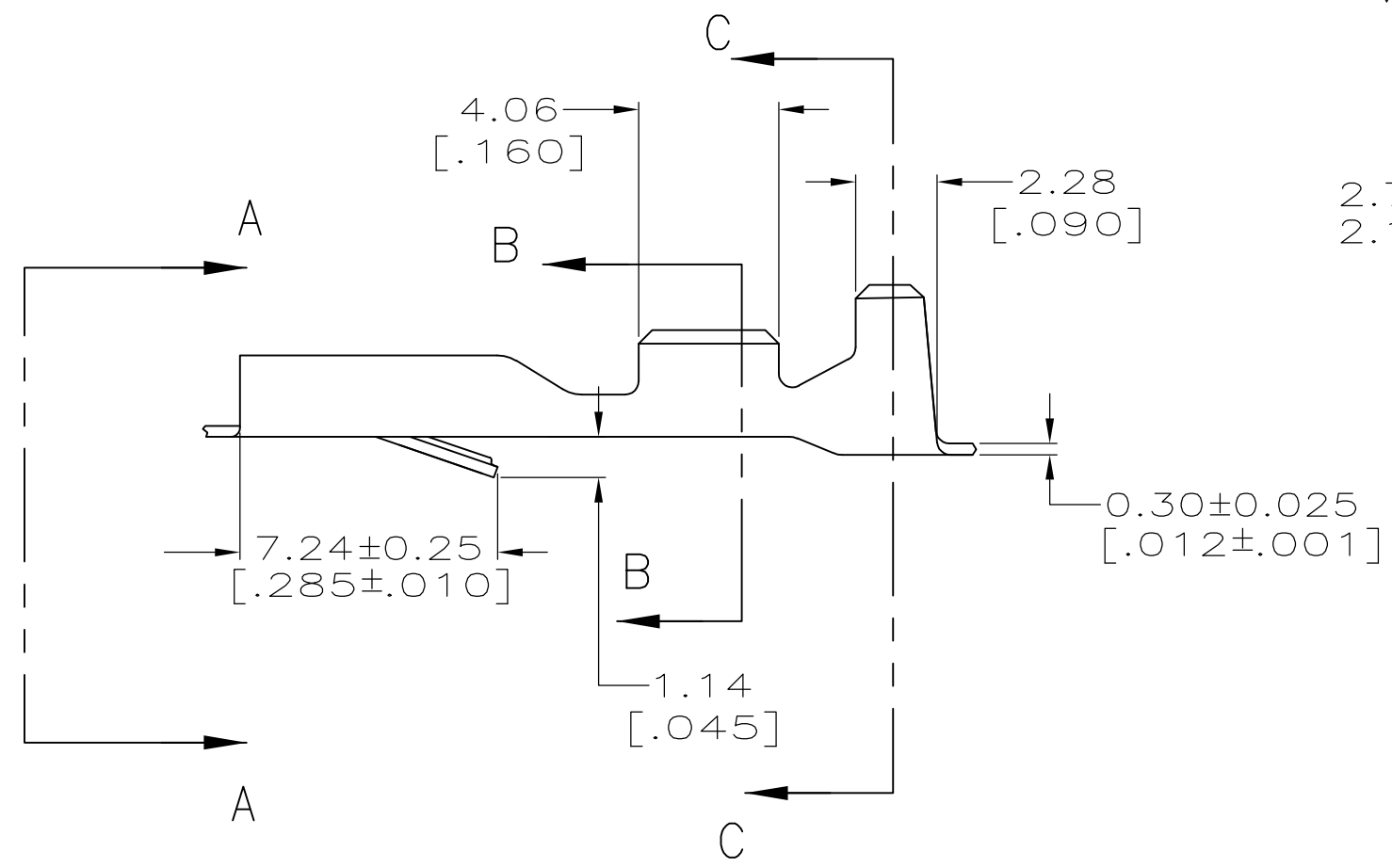

SECTION B-B

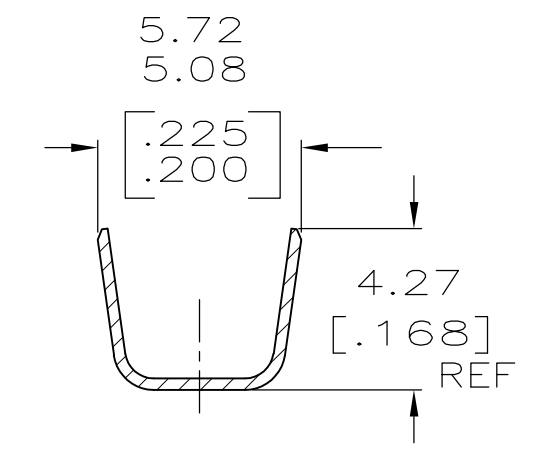

SECTION C-C

60435-1
PART NO.

THIS DRAWING IS A CONTROLLED DOCUMENT.		DWN	JR RUTH	3/6/97	TE Connectivity											
DIMENSIONS: mm [INCHES]		CHK	MS FEHER	3/6/97												
TOLERANCES UNLESS OTHERWISE SPECIFIED:		APVD	J GILLESPIE	3/6/97												
<table border="0"> <tr><td>0 PLC</td><td>± -</td></tr> <tr><td>1 PLC</td><td>± -</td></tr> <tr><td>2 PLC</td><td>± 0.38 [0.015]</td></tr> <tr><td>3 PLC</td><td>± -</td></tr> <tr><td>4 PLC</td><td>± -</td></tr> <tr><td>ANGLES</td><td>± -</td></tr> </table>		0 PLC	± -	1 PLC		± -	2 PLC	± 0.38 [0.015]	3 PLC	± -	4 PLC	± -	ANGLES	± -	PRODUCT SPEC	
0 PLC	± -															
1 PLC	± -															
2 PLC	± 0.38 [0.015]															
3 PLC	± -															
4 PLC	± -															
ANGLES	± -															
MATERIAL: BRASS		FINISH: PRE-TIN		RECEPTACLE, FASTIN-FASTON, 4.75 [0.187] SERIES												
		APPLICATION SPEC		SIZE	CAGE CODE											
MATERIAL: BRASS		FINISH: PRE-TIN		DRAWING NO												
MATERIAL: BRASS		FINISH: PRE-TIN		RESTRICTED TO												
MATERIAL: BRASS		FINISH: PRE-TIN		SCALE												
MATERIAL: BRASS		FINISH: PRE-TIN		SHEET												
MATERIAL: BRASS		FINISH: PRE-TIN		REV												
MATERIAL: BRASS		FINISH: PRE-TIN		H												