

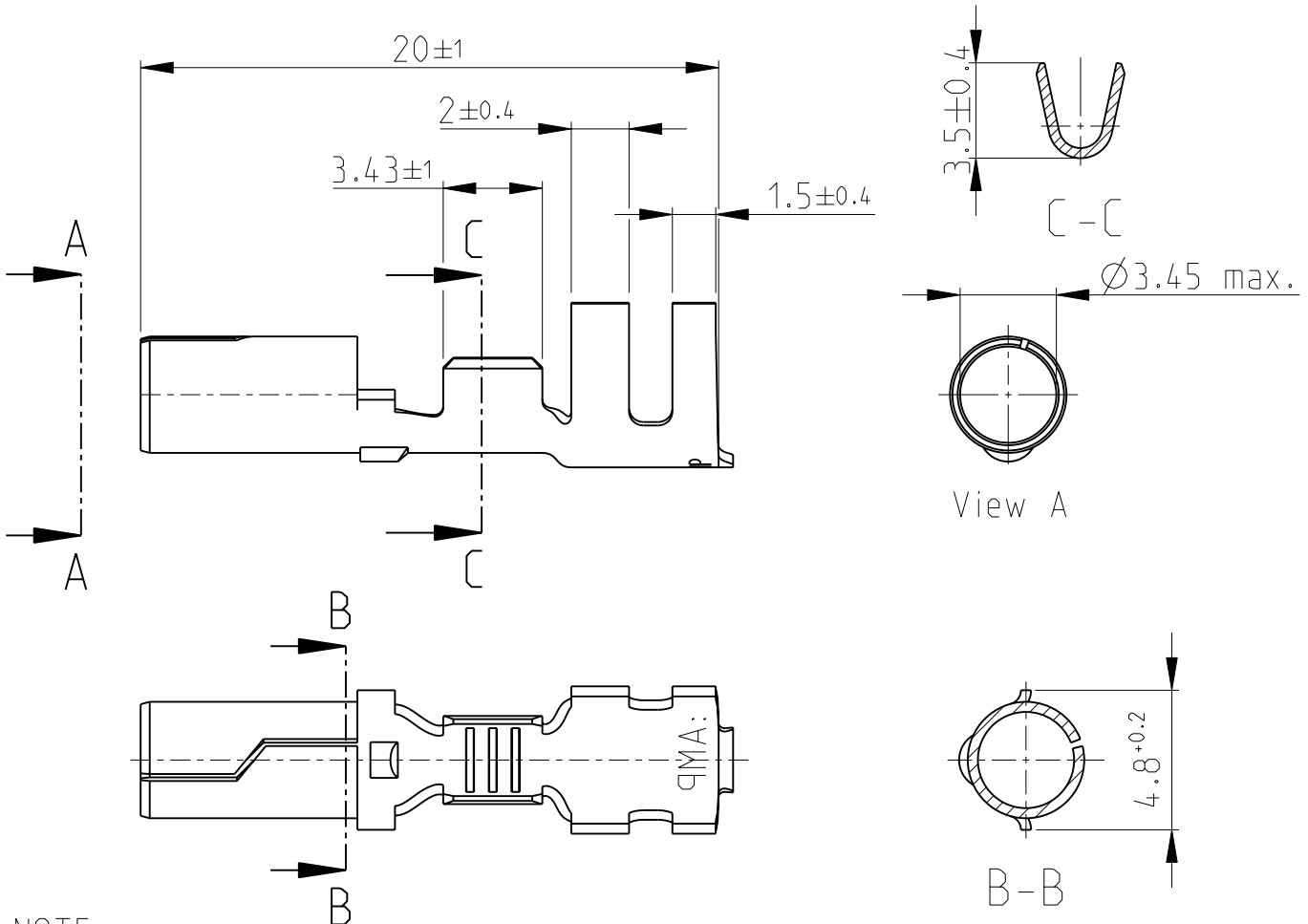

LOC	DIST	REVISIONS				
P	LTR	DESCRIPTION	DATE	DWN	APVD	
AL	2	A	New drawing released	24NOV2008	J.S	P.E.G
		A1	REVISED PER ECO-09-026495	17DEC2009	KK	AEG

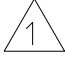

NOTE:  
 OBSOLETE PARTS: OBSOLETE CIS STREAMLINING PER D.RENAUD/D.SINISI

	0.5-2.1mm <sup>2</sup>	max. 4.5mm	Brass	Pre-tin	925866-4
 OBSOLETE	0.5-2.1mm <sup>2</sup>	max. 4.5mm	Bronze	Pre-tin	925866-3
	0.5-2.1mm <sup>2</sup>	max. 4.5mm	Bronze	Silver	925866-2
 OBSOLETE	0.5-2.1mm <sup>2</sup>	max. 4.5mm	Bronze	None	925866-1
	DGB	Insulation $\emptyset$	Material	Finish	Part no.

DIMENSIONS: mm	DWN J. Salo 24NOV2008	MATERIAL -	FINISH -
TOLERANCES UNLESS OTHERWISE SPECIFIED:	CHK R. Sole 24NOV2008	 Tyco Electronics Corporation Barcelona. Spain.	
0 PLZ ±- 1 P/C ±0.4 2 PLC ±- 3 PLC ±- 4 PLC ±- ANGLES ±1° 30'	APVD P.E.Grassano 24NOV2008		
	PRODUCT SPEC -	NAME .140 DIA SOCKET	
	APPLICATION SPEC -	SIZE A 4	RESTRICTED TO -
	WEIGHT -	DRAWING NO C-925866	
CUSTOMER DRAWING		SCALE 4:1	SHEET 1 OF 1 REV A1