

Panduit Part number	Wire range AWG (mm ²)	Tab Size	Housing color	Dim. "F"	Dim. "W"	Dim. "L"	Maximum Wire Insulation Diameter	MINIMUM Wire Insulation Diameter	Tools
DNG18-187FB	22-18 (0.5 - 1.0)	.187 X .032	Red	.22 (5.6)	.29 (7.4)	.89 (22.6)	.126 (3.20)	.050 (1.27)	CT-1015
DNG18-188FB	22-18 (0.5 - 1.0)	.187 X .020	Red	.22 (5.6)	.29 (7.4)	.89 (22.6)	.126 (3.20)	.050 (1.27)	
DNG18-250FB	22-18 (0.5 - 1.0)	.250 X .032	Red	.22 (5.6)	.35 (8.9)	.93 (23.6)	.126 (3.20)	.050 (1.27)	
* DNG14-187FB	16-14 (1.5 - 2.5)	.187 X .032	Blue	.25 (6.4)	.29 (7.4)	.89 (22.6)	.153 (3.89)	.070 (1.78)	
* DNG14-188FB	16-14 (1.5 - 2.5)	.187 X .020	Blue	.25 (6.4)	.29 (7.4)	.89 (22.6)	.153 (3.89)	.070 (1.78)	
DNG14-250FB	16-14 (1.5 - 2.5)	.250 X .032	Blue	.25 (6.4)	.35 (8.9)	.93 (23.6)	.153 (3.89)	.070 (1.78)	

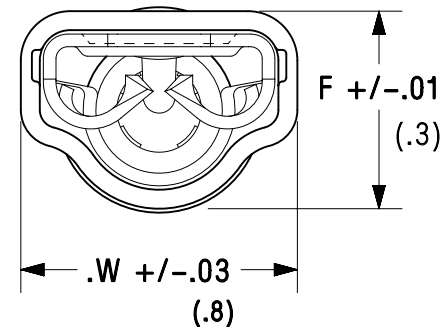

- Notes:
- Used for:
 - A. 600V max voltage rating
 - B. 221°F (105°C) max temperature rating
 - C. Stranded copper wire only
 - Wire strip length:
 - 250: $1/4 \begin{smallmatrix} +1/32 \\ -0 \end{smallmatrix} (6.4 \begin{smallmatrix} +.8 \\ -0 \end{smallmatrix})$
 - 187/188: $9/32 \begin{smallmatrix} +1/32 \\ -0 \end{smallmatrix} (7.1 \begin{smallmatrix} +.8 \\ -0 \end{smallmatrix})$
 - Material:
 - A. Stamping - Tin plated brass
 - B. Housing - Nylon
 - SEE www.panduit.com FOR PART NUMBER SUFFIX DESIGNATION FOR PACKAGE SIZE.
 - Dimensions in brackets are in millimeters or mm²
 - DNG14-187FB AND DNG14-188FB ARE UL RECOGNIZED FOR USE WITH COPPER ALLOY TABS.

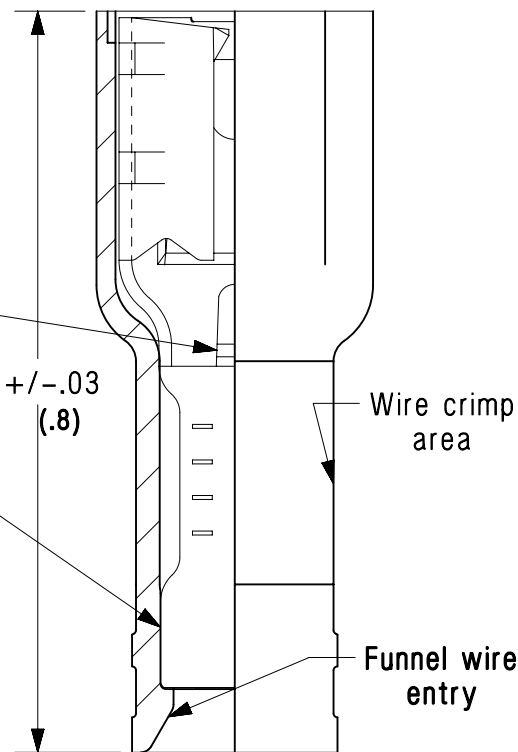

09	3-19-19	JEH	SKB	JADE	WAS: (A) LISTED 587H E52164	045190	
08	8/11	SHOR			MODIFIED NOTE #4, REMOVED PACKAGE SIZES		
07	02/11	SRB			Added Packaging code L= 50 pieces		
REV	DATE	BY	CHK	APR	DESCRIPTION	ECN	CUST

PANDUIT CORP. TINLEY PARK, ILLINOIS

Supra-Grip™
 Fully Insulated Loose Piece Female Disconnect

DRAWN BY: BDK CHK'D: RLS SCALE: None DRAWING NO./CAD FILENAME: A41570 / N41570BA