

版本	更改事项	签名	日期
B	更改标记处尺寸公差		
C	根据客户要求支架增加2个缺口		

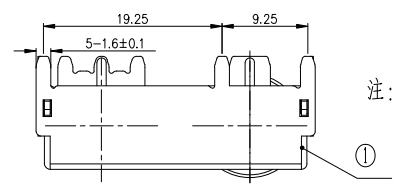
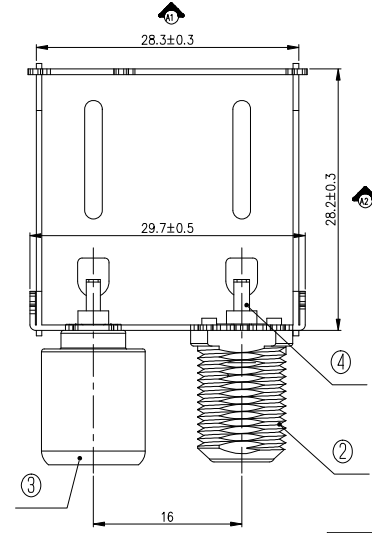
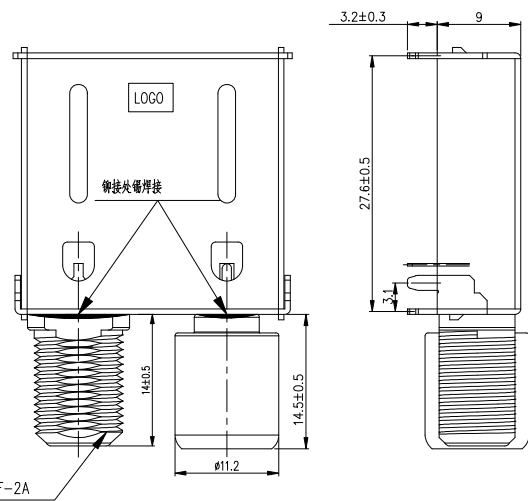
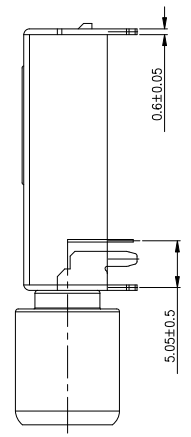
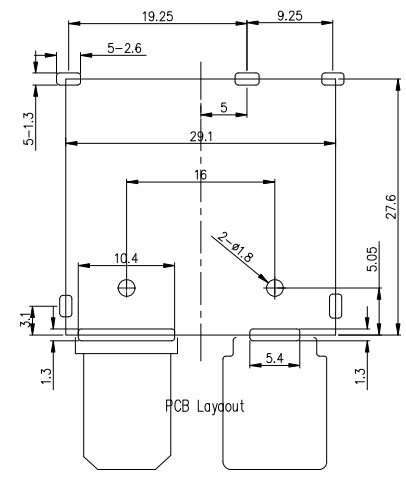
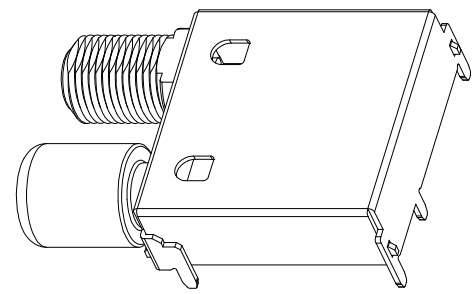
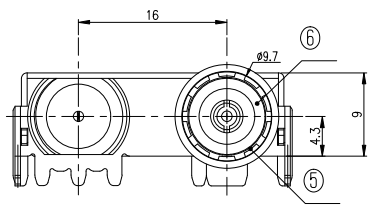

注：铆接头拉拔力 35kg，无脱离。

SPECIFICATION (技术要求)
 1. Operating Temperature(环境温度): -25℃~85℃
 2. Voltage Rating(额定电压): 50V AC/DC
 3. Current Rating(额定电流): 0.5A
 4. Contact Resistance(接触电阻): 30mΩ
 5. Insulation Resistance(绝缘电阻): 100MΩ
 6. Dielectric Withstanding Voltage(耐电压): 500V AC Min
 7. Insertion/Withdrawal Force(插拔力): 3-50N
 8. Life Time(mating cycles)寿命: >1000 Cycles
 9. All Material Must be Comply With RoHS.
 (此部品所有材料均符合RoHS要求.)

6	绝缘体	2	PPS	IEC头棕色/RF头棕色
5	接触片	1	不锈钢	-
4	插芯	2	磷铜	D.CuSn≥0.5μm
3	壳体	1	冷轧板	D.Ni≥1μm
2	RF头	1	Zinc Alloy	D.Ni≥1μm
1	Bracket 支架	1	冷轧板 t=0.6mm	D.CuSn≥0.5μm
NO.	Part Name零件名称	Qty数量	Material材料	Plating/Color镀层及颜色

GENERAL TOLERANCES		DIMENSION:		PART NAME	DRAWING NO			SHEET			
.XX±0.20		X±0.40			射频频插座	1 OF 1					
.X±0.30		ANGULAR: ±2°		PART NO.		HC-PBZ-R10401	PROJECTION	SCALE	UNIT	REV	
DRAWN					CUSTOMER NAME			mm	B		
CHECKED										CUSTOMER P/N	深圳市虹成电子有限公司
APPROVED											