

| | | | | |
|------|------|----------|------|------|
| REV. | Q'TY | ECN. NO. | APR. | DATE |
| | | | | |

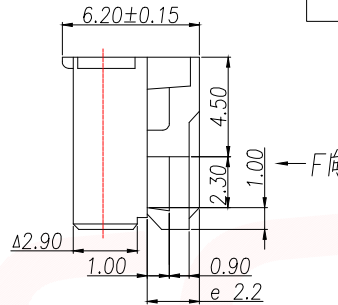
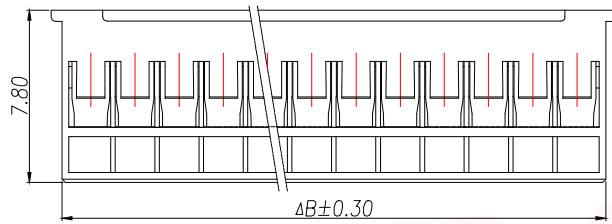
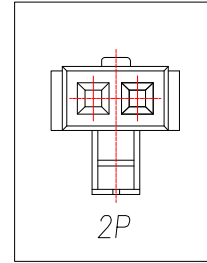
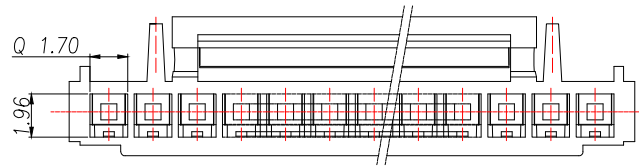

技术要求Specification:

1. 材质Material: PA66 UL94V-0;
2. 额定电流 Current rating:2.0A AC,DC
3. 额定电压 Voltage rating:250V AC,DC
4. 温度范围 Temperature range:-25℃to+85℃
5. 接触电阻 Contact resistance:≤20mΩ
6. 绝缘电阻Insulation resistance:≥1000MΩ
7. 耐压Withstand voltage:500V AC/minute
8. 塑件表面平整光洁, 无明显的毛刺、气泡、变形、浇口拉伤、缺料等不良现象。

Plastic surface smooth and clean, no obvious glitches, bubbles, distortion, gate strain, lack of material and other undesirable phenomena.

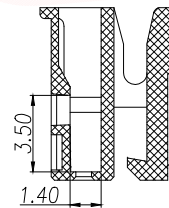
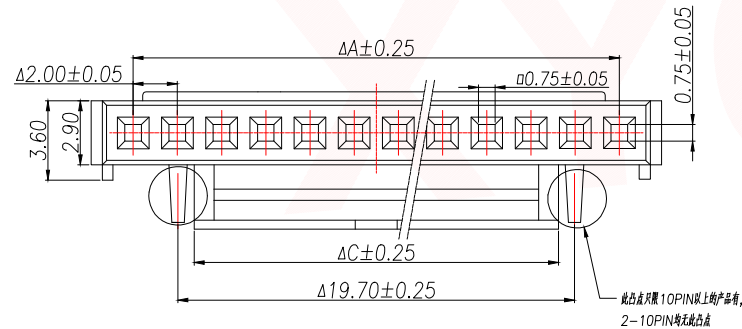

| Part No | Pin | A | B | C | D | E |
|----------------|-----|-------|-------|-------|-------|------|
| XY-HY2.0-2A41 | 2 | 2.00 | 4.70 | 2.30 | 1.00 | 0.60 |
| XY-HY2.0-3A41 | 3 | 4.00 | 6.70 | 2.30 | 1.00 | 0.60 |
| XY-HY2.0-4A41 | 4 | 6.00 | 8.70 | 4.30 | 1.70 | 1.00 |
| XY-HY2.0-5A41 | 5 | 8.00 | 10.70 | 4.30 | 1.70 | 1.00 |
| XY-HY2.0-6A41 | 6 | 10.00 | 12.70 | 8.30 | 5.90 | 1.95 |
| XY-HY2.0-7A41 | 7 | 12.00 | 14.70 | 10.30 | 7.90 | 1.95 |
| XY-HY2.0-8A41 | 8 | 14.00 | 16.70 | 12.30 | 9.90 | 1.95 |
| XY-HY2.0-9A41 | 9 | 16.00 | 18.70 | 12.30 | 9.90 | 1.95 |
| XY-HY2.0-10A41 | 10 | 18.00 | 20.70 | 12.30 | 9.90 | 1.95 |
| XY-HY2.0-11A41 | 11 | 20.00 | 22.70 | 16.30 | 13.90 | 1.95 |
| XY-HY2.0-12A41 | 12 | 22.00 | 24.70 | 16.30 | 13.90 | 1.95 |
| XY-HY2.0-13A41 | 13 | 24.00 | 26.70 | 16.30 | 13.90 | 1.95 |
| XY-HY2.0-14A41 | 14 | 26.00 | 28.70 | 16.30 | 13.90 | 1.95 |
| XY-HY2.0-15A41 | 15 | 28.00 | 30.70 | 16.30 | 13.90 | 1.95 |
| XY-HY2.0-16A41 | 16 | 30.00 | 32.70 | 16.30 | 13.90 | 1.95 |

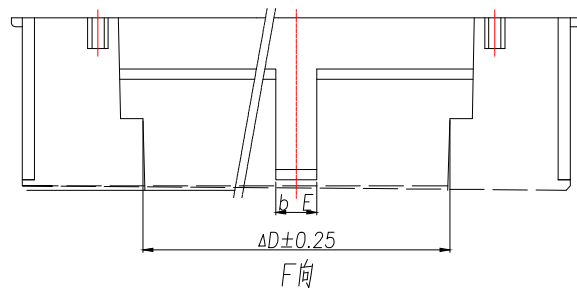

| | | | | |
|--------------------------------------|-----------|---|-----------|-------------------------|
| DIMENSION IN mm | | 厦门市辛译精密电子有限公司 Xiamen XinYi Xyecomm Electronics Co.,Ltd | | |
| TOLERANCE UNLESS OTHERWISE SPECIFIED | | | | |
| .X±0.35 | X.*± 5° | APR. | Alex | TITLE: HY2.0MM HOUSING |
| .XX±0.25 | .X.*± 3° | CHK. | Jack | DWG NO. XY-HY2.0-NA41 |
| .XXX±0.15 | .XX.*± 1° | DRA. | Can | PROJ. CUSTOMER DRAWING |
| | | SIZE A4 | SCALE 1:1 | SHEET 1/1 REV. A |