

NOTES:

- HOUSING MATERIAL: LCP, GLASS FILLED, UL 94V-0, BLACK
CONTACT MATERIAL: HIGH PERFORMANCE COPPER ALLOY
- FINISH:
CONTACTS: SELECTIVE GOLD: 30 MICRO INCHES MINIMUM ON CONTACT AREA
SELECTIVE TIN ON COMPLIANT PIN OVER 50 MICRO INCHES MINIMUM
NICKEL OVERALL
- PRODUCT SPECIFICATION: PS-172801-0001
- PACKAGING SPECIFICATION: PK-173358-0001
- APPLICATION SPECIFICATION: AS-172801-0001
- PARTS TO BE MARKED WITH THE PART NUMBER AND DATE CODE.
FORMAT IS 2 DIGIT YEAR, 3 DIGIT DAY, 1 DIGIT HOUR (IF NEEDED), AND
ONE DIGIT ASSEMBLY LINE (IF NEEDED) BY MARKING THE HOUSING AS SHOWN.
- THIS PART CONFORMS TO CLASS B REQUIREMENTS OF
MOLEX COSMETIC SPEC. PS-45499-002

173363-0001 PLUG ASSEMBLY SHOWN

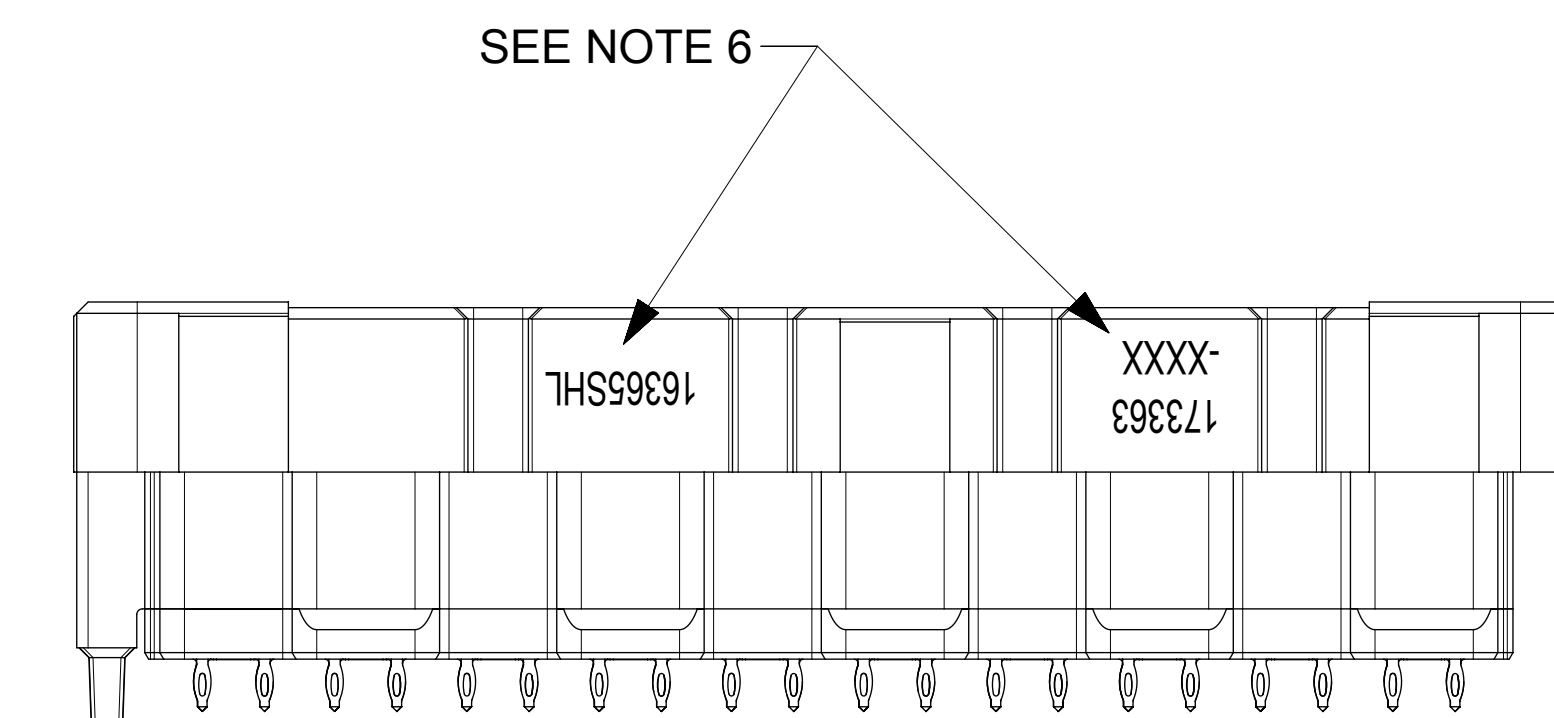
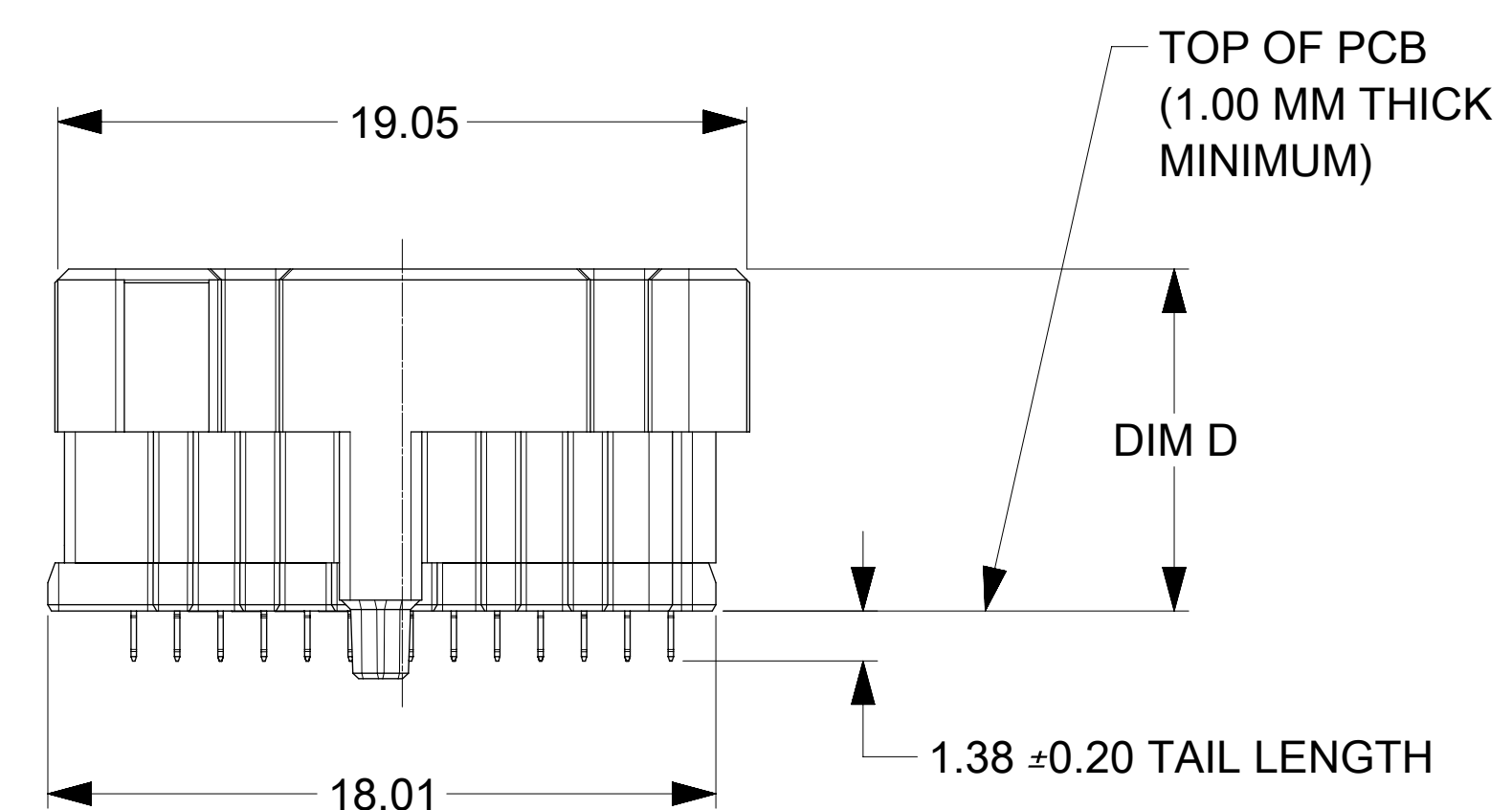
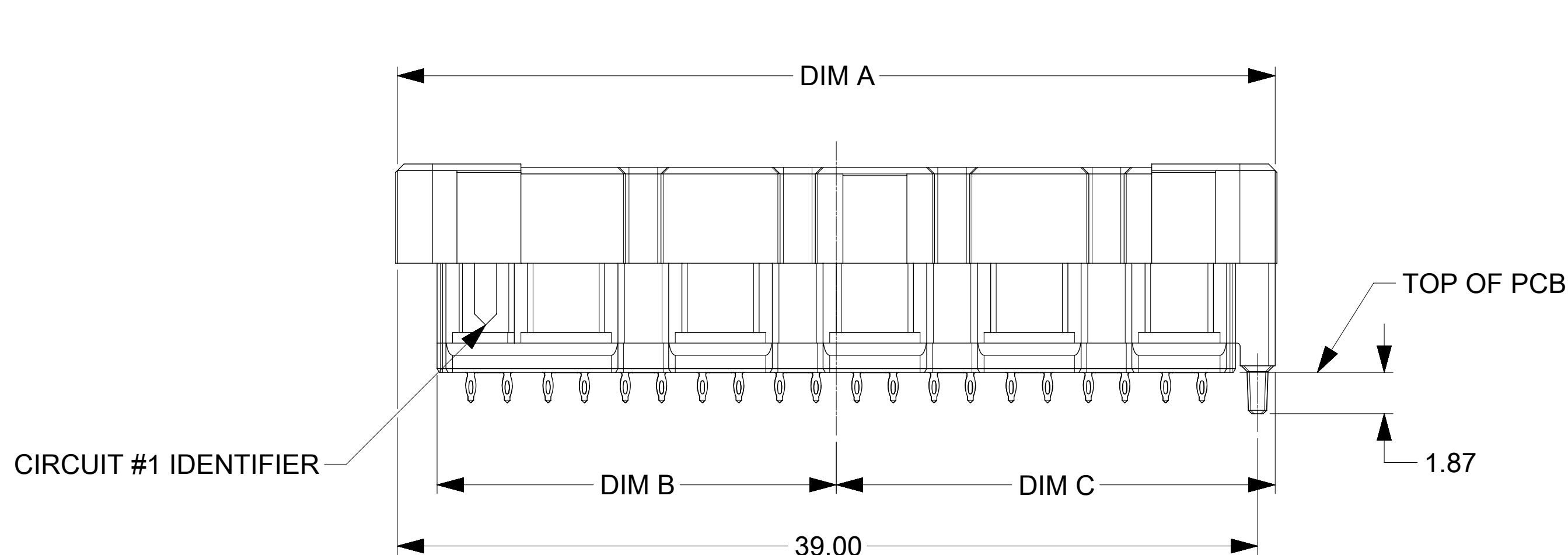
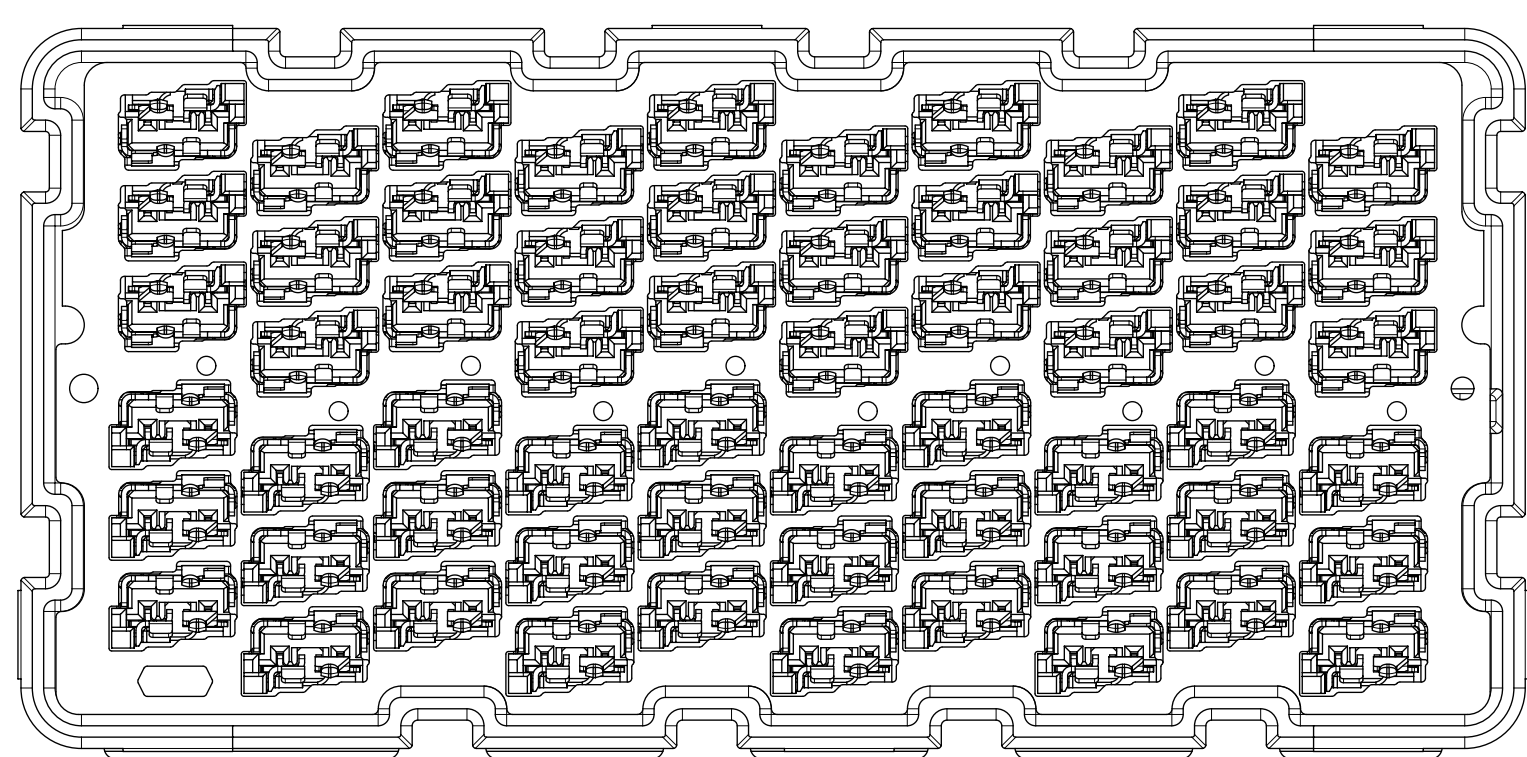

MATERIAL NUMBER	HEIGHT	NO. OF COLUMNS	DIM A	DIM B	DIM C	DIM D	TOOLED	MATES TO
1733630001	7.5	10	39.80	18.10	19.90	9.45	YES	1733640001 & 1728320005
1733630009	7.5	12	46.80	21.60	23.40	9.45	NO	1728320018 & 1728320019
1733630012	7.5	6	25.80	11.10	12.90	9.45	NO	1728320026
1733630014	7.5	14	53.80	25.10	26.90	9.45	NO	1728320001

SYMBOLS DIMENSION UNITS: mm SCALE: 5:1 GENERAL TOLERANCES (UNLESS SPECIFIED) ANGULAR TOL: ± ° 4 PLACES: ± 3 PLACES: ± 2 PLACES: ± 0.15 1 PLACE: ± 0 PLACES: ± DRAFT WHERE APPLICABLE MUST REMAIN WITHIN DIMENSIONS	THIS DRAWING CONTAINS INFORMATION THAT IS PROPRIETARY TO MOLEX ELECTRONIC TECHNOLOGIES, LLC AND SHOULD NOT BE USED WITHOUT WRITTEN PERMISSION		CURRENT REV DESC: REVISED KEEP OUT ZONE ON SHEET 2		
	EC NO: 174569 DRWN: TPREMO 2018/04/03 CHK'D: KPELOZA 2018/01/17 APPR: KLANG 2018/04/05		NEOPRESS 6 ROW PLUG ASSY, LOW PROFILE 100 OHM		
INITIAL REVISION: DRWN: GMINNICK 2017/05/04 APPR: KLANG 2017/08/01			PRODUCT CUSTOMER DRAWING		DOCUMENT NUMBER: 1733630002 DOC TYPE: PSD DOC PART: 000 REVISION: C
THIRD ANGLE PROJECTION		DRAWING: E-SIZE SERIES: 173363		MATERIAL NUMBER: SEE TABLE CUSTOMER: GENERAL MARKET SHEET NUMBER: 1 OF 2	

CIRCLED VIAS ARE CONNECTED TO THE SAME SHIELD TERMINAL. ALSO, ALL SHIELD VIAS ARE ELECTRICALLY INTERCONNECTED INSIDE THE CONNECTOR. (SEE CHART FOR EXCEPTIONS FOR POWER TERMINALS*. THE LOW SPEED TRIADS SHIELD TERMINALS MUST BE USED FOR GROUNDS ONLY AND MAY BE CONNECTED TO OTHER SHIELDS IN THIS CONNECTOR EXCEPT THE ELECTRICALLY ISOLATED SHIELDS).

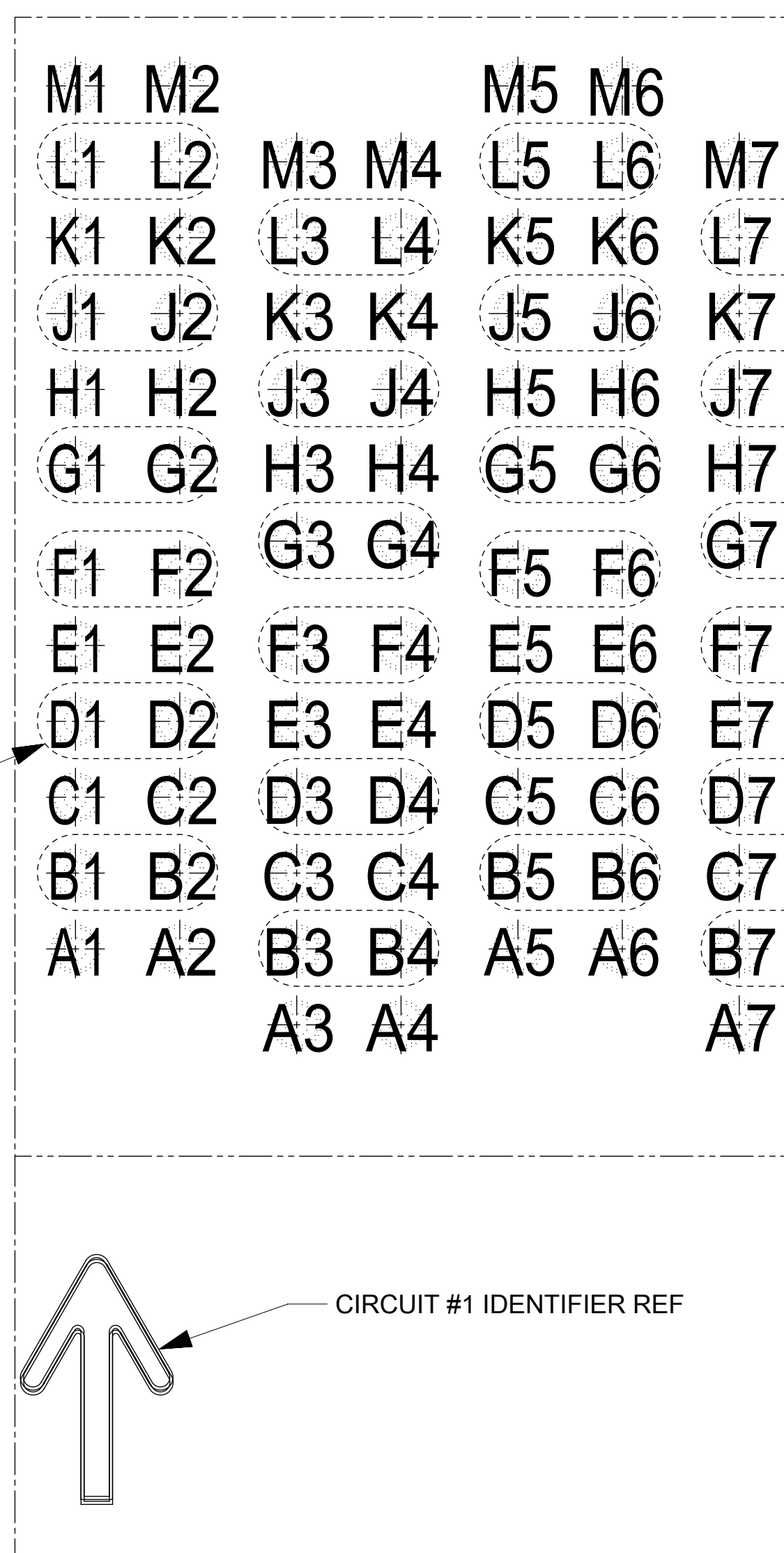

DETAIL A
SCALE 12:1
NUMBERING SCHEME

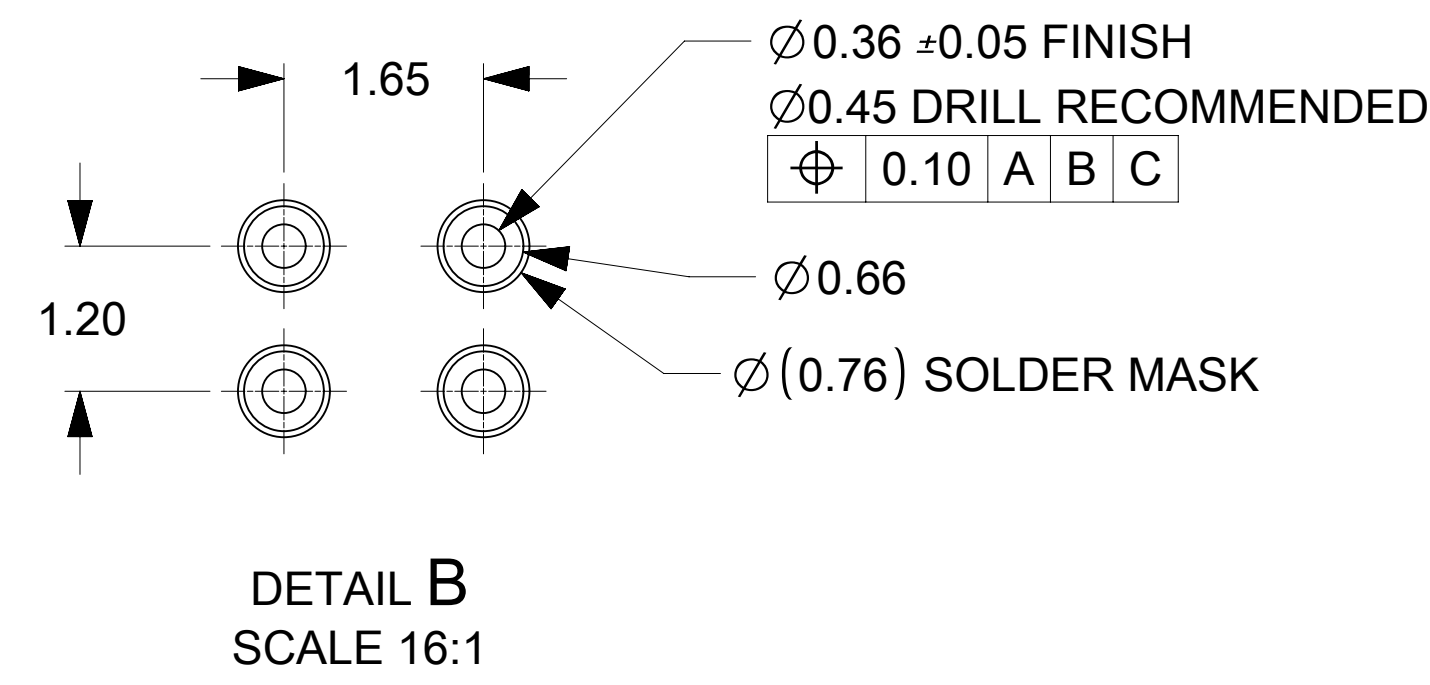

DETAIL B
SCALE 16:1

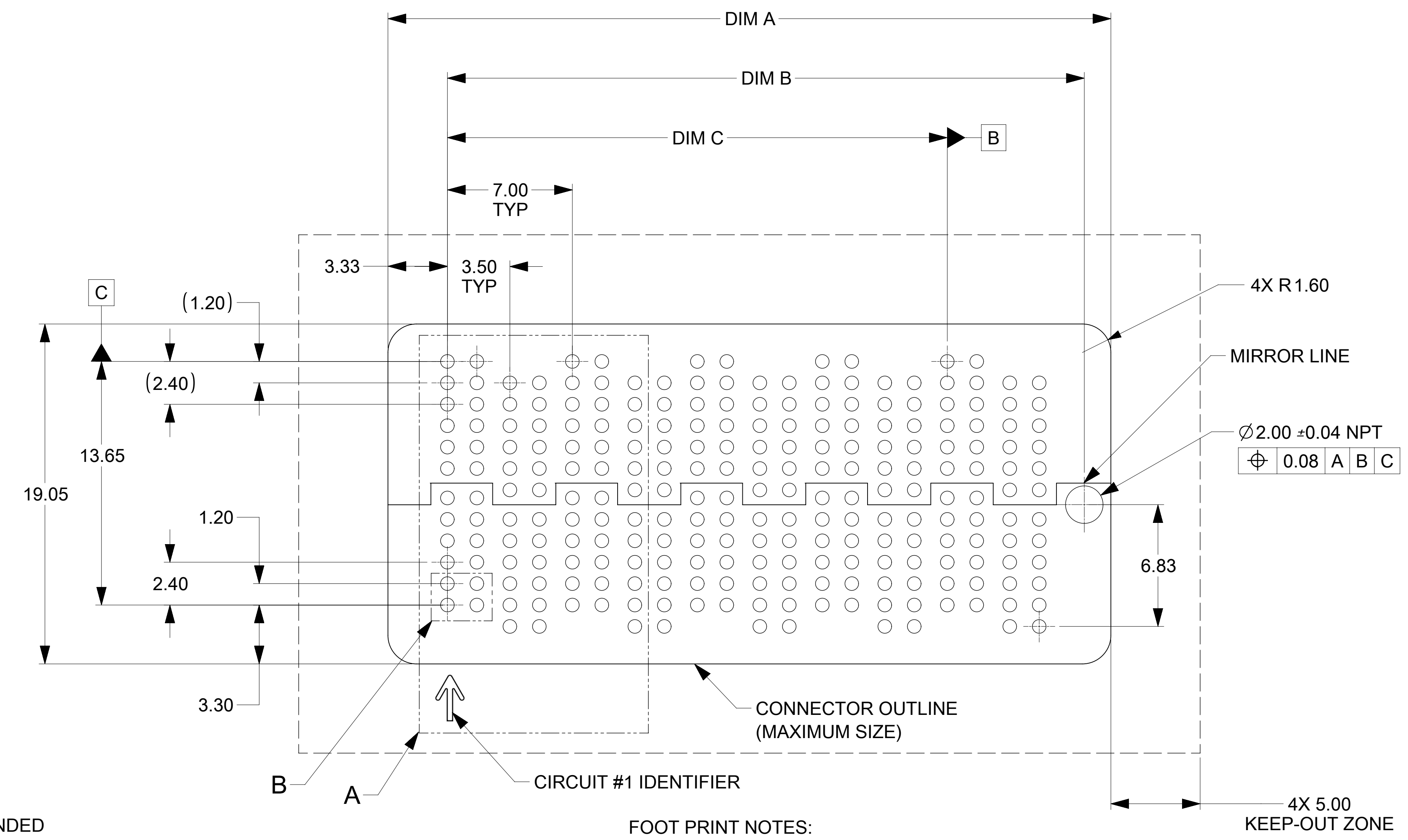

FOOT PRINT NOTES:
1. DATUM -A- IS THE TOP OF THE PCB
2. ALL DIMENSIONS ARE BASIC

FOOT PRINT 6X10 SHOWN

MATERIAL NUMBER	NO. OF COLUMNS	DIM A	DIM B	DIM C	ELECTRICALLY ISOLATED SHIELDS *	LOW SPEED TRIADS *
1733630001	10	39.80	35.68	28.00	N/A	N/A
1733630009	12	46.80	42.68	35.00	N/A	N/A
1728010012	6	25.80	21.68	14.00	N/A	N/A
1728010014	14	53.80	49.68	42.00	N/A	N/A

SYMBOLS DIMENSION UNITS: mm SCALE: 4:1 GENERAL TOLERANCES (UNLESS SPECIFIED) ANGULAR TOL: ± ° 4 PLACES: ± 3 PLACES: ± 2 PLACES: ± 0.15 1 PLACE: ± 0 PLACES: ± DRAFT WHERE APPLICABLE MUST REMAIN WITHIN DIMENSIONS THIRD ANGLE PROJECTION	THIS DRAWING CONTAINS INFORMATION THAT IS PROPRIETARY TO MOLEX ELECTRONIC TECHNOLOGIES, LLC AND SHOULD NOT BE USED WITHOUT WRITTEN PERMISSION		CURRENT REV DESC: SEE SHEET 1			
	EC NO: 174569		2018/04/03			NEOPRESS 6 ROW PLUG ASSY, LOW PROFILE 100 OHM
	DRWN: TPREMO		2018/01/17			
	CHK'D: KPELOZA		2018/04/05		PRODUCT CUSTOMER DRAWING	
	APPR: KLANG		INITIAL REVISION:		DOCUMENT NUMBER	
	DRWN: GMINNICK		2017/05/04		1733630002	
	APPR: KLANG		2017/08/01		DOC TYPE: PSD	
	DRAWING: E-SIZE		SERIES: 173363		DOC PART: 000	
	MATERIAL NUMBER: SEE TABLE		CUSTOMER: GENERAL MARKET		REVISION: C	
	SHEET NUMBER: 2 OF 2					