

REV.	Q'TY	ECN. NO.	APR.	DATE

序号	品名	材质
1	1.0前翻母式下接胶芯(H2.0)	LCP UL94V-0 本色
2	1.0前翻母式下接端子(H2.0)	铜合金/表面镀锡
3	1.0前翻母式下接后盖(H2.0)	LCP UL94V-0 黑色
4	1.0前翻母式下接焊片(H2.0)	铜合金/表面镀锡

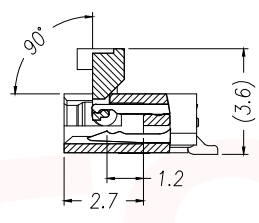

- 技术指标:
1. 塑件表面应光洁、无毛边、无明显收缩、缺陷、裂纹等现象。
 2. 温度范围：-25°C~85°C。
 3. 额定电压：50V，AC/DC(等效)。
 4. 接触电阻：≤0.03Ω。
 5. 绝缘电阻：≥500MΩ。

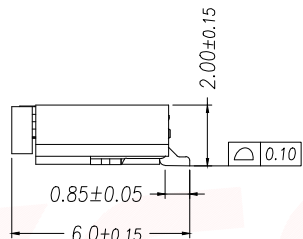
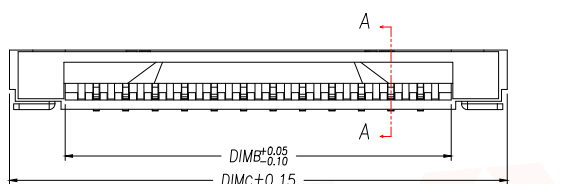
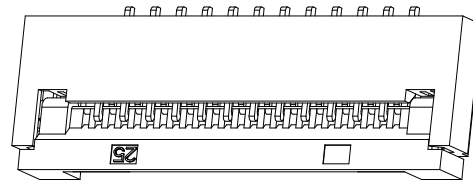
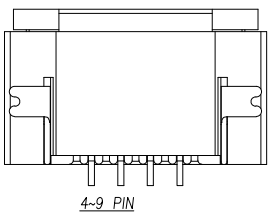
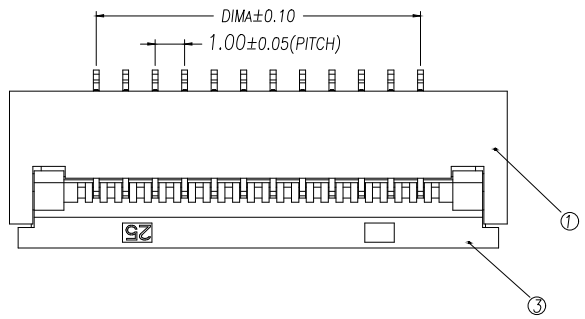
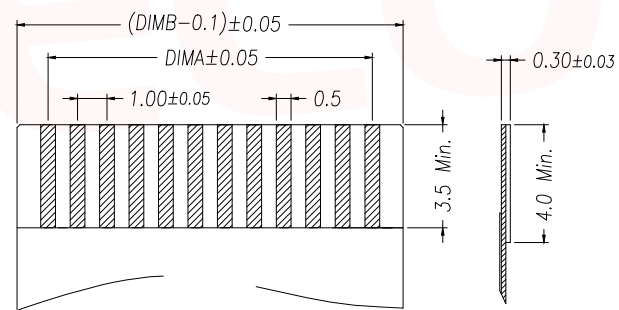
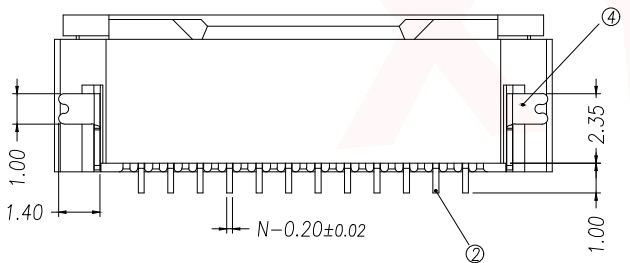

Part No	Pin	DIMA	DIMB	DIMC
FPC09-Q1.0-2AH2.0	2	1.00	3.10	6.90
FPC09-Q1.0-3AH2.0	3	2.00	4.10	7.90
FPC09-Q1.0-4AH2.0	4	3.00	5.10	8.90
FPC09-Q1.0-5AH2.0	5	4.00	6.10	9.90
FPC09-Q1.0-6AH2.0	6	5.00	7.10	10.90
FPC09-Q1.0-7AH2.0	7	6.00	8.10	11.90
FPC09-Q1.0-8AH2.0	8	7.00	9.10	12.90
FPC09-Q1.0-9AH2.0	9	8.00	10.10	13.90
FPC09-Q1.0-10AH2.0	10	9.00	11.10	14.90
.....
FPC09-Q1.0-32AH2.0	32	(32-1)*1.0	(32+1)*1.0+0.10	(32+5)*1.0-0.10

适用扁平线(Applicable Flat Cable)

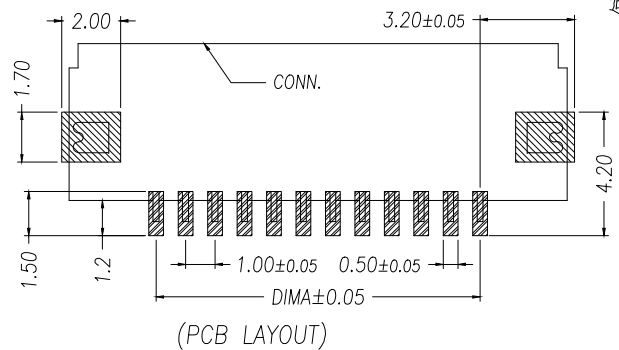

DIMENSION IN mm		厦门市辛译精密电子有限公司 Xiamen XinYi Xyconn Electronics Co.,Ltd			
TOLERANCE UNLESS OTHERWISE SPECIFIED					
.X ± 0.35	X.* ± 5°	APR.	Alex	TITLE: 1.0 Pitch 前翻母式下接 H2.0	
.XX ± 0.25	.X.* ± 3°	CHK.	Jack	DWG NO. FPC09-Q1.0-NAH2.0	
.XXX ± 0.15	.XX.* ± 1°	DRA.	Can	PROJ.	CUSTOMER DRAWING
		SIZE A4	SCALE 1:1	SHEET 1/1	REV. A