

RoHS 2.0

REV.	ECN NO.	DESCRIPTION	DATE	DESIGN
A1.	/.	重新核对图面	21.01.05	LiHui
A2.	/.	HD	22.08.15	LZR

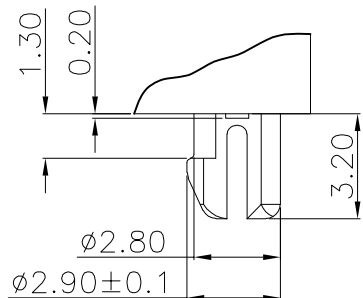
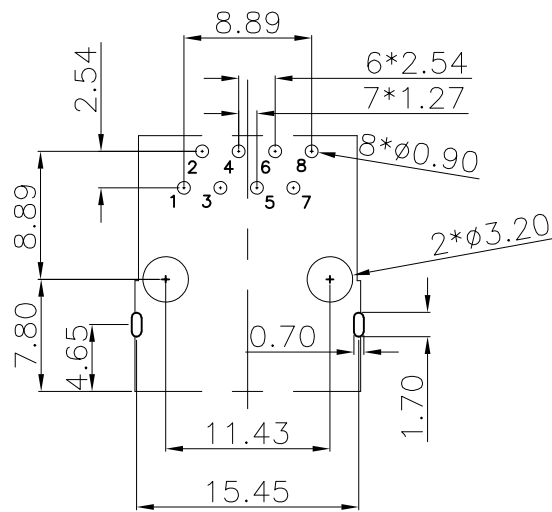
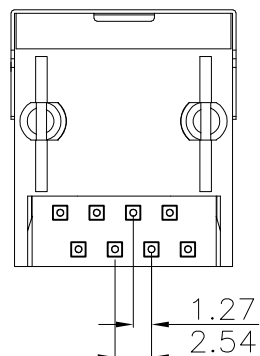
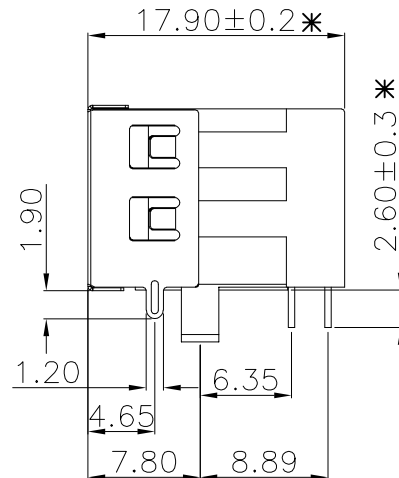
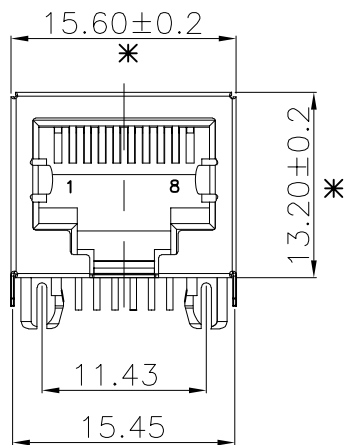

DETAIL "X"  
SCALE 2:1

RECOMMENDED PCB LAYOUT  
TOP VIEW(TOL:±0.05)

NOTES:

- MATERIAL:
  - HOUSING: PBT , COLOR IS BLACK;
  - CONTACT: PHOSPHOR BRONZE,  $\phi 0.46\text{mm}$ ;
  - SHELL: STAINLESS STEEL,  $T=0.20\text{mm}$
- FINISH:
  - CONTACT: PLATED GOLD OVER NI;
  - SHELL: PLATED NI OVER ALL
- RECINNEDDED PCB THICKNESS: 1.2~1.60mm;
- ELECTRICAL:
  - VOLTAGE RATING: 125 VAC RMS;
  - CURRENT RATING: 1.5 AMP;
  - CONTACT RESISTANCE: 35MILLIOHMS MAX.;
  - WITHSTAND VOLTAGE: 1000 VAC RMS 50(60)Hz,1MIN.;
  - INSULATION RESISTANCE: 1000MEGOHMS MIN @500V DC.;
- MECHANICAL:
  - MATING/UNMATING FORCE: 22N MAX.;
  - RETENTION STRENGTH: 50N MIN.;
  - OPERATING LIFE: 750 CYCLES MIN.;
- SALT SPRAY TEST: 12H;
- SOLDERABILITY:  $245\pm 5^{\circ}\text{C}, 5\pm 0.5\text{S}$ ;
- RESISTANCE TO SOLDER:  $260\pm 5^{\circ}\text{C}, 10\pm 1\text{S}$ ;
- ENVIRONMENTAL:
  - STORAGE TEMPERATURE RANGE:  $-40^{\circ}\text{C}\sim +85^{\circ}\text{C}$ ;
  - OPERATION TEMPERATURE RANGE:  $-25^{\circ}\text{C}\sim +70^{\circ}\text{C}$ ;
- THE MARK WITH "\*" IS THE KEY INSPECTION DIMENSION FOR QC.

C	外壳	不锈钢	镀镍	
B	端子	磷铜	镀镍 镀金(G/F)	
A	基座	PBT	黑色	
序号	品名	材质	电镀/颜色	备注

深圳市虹成电子有限公司

UNLESS OTHERWISE GENERAL TOLERANCE: X.xxx ±0.10 X.xx ±0.20 X.x ±0.30	NAME: RJ45-58C-单口(半包短脚)	P/N: HC-WK88-H18-B			
	THIRD ANGLE PROJECTION	UNIT: mm	SCALE: 1:1	SIZE: A4	SHEET: 1/1
ANGULAR: X.xx' ±1' X.x' ±3' X.' ±5'	DRAWN:	CHECKED:	APPROVED		