

THIS DRAWING IS UNPUBLISHED. RELEASED FOR PUBLICATION  
 © COPYRIGHT - By - TE CONNECTIVITY ALL RIGHTS RESERVED.

| LOC | DIST | REVISIONS   |                           |           |       |
|-----|------|-------------|---------------------------|-----------|-------|
| P   | LTR  | DESCRIPTION | DATE                      | DWN       | APVD  |
| CM  | 00   | W           | REVISED PER ECR-20-000814 | 26MAY2020 | PC SW |

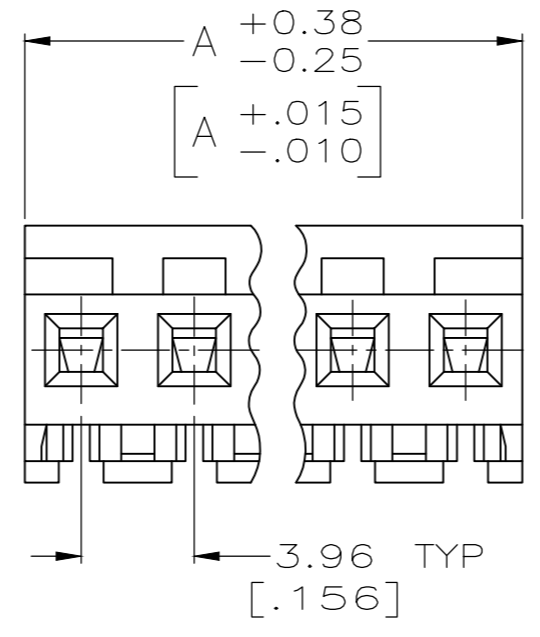
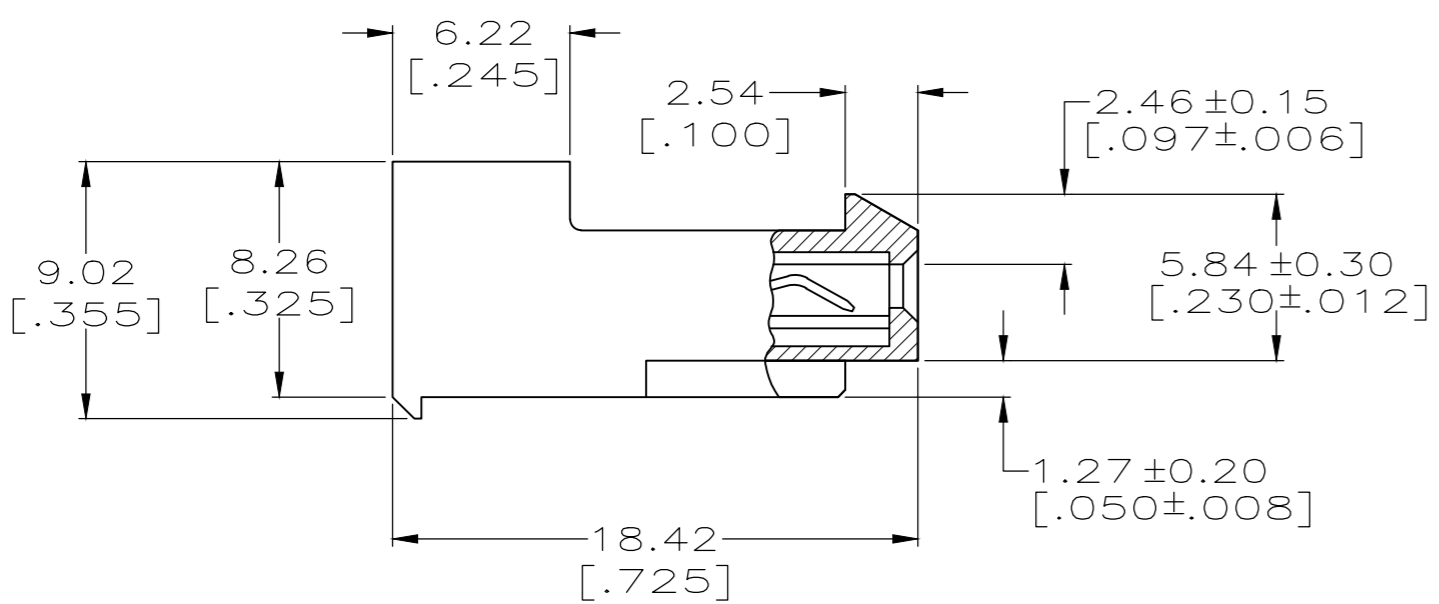
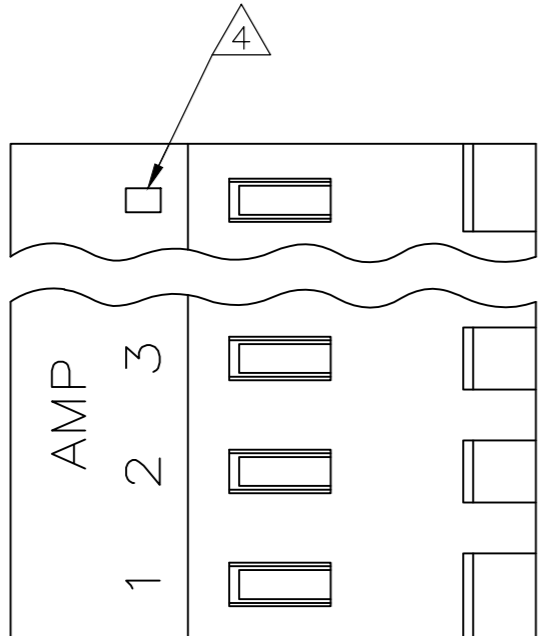

1 MATERIAL: CONNECTOR - NYLON UL94V-2 (ORANGE).  
 CONTACTS - 0.00076[.000030] GOLD THK OR 0.00008[.000003] MIN THK GOLD FLASH OVER 0.00068[.000027] THK PALLADIUM NICKEL, PER TE CONNECTIVITY'S DISCRETION, IN CONTACT AREA WITH MATTE TIN FOR -2 THRU -28, MATTE WHISKER MITIGATED TIN FOR 3-641217-2 THRU 5-641217-4 OVER NICKEL UNDERPLATE.

2 CONTACTS ACCEPT 18 AWG WIRE WITH 2.41[.095] MAX INSULATION DIAMETER.

3 CONTACTS MUST ACCEPT 1.14±0.03[.045±.001] SQUARE POST AND REMAIN LOCKED IN POSITION.

4 IDENTIFICATION NUMBER FOR LAST CIRCUIT MAY NOT APPEAR ON ALL ASSEMBLIES.

5 DIMENSIONS IN BRACKETS ARE IN INCHES.

6 HOUSING FEATURES ARE: CLOSED END WITH LOCKING RAMP.

7 OBSOLETE PARTS: OBSOLETE CIS STREAMLINING PER D.RENAUD/D.SINISI

| YES      | 95.10[3.744] | 24              | 5-641217-4 |
|----------|--------------|-----------------|------------|
| YES      | 91.13[3.588] | 23              | 5-641217-3 |
| YES      | 87.17[3.432] | 22              | 5-641217-2 |
| YES      | 83.21[3.276] | 21              | 5-641217-1 |
| YES      | 79.25[3.120] | 20              | 5-641217-0 |
| YES      | 75.29[2.964] | 19              | 4-641217-9 |
| YES      | 71.32[2.808] | 18              | 4-641217-8 |
| YES      | 67.36[2.652] | 17              | 4-641217-7 |
| YES      | 63.40[2.496] | 16              | 4-641217-6 |
| YES      | 59.44[2.340] | 15              | 4-641217-5 |
| YES      | 55.47[2.184] | 14              | 4-641217-4 |
| YES      | 51.51[2.028] | 13              | 4-641217-3 |
| YES      | 47.55[1.872] | 12              | 4-641217-2 |
| YES      | 43.59[1.716] | 11              | 4-641217-1 |
| YES      | 39.62[1.560] | 10              | 4-641217-0 |
| YES      | 35.66[1.404] | 9               | 3-641217-9 |
| YES      | 31.70[1.248] | 8               | 3-641217-8 |
| YES      | 27.74[1.092] | 7               | 3-641217-7 |
| YES      | 23.77[.936]  | 6               | 3-641217-6 |
| YES      | 19.81[.780]  | 5               | 3-641217-5 |
| YES      | 15.85[.624]  | 4               | 3-641217-4 |
| YES      | 11.89[.468]  | 3               | 3-641217-3 |
| YES      | 7.92[.312]   | 2               | 3-641217-2 |
| NO       | 95.10[3.744] | 24              | 2-641217-4 |
| NO       | 91.13[3.588] | 23              | 2-641217-3 |
| NO       | 87.17[3.432] | 22              | 2-641217-2 |
| NO       | 83.21[3.276] | 21              | 2-641217-1 |
| NO       | 79.25[3.120] | 20              | 2-641217-0 |
| NO       | 75.29[2.964] | 19              | 1-641217-9 |
| NO       | 71.32[2.808] | 18              | 1-641217-8 |
| NO       | 67.36[2.652] | 17              | 1-641217-7 |
| NO       | 63.40[2.496] | 16              | 1-641217-6 |
| NO       | 59.44[2.340] | 15              | 1-641217-5 |
| NO       | 55.47[2.184] | 14              | 1-641217-4 |
| NO       | 51.51[2.028] | 13              | 1-641217-3 |
| NO       | 47.55[1.872] | 12              | 1-641217-2 |
| NO       | 43.59[1.716] | 11              | 1-641217-1 |
| NO       | 39.62[1.560] | 10              | 1-641217-0 |
| NO       | 35.66[1.404] | 9               | 641217-9   |
| NO       | 31.70[1.248] | 8               | 641217-8   |
| NO       | 27.74[1.092] | 7               | 641217-7   |
| NO       | 23.77[.936]  | 6               | 641217-6   |
| NO       | 19.81[.780]  | 5               | 641217-5   |
| NO       | 15.85[.624]  | 4               | 641217-4   |
| NO       | 11.89[.468]  | 3               | 641217-3   |
| NO       | 7.92[.312]   | 2               | 641217-2   |
| LEADFREE | DIM A        | NO. OF CIRCUITS | PART NO.   |

|   |                          |    |              |    |            |
|---|--------------------------|----|--------------|----|------------|
| 7 | SUPERCEDED BY 5-641217-4 | NO | 95.10[3.744] | 24 | 2-641217-4 |
| 7 | SUPERCEDED BY 5-641217-3 | NO | 91.13[3.588] | 23 | 2-641217-3 |
| 7 | SUPERCEDED BY 5-641217-2 | NO | 87.17[3.432] | 22 | 2-641217-2 |
| 7 | SUPERCEDED BY 5-641217-1 | NO | 83.21[3.276] | 21 | 2-641217-1 |
| 7 | SUPERCEDED BY 5-641217-0 | NO | 79.25[3.120] | 20 | 2-641217-0 |
| 7 | SUPERCEDED BY 4-641217-9 | NO | 75.29[2.964] | 19 | 1-641217-9 |
| 7 | SUPERCEDED BY 4-641217-8 | NO | 71.32[2.808] | 18 | 1-641217-8 |
| 7 | SUPERCEDED BY 4-641217-7 | NO | 67.36[2.652] | 17 | 1-641217-7 |
| 7 | SUPERCEDED BY 4-641217-6 | NO | 63.40[2.496] | 16 | 1-641217-6 |
| 7 | SUPERCEDED BY 4-641217-5 | NO | 59.44[2.340] | 15 | 1-641217-5 |

THIS DRAWING IS A CONTROLLED DOCUMENT. DWN 15MAR2004  
 K. WHITAKER  
 CHK 15-MAR-04  
 D. BOSSI  
 APVD 15-MAR-04  
 D. BOSSI  
 PRODUCT SPEC  
 108-1051  
 APPLICATION SPEC  
 114-1020  
 MATERIAL 1  
 FINISH 1  
 CUSTOMER DRAWING

TE Connectivity  
 MTA-156 CONNECTOR ASSEMBLY,  
 18 AWG STANDARD

SIZE A2 CAGE CODE 00779 DRAWING NO. C=641217 RESTRICTED TO -  
 SCALE 1:1 SHEET 1 OF 1 REV W