

APPROVED: \_\_\_\_\_  
 DATE: \_\_\_\_\_ TITLE: \_\_\_\_\_

Rev	AWO #	Description	Date	Appr
-		RELEASED	1/10/09	
A		REVISED DIM.	7/07/10	
B		REVISED SPEC.	05/15/12	

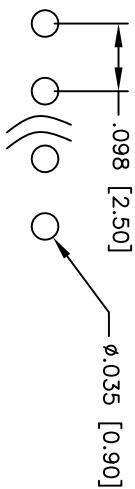

Recommended PCB Layout

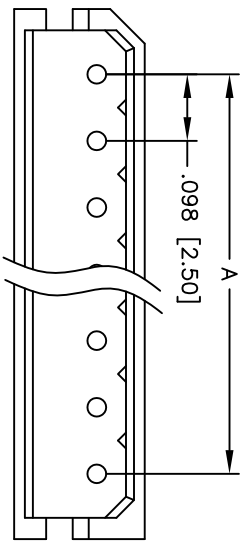
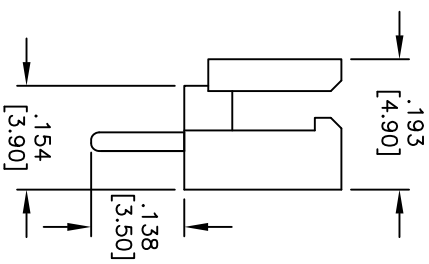
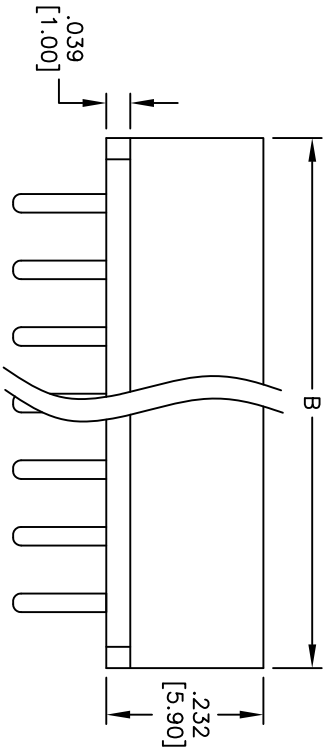

**SPECIFICATIONS:**

Material:  
 Insulator: Nylon66, rated UL 94V-0  
 Insulator color: Beige  
 Contacts: Brass  
 Plating:  
 Tin over copper underplate overall.  
 Electrical:  
 Operating voltage: 250 VAC max  
 Current rating: 3 Amps max  
 Contact resistance: 20 mohms max  
 Dielectric withstanding voltage: 1000 VAC for 1 minute  
 Mechanical:  
 Temperature Rating:  
 Operating temperature: -40°C to +105°C  
 Environmental:  
 Lead free, RoHS compliant

Positions: 02 thru 20  
 A = .098 [2.50] x No. of Spaces  
 B = .098 [2.50] x No. of Spaces + .197 [5.00]

UNLESS OTHERWISE SPECIFIED  
 ALL DIMENSIONS ARE INCHES [MM]  
 TOLERANCES: EXCEPT AS NOTED  
 INCHES HOLE SIZES  
 .X ±.10 ØXX ±.10  
 .XX ±.020 ØXXX ±.015  
 .XXX ±.015 ØXXXX ±.010  
 APPROVALS: \_\_\_\_\_ DATE \_\_\_\_\_

**ADAM TECH**  
 909 Rahway Avenue, Union, NJ 07083  
 Phone: 908-687-5000 Fax: 908-687-5710  
 .098 [2.50] PITCH WAFER, STRAIGHT PCB  
 LOW PROFILE

DRAWN	DY	1/10/09	SIZE	PART NO.	REV.
CHECKED			X	25SH-E-XX-TS	B
APPROVED			REF:	S00723T	
			SCALE:	NTS	SHEET 1 OF 1

