

This document contains proprietary information and such information may not be disclosed to others for any purposes, not used for sales/marketing/procurement purposes without written permission

REV	DESCRIPTION OF REVISION	ECN NO.	BY	DATE	APPROVED
A	Initial Release	—	H.wei	12/7/13	12/7/13

- 1 Electrical
  - 1.1 Impedance 50  $\Omega$
  - 1.2 Frequency 0~18GHz
  - 1.3 VSWR 1.30:1
- 2 Environmental&Mechanical
  - 2.1 Temperature range -45 $^{\circ}$ C~125 $^{\circ}$ C
  - 2.2 RoHs Compliant
  - 2.3 Durability >500 cycles
- 3 Materials&plating
  - 3.1 Body: Brass, Gold Plated
  - 3.2 Insulator: Teflon
  - 3.3 Contact Pin: Brass, Gold Plated
  - 3.4 Nut : Stainless Steel Passivated

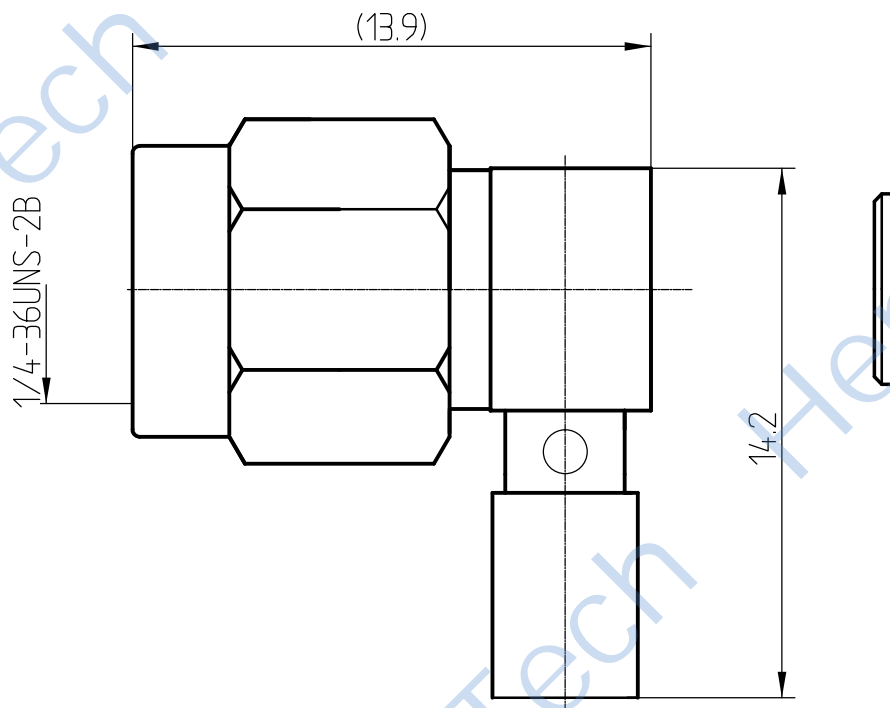

Tel:Lee +86-28-85589664  
Web:www.hltchips.com

Notes:

- 1. ALL SPECIFICATIONS ARE SUBJECT TO CHANGE NOTICE AT ANY TIME
- 2. CUSTOMER OUTLINE DRAWING FOR REFERENCE ONLY

<p>DRAWN: H.wei 12/07/13</p> <p>ENGINEER: L.yu 12/07/13</p> <p>APPROVED: W.yi 12/07/13</p> <p>TOLERANCES UNLESS OTHERWISE SPECIFIED</p> <p>X <math>\pm 0.50</math></p> <p>X <math>\pm 0.20</math></p> <p>.XX <math>\pm 0.10</math></p> <p>ANGLES <math>\pm 1^{\circ}</math></p>	<p>TITLE:</p> <p>RF Coaxial Connector</p> <p>SMA Male R/A Conn. For .086 Cable</p>	
<p>SIZE: A4</p> <p>SCALE: N/A</p> <p>SHEET: 1/1</p> <p>REV: A</p>	<p>PART NO: HL-SMA-JWB2CG</p>	