

Technical Data

Material:

Pin(outer sleeve): Brass,machined CuZn38Pb2
 Plating(outer sleeve):
 Tin plated:2um/80u"Ni, 5um/200u"Sn
 Gold Plated:2um/80u"Ni,Full gold
 Insulator(black): Glass filled thermoplastic polyester
 UL94V-0



Electrical:

Current rating: 3Amps/contact max.

Contact resistance: $\leq 4m\Omega$ /contact

Insulation resistance: $\geq 1000M\Omega$ at V=100V

Operating voltage: 60VAC/DC

Mechanical:

Operating temperatures: Gold Plated:-55°C to+125°C

Tin plated:-40°C to+105°C

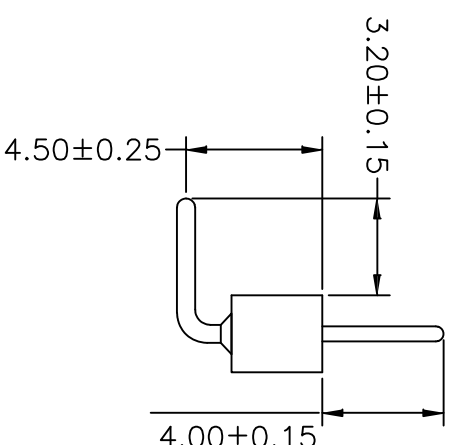
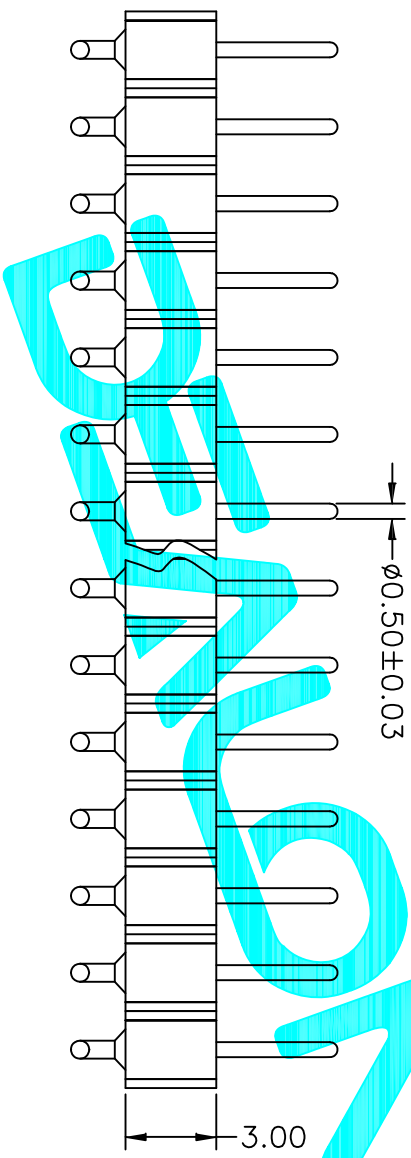
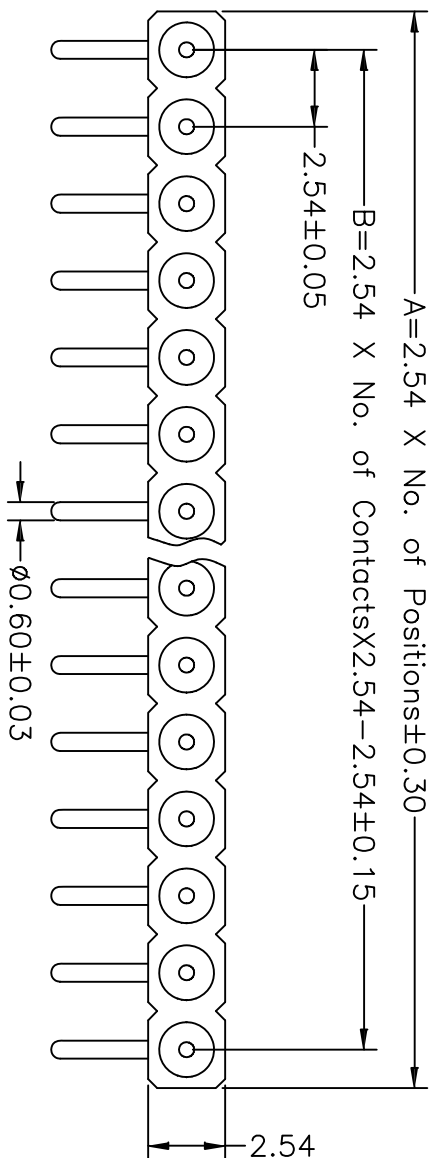

APPROVALS		DATE	TITLE:	
DRAWN	G.M.Chen	2015/7/17	Connector	
CHECKED			ELECTRONICS CO.,LTD	
APPROVALS				

ECN NO.	REV.	DATE.	DESCRIPTION.	CHANGE.	CHECK.	APPRO.	TOLERANCES ARE	ANGLE	PART NO.	SCALE:	SHEET	PROJ.
	A		NEW				30 ^{±0.15}	±2°	MZ254W-11-XX-12	1:1	1 OF 1	
							10 ^{±0.20}					
							5 ^{±0.10}					

