

6

5

4

3

2

1

APPROVED: _____

DATE: _____ TITLE: _____

Rev	AWO #	Description	Date	Appr
-		RELEASED	9/8/11	
A		REVISED SPEC	12/8/11	

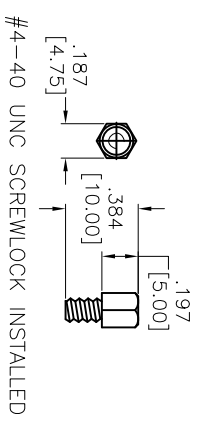
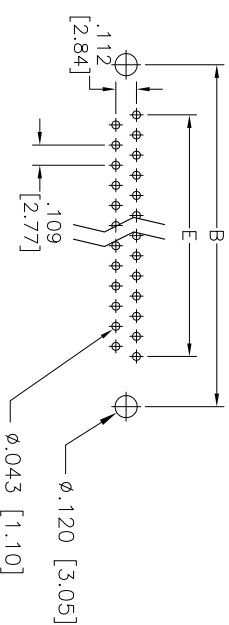
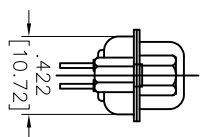
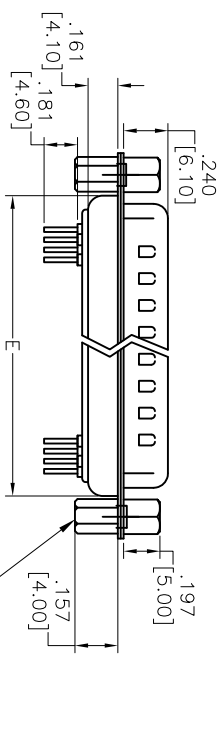
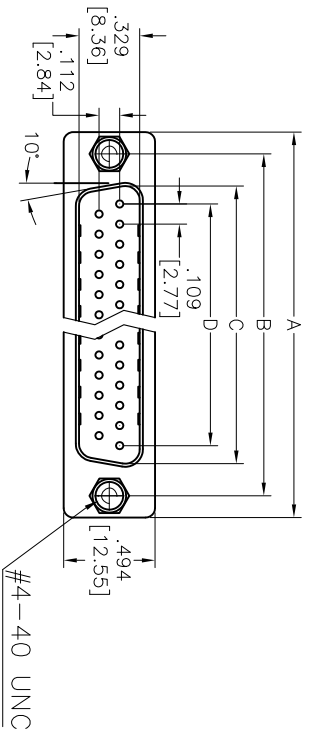

SPECIFICATIONS:

- Material: Insulator: PBT, Thermoplastic, glass filled, rated UL 94V-0
- Insulator color: Black
- Contacts: Copper alloy
- Shell: Steel, Tin plated
- Nut: Brass, Nickel plated
- Screwlock: Brass, Nickel plated
- Plating: Gold flash over Nickel underplate overall
- Electrical: Operating voltage: 250 VAC max. Current rating: 1 Amp max. Contact resistance: 20 mohms max. Insulation resistance: 1,000 Mohms min. @DC 500V Dielectric withstanding voltage: 1,000 VAC for 1 minute
- Temperature Rating: Operating temperature: -55°C to +105°C
- Environmental: Lead free, RoHS compliant.

DXXX NO. OF CONTACTS	DIMENSIONS				
	A	B	C	D	E
DE09 9	1.213 [30.81]	.984 [24.99]	.666 [16.92]	.436 [11.08]	.756 [19.20]
DA15 15	1.543 [39.20]	1.311 [33.30]	.994 [25.25]	.763 [19.39]	1.091 [27.70]
DB25 25	2.088 [53.04]	1.852 [47.04]	1.534 [38.96]	1.309 [33.24]	1.618 [41.10]
DC37 37	2.732 [69.40]	2.500 [63.50]	2.182 [55.42]	1.963 [49.86]	2.256 [57.30]

ADAM TECH

909 Rahway Avenue, Union, NJ 07083
 Phone: 908-687-5000 Fax: 908-687-5710

D-SUBMINIATURE PLUG, STRAIGHT PCB TAIL

UNLESS OTHERWISE SPECIFIED ALL DIMENSIONS ARE INCHES [MM]		TITLE	
TOLERANCES: EXCEPT AS NOTED INCHES HOLE SIZES		D-SUBMINIATURE PLUG, STRAIGHT PCB TAIL	
.X ± .10	ØX ± .10	SIZE	PART NO.
.XX ± .020	ØXX ± .015	X	DXXX-PT-1-SL-US
.XXX ± .015	ØXXX ± .010	REF:	S00087T
APPROVALS	DATE	SCALE:	NTS
DRAWN TW	9/8/11	SHEET	1 OF 1
CHECKED AY	9/8/11	REV:	A
APPROVED			

6

5

4

3

2

1