

NOTES:

- 1.RATING: 5A125/250VAC.
- 2.OPERATING FORCE: 250±100gf \triangle
- 3.CONTACT RESISTANCE: <50m Ω
- 4.INSULATION RESISTANCE: >100M Ω (500VDC BETWEEN OPEN CONTACTS)
- 5.DIELECTRIC STRENGTH: >1500Vac 0.5mA 1 MINUTE
- 6.COLOR: BLACK

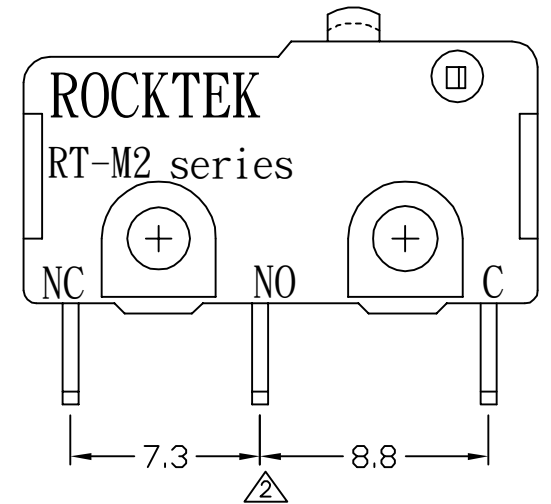
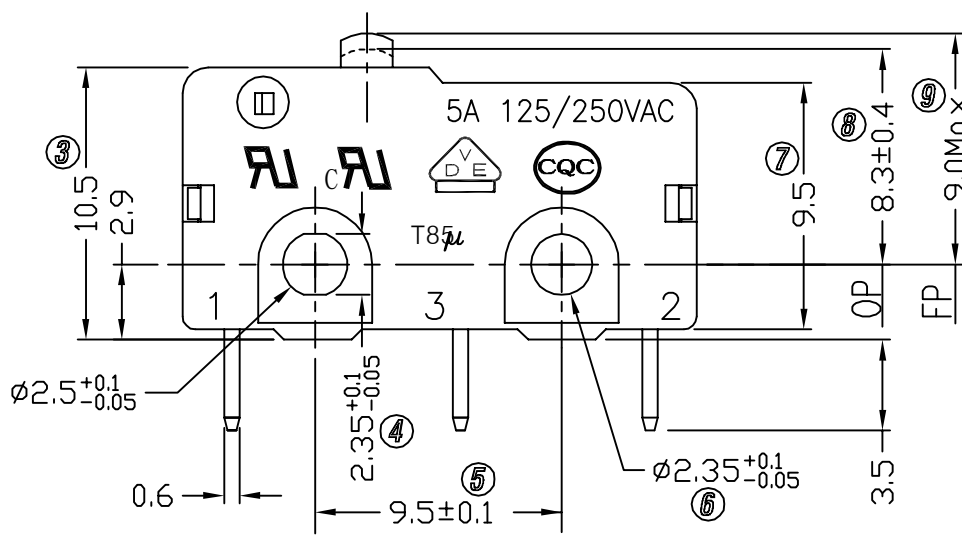
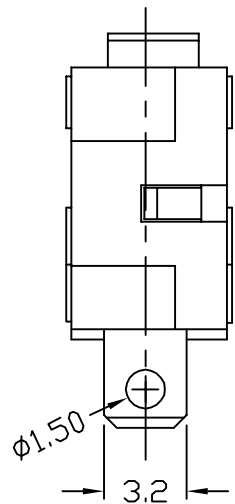

5	→	10	→	DIMENSIONAL TOLERANCES		APPROVED	CHECKED	DESIGN	DRAWN	ALL SIZE ARE IN	MM	
4	→	9	→	RANGE	TOLERANCE			LMC	simon	SCALE	FIT	
3	→	8	→	X	±0.4			2017.01.03		MAT'L	***	
2	增加端子间距尺寸 2020.12.30	7	→	X.X	±0.3	ROCK TEK ELECTRICAL(SHENZHEN) CO.,LTD.				MATERIAL NO.	DRAWING NO.	REV
1	200±30 → 250±100	6	→	X.XX	±0.2					RTM2-0C4S05A200	WIF113007	A2
NO	DESCRIPTION	NO	DESCRIPTION	ANGLES	±0.5°							