

REV	DESCRIPTION	DATE
-----	-------------	------

△ RDK-109019

郭增敏 2020/04/24

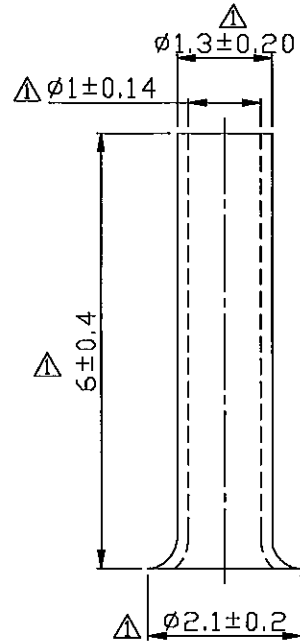

- NOTE :
- △1. MAXIMUM ELECTRIC CURRENT : 

A.W.G.	20		
AMP.	12		
  - △2. WIRE RANGE : 20 A.W.G. (  $0.50 \text{ mm}^2$  )
  - 3. SURFACE TREATMENT : TIN PLATED

Tolerance Unless Otherwise Specified	
0 > 6 mm $\pm 0.20$	ANGLE
6 > 18 mm $\pm 0.30$	0° REF $\pm$
18 > 30 mm $\pm 0.40$	° $\pm$
30 > 75 mm $\pm 0.50$	° $\pm$

NAME	NON-INSULATED CORD END TERMINALS			UNIT	mm	
PART NO.	EN0506	MATERIAL	COPPER TUBE.	APPROVE		
NUMBER	KT-96067-C	SCALE	REV. SHEET	CHECKED		
DATE	2007/04/11	10/1	1-1	10F1	DRAWN	張馨尹

**KST. K.S. TERMINALS INC.**