

特征 Features

1-7瓦	1-7watts
精度±5%, ±2%和±1%	Tolerance ±5%,±2% and ±1%
电阻温度系数低至±40ppm/°C	TCR down to ±40ppm/°C
可靠性强	Excellent stability
可焊性好	Excellent solderability
符合RoHS、REACH要求	RoHS and REACH compliant
特殊规格可以订做	Customizable



应用范围 Applications

电流采样	Current Sensing
驱动技术	Drive technology
家用电器	Household Electric Appliances
变频器	Frequency converter
电源产品	Power supply products

标准尺寸规格 Standard Size

C/mm	W/mm	H/mm	A/mm	L/mm	T/mm
2.4~3.5	10~30	7.5~30	3.5±0.5	1.0±0.1	1.5±0.2

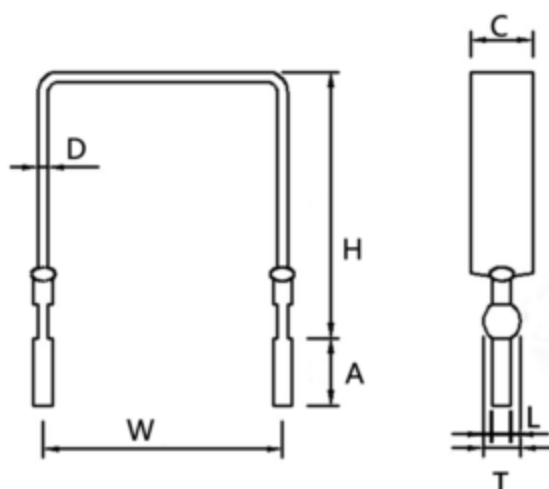

订货请提供:
1.跨距 "W"
2.高度范围 "H"
3.额定电流或额定功率高度范围

NOTE:
Contact YeZhan for:
1.Variations of "W"
2.Variations of "H"
3. Rated current or rated power

焊脚型采样电阻 (HSR) 线厚宽、跨距及可选阻值 (mΩ) 对照表Type Data

线厚宽 /mm	过电流 /A	跨距及对应阻值范围 (mΩ)					材料 Material	TCR /ppm/°C
		10	15	20	25	30		
1.3×3.5	30	2.5~7	2.8~7.6	3.6~8.4	4~8.8	4.4~9	Constantan	±40
1.3×3.5	28	7~19	7.8~21	10~23	11~24	12~25	Karma	±40
1.1×3.3	30	2~5.5	2.5~6	3~6.5	3.5~7	4~7.5	Copper-Nickel	±200
	25.5	8.5~25	10~25	12~28	13~29	16~31	Karma	±40
	28	3~9	3.5~10	4.5~10	5~11	5.5~11	Constantan	±40
1.1×2.8	25.5	2.4~6.5	3~7	3.5~7.7	4.2~8.2	4.8~8.8	Copper-Nickel	±200
1.0×4	33	2~5	2.3~5.5	2.8~6	3.2~6.5	3.7~7	Copper-Nickel	±200
0.9×4	28	3.3~9.5	4~10	5~10	5.5~11	6.5~12	Constantan	±40
0.9×2.7	19	5~14	6~15	7.5~15	8.5~16	10~17.5	Constantan	±40
0.85×2.4	15	5~16	6~17	7.5~18	9~19	10~20	Constantan	±40
0.8×3.3	20	4~12	5~13	6~14	7~15	8~16	Constantan	±40
0.8×3.3	19	11~33	13~35	17~38	19~40	22~44	Karma	±40
0.8×3	19	4.5~13	5.5~14	6.6~15	7.7~16	8.8~17	Constantan	±40
0.8×2.4	15	6~17	7.5~18	9~20	11~21	12~22	Constantan	±40
0.8×2	11	19~55	22~58	28~64	31~66	37~69	Karma	±40
0.7×6	32	3.5~6.8	3.5~7.7	4.3~8.5	4.3~8.5	5~9.5	Constantan	±40
0.6×6	28	4~8	4~9	5~10	5~10	6~11	Constantan	±40
0.6×5	21	11~29	13~30	15~33	16~34	20~37	Karma	±40
0.6×2.4	11.5	9~22	10~24	12~25	13~26	15~28	Constantan	±40
0.6×2.4	10	26~60	29~66	34~69	37~71	42~77	Karma	±40
0.5×6	23.5	3.5~10	4.4~11	5.3~12	6.2~13	7~14	Constantan	±40
0.5×3.5	13.5	6~18	7.5~19	9~20.5	11~22	12~24	Constantan	±40
0.5×3.3	13	6~20	8~22	9~23	11~24	12~26	Constantan	±40
0.5×3.3	11	14~44	16~47	20~50	23~53	27~58	NiCr	±120
0.5×3	12	9~22	10~24	11~25	13~26	14~28	Constantan	±40
0.4×3.3	10	8~25	10~27	12~29	14~31	16~33	Constantan	±40
0.4×3.3	9	21~56	25~60	29~65	33~69	38~74	NiCr	±120
0.4×3	9.5	10~27	13~29	14~31	16~34	19~36	Constantan	±40
0.4×3	8.5	23~60	30~65	32~69	36~76	43~81	NiCr	±120
0.4×2.4	7.5	13~35	15~37.5	17.5~40	20~42	23~45	Constantan	±40
0.4×2.4	7	29~78	34~84	40~90	45~95	51~101	NiCr	±120
0.36×2.4	6	28~80	33~87	40~94	48~100	55~107	NiCr	±120
0.3×6	14	5~24	7~25	8~26	9~28	11~29	Constantan	±40
0.3×4	9	8~36	10~38	12~40	14~43	16~44	Constantan	±40
0.3×3.5	8.5	9~41	11~43	13~45	16~48	18~50	Constantan	±40
0.3×3.3	8	9~43	12~46	14~48	16~50	19~53	Constantan	±40
0.3×3.3	7	25~120	32~126	39~134	45~140	52~147	Karma	±40
0.3×3	7	10~45	13~50	15~53	18~56	21~58	Constantan	±40

订购信息 Ordering Information

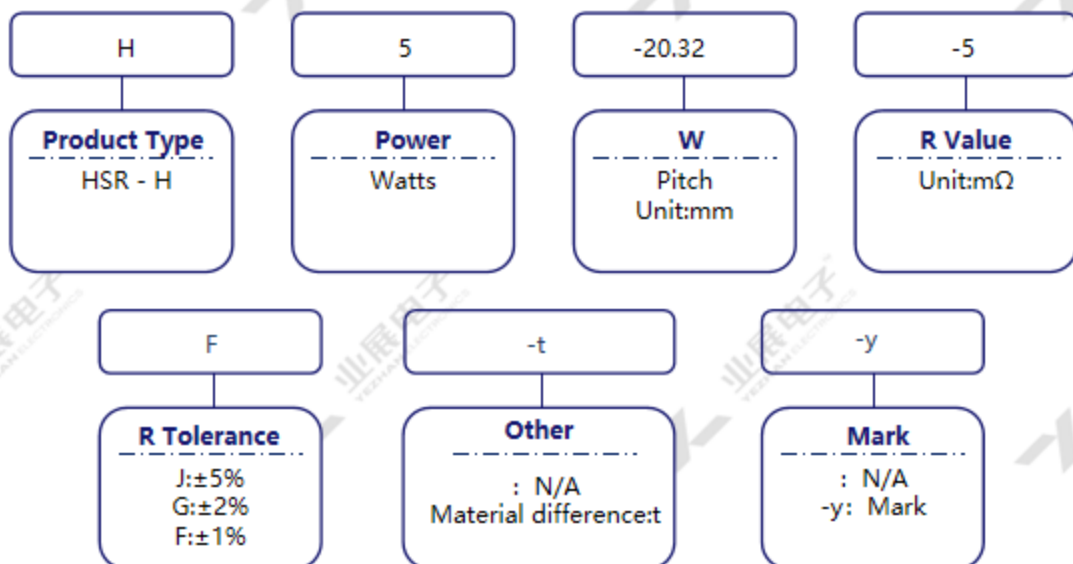

代号 Symbol	材料 Materials	电阻率 Resistance Rate
1	康铜 Constantan	48μΩ. cm
n	镍铬 NiCr	108μΩ. cm
6	铜镍 Copper-Nickel	30μΩ. cm
K	卡玛 Karma	133μΩ. cm

工作特性 Performance Data

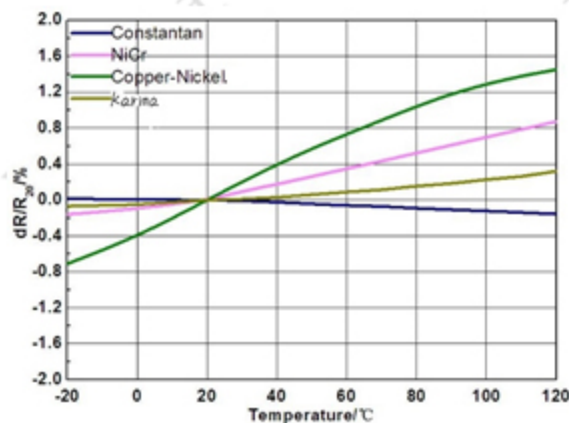
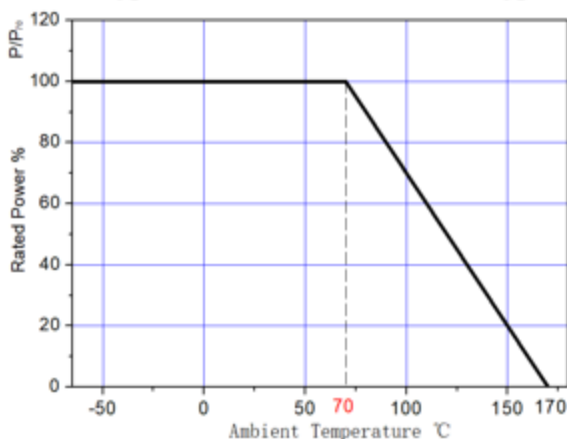

TCR (ppm/°C) : Test conditions at 20°C~120°C.

» 产品尺寸和性能 Product Size And Performance

项目 Items	参数 Parameters
材料 Material	康铜 Constantan/镀锡铜 Tinned Copper
图解 Diagrammatize	<p>The diagram shows a U-shaped resistor with a vertical lead on the right. Dimension A is the height of the base. H is the total height of the U-shape. W is the width of the base. D is the diameter of the U-shape. C is the diameter of the vertical lead. L is the length of the lead. T is the thickness of the lead. A 'Test point' is marked on the lead.</p>
A	3.5 mm±0.5mm
H	17mm±2.0mm
W	20.32 mm±0.5mm
C	3.5 mm±0.2mm
D	1.3mm±0.1mm
L	1.0 mm±0.1mm
T	1.5~ 1.7mm
阻值 resistance value	5mΩ±1%
额定功率 Rated power	5W
印字 Mark	R005F
使用温度 Operating temperature	-65°C ~ 170°C

» 耐久性测试 Endurance Test

Items	Additional Requirements	Reference	Limits
Operational Life	70±2°C, 1000h Rated voltage (90 min ON, 30 min OFF)	MIL-STD-202 Method 108	±1%
Biased Humidity	1000hrs 85°C/85%RH. Note:Specified conditions:10% of operating power.	MIL-STD-202 Method 103	±1%
Temperature Cycling	1000 Cycles(-55°C to +125°C)	JESD22 Method JA-104	±1%
Solderability	245°C±5°C,5s±0.5s	J-STD-002C	95% Coverage Minimum
Short Time Overload	5×Rated power for 5 s	MIL-STD-202 Method 301	±1%
Resistance to Soldering Heat	260°C±5°C, 10s±1s	MIL-STD-202 Method 210	±0.5%
Vibration	(10 - 2000 Hz) ,5 g's for 20 min, 12 cycles each of 3axis.	MIL-STD-202 Method 204	±0.5%
Terminal strength	> 13kg		±1%

» 包装 Packaging

散装, 内外双包装 Bulk, Internal And External Package

» 版本信息 Version History

版本 Version	日期 Date	修订描述 Description of amendment	拟定 Draft	审核 Checked
A1.0	21-Sep-2022	首版发行	张雅兰	胡紫阳