

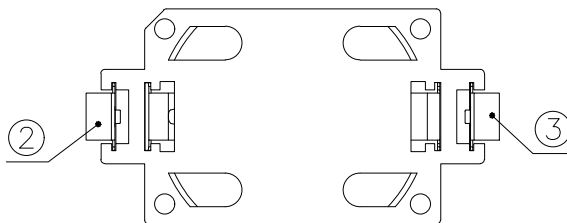

MAPX	MODIFICATION	DATE	DRAW	APPROVE

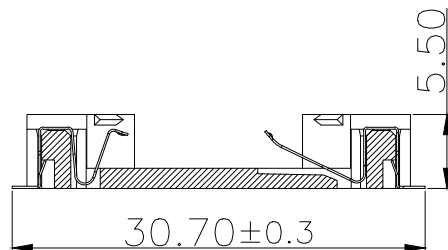

- 1.MATERIAL:
a.HOUSING:LCP
b.CONTACT:PHOSPHOR BRONZE
(SURFACE PLATING: Au1u")
- 2.ELECTRIC:
a.CONTACT RESISTANCE: 30 MILLIOHMS
MAX
b.INSULATION RESISTANCE: 100 MEGA
OHMS MIN
c.DIELECTNIC VOLTAGE: 500V AC ONE SEC
LEVEL
d.OPERATING TEMPERATURE: -25°C~
+85°C

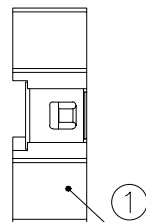
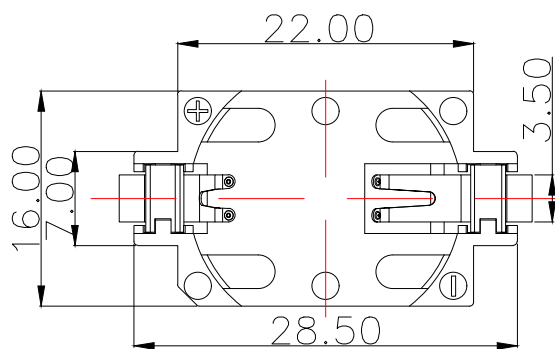
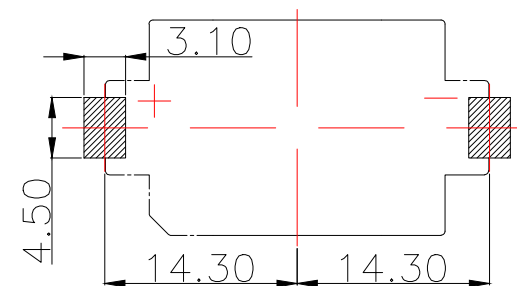

PCB Layout Diagram
Top View

3	TERMINAL(-)	1	PHOSPHOR BRONZE, T=0.15mm	Gold Plating and Ni Under-Plating
2	TERMINAL(+)	1	PHOSPHOR BRONZE, T=0.15mm	Gold Plating and Ni Under-Plating
1	HOUSING	1	LCP	WHITE
NO.	PART NAME	Q'TY	MATERIAL	PLATING & COLOR

MANUFACTURE DWG		东莞市讯普电子科技有限公司 DongGuan XunPu Electronics Co.,Ltd	
UNLESS OTHERWISE SPECIFIED TOLERANCES			TITLE: Au SMT 短脚
DECIMALS:	ANGLES:		PAR BS-0603-SA-4W
X.X±0.30	X.*±5°		DWN
X.XX±0.25	X.X*±1°		CHKD
X.XXX±0.15		APVD	SCALE N:A UNIT:MM
CUSTOMER COPY		SIZE:A4	SHEET:1F1 REV:A

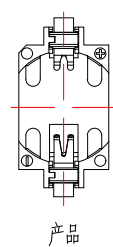

产品

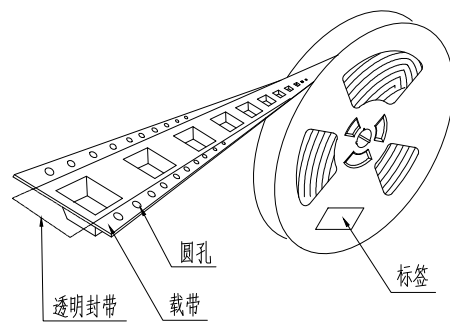

透明封带 载带 圆孔 标签

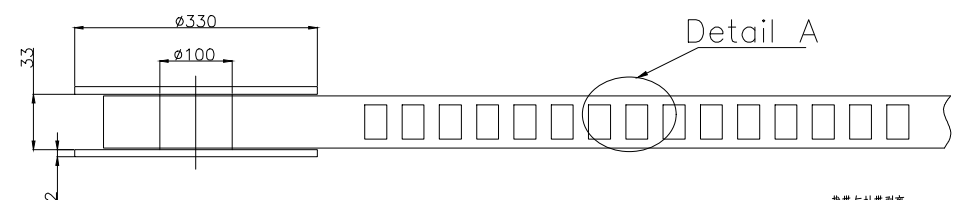

Detail A

载带与封带剥离
 剥离角度: 165°-180°
 剥离速度: 0.1-1.0N (300mm/min)
 余留封带长: 300 MIN
 剥离方向

出料方向



末端留空载带

前端留空载带

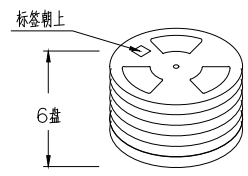

标签朝上

6盘

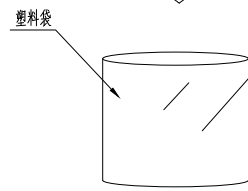

塑料袋

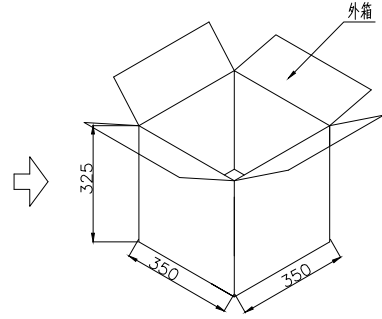

外箱

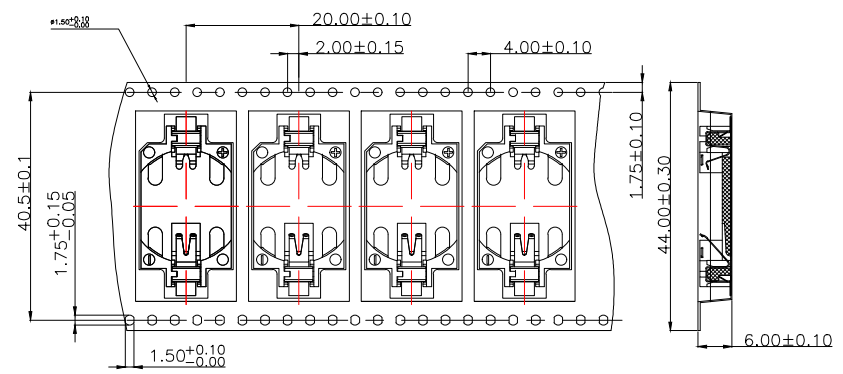
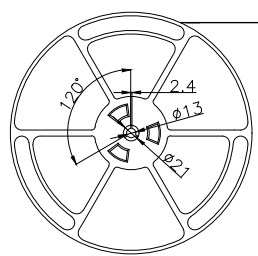
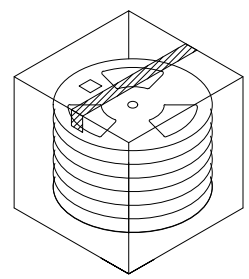

Detail A

技术要求:

1. 圆孔十个孔距离累计允许公差为±0.2mm
2. 带长250mm内容许弯曲度1mm
3. 材料厚度以在载带边缘测量为准
4. 所有尺寸定义依循EIA-481-C系准则定义之
5. 材料: 黑色PS T=0.35mm
6. 所有卷轮为灰蓝挖空旋转塑胶卷轮
7. 整模成型长度: 10.5M,
8. 非指明公差范围为: ±0.1mm; 超过250mm不计算累计误差
9. 型腔外形凡未标明处倒角R为0.2-0.3; 拔模斜度未标注的为3° 以下

包装信息:

1. 每卷盘装产品 500 只, 卷盘外侧贴相关标签;
2. 每 6 卷盘放在一个塑料袋中;
3. 每外箱装 6 盘, 产品总数: 3000 只;
4. 外箱上下用胶纸封成"工"字;
5. 净重: 4.56 KG, 毛重: 7.5 KG.

MANUFACTURE DWG		东莞市讯普电子科技有限公司 DongGuan XunPu Electronics Co., Ltd	
UNLESS OTHERWISE SPECIFIED TOLERANCES			TITLE: Au SMT 短脚 卷装
DECIMALS:	ANGLES:		PAR BS-0603-SA-4W
X.X±0.30	X.*±5°		DWN
X.XX±0.25	X.X*±1°		CHKD APVD
X.XXX±0.15		CUSTOMER COPY	SCALE N:A UNIT:MM
			SIZE:A4 SHEET:1F1
			REV:A