

## NOTES

## MATERIAL

- 1.HOUSING MATERIAL: GLASS FILLED POLYESTER UL94V-0.
- 2.CONTACT MATERIAL: PHOSPHOR BRONZE $\tau$ =0.3mm.
- 3.PLATING: GOLD FLASH PLATING OVER NICKEL.
- 4.SHIELD: 0.20mm THICKNESS COPPER ALLOY WITH NICKEL PLATED.

## ELECTRICAL

- 1.VOLTAGE RATING: 125 VAC RMS.
- 2.CURRENT RATING: 1.5 AMP.
- 3.CONTACT RESISTANCE: 40 MILLIOHMS MAX.
- 4.INSULATION RESISTANCE: 500 MEGOHMS MIN @ 100V DC .
- 5.DIELECTRIC DIELECTRIC RESISTANCE: 500V DC RMS 50Hz. 1MIN.

## MECHANICAL

- 1.DURRABILITY: 750 CYCLES MIN.
- 2.MATING/UNMATING FORCE: 2.24 KG.F MAX.

## ENVIRONMENTAL:

- 1.STORAGE:  $-40^{\circ}\text{C}\sim+85^{\circ}\text{C}$ .
- 2.OPERATION:  $-40^{\circ}\text{C}\sim+85^{\circ}\text{C}$ .

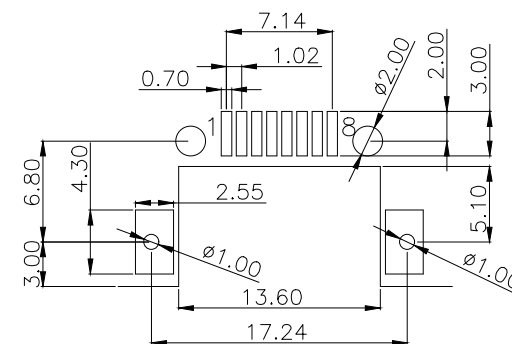
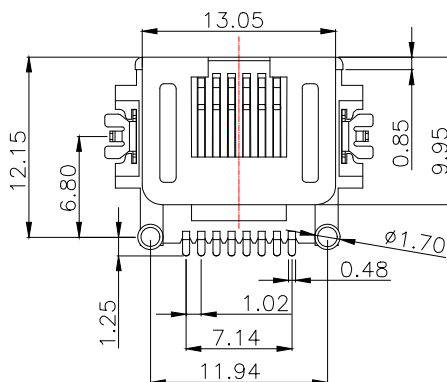
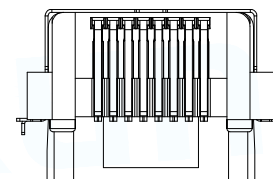
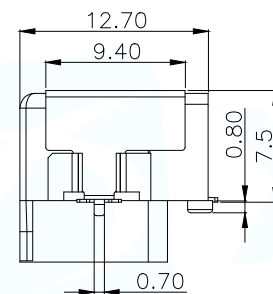
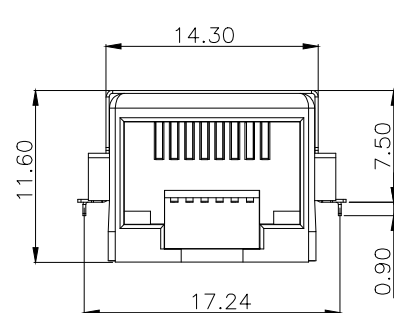

PCBLAYOUT TOP VIEW  
TOL  $\pm 0.05$

8	—
7	—
6	RX—
5	—
4	—
3	RX+
2	TX—
1	TX+
PIN	说明

MANUFACTURE DWG		 东莞市讯普电子科技有限公司 DongGuan XunPu Electronics Co.,Ltd	
UNLESS OTHERWISE SPECIFIED TOLERANCES		TITLE: RJ45 7.5 SMT	
DECIMALS:		PAR	RJ45-110-051-11
ANGLES:		DWN	
.X: $\pm 0.35$		CHKD	
.XX: $\pm 0.25$		APVD	
.XXX: $\pm 0.15$		SCALE:1:1	UNIT:MM
CUSTOMER COPY		SIZE:A4	SHEET:1F1
			REV:A