

PCB LATOUT

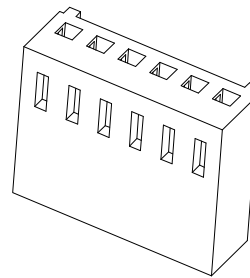

SPECIFICATIONS

1. Current Rating: 3A AC, DC
2. Voltage Rating: 250V AC, DC
3. Temperatur Range: -25°C~ +85°C
4. Contact Resistance: 20mΩ Max
5. Insulation Resistance: 1000mΩ Min
6. Withstanding Voltang: 1000V AC/minute
7. Material: Housing Nylon66 UL94-VO

Circuit	Part NO.	Dimensions mm	
		A	B
2	XD-2510-2Y-X	2.54	5.84
3	XD-2510-3Y-X	5.08	8.38
4	XD-2510-4Y-X	7.62	10.92
5	XD-2510-5Y-X	10.16	13.46
6	XD-2510-6Y-X	12.70	16.00
7	XD-2510-7Y-X	15.24	18.54
8	XD-2510-8Y-X	17.78	21.08
9	XD-2510-9Y-X	20.32	23.62
10	XD-2510-10Y-X	22.86	26.16
11	XD-2510-11Y-X	25.40	28.70
12	XD-2510-12Y-X	27.94	31.24
13	XD-2510-13Y-X	30.48	33.78
14	XD-2510-14Y-X	33.02	36.32
15	XD-2510-15Y-X	35.56	38.86
16	XD-2510-16Y-X	38.10	41.40
17	XD-2510-17Y-X	40.64	43.94
18	XD-2510-18Y-X	43.18	46.48
19	XD-2510-19Y-X	45.72	49.02
20	XD-2510-20Y-X	48.26	51.56

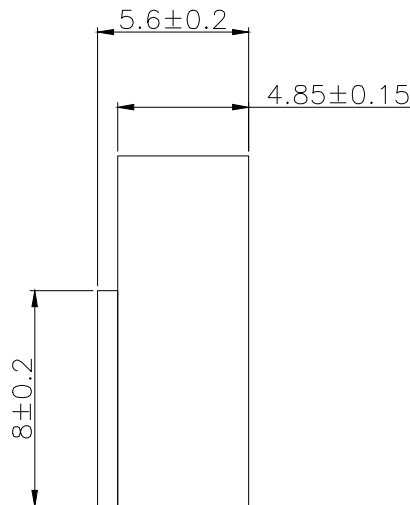
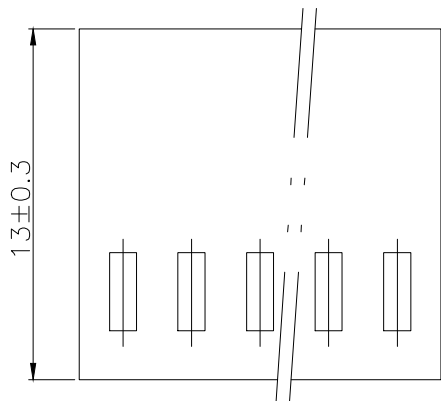

Ordering Information

XD - 2510 - N *** - *

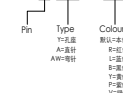

GENERAL TOLERANCE			制图 DRAWING	05	深圳讯答科技有限公司 ShenzhenXunDaTechnology Co.,Ltd			
DIM TOL			审核 CHECK					
X.X ±0.30			批准 APPROVAL		产品名称 TITLE	2510 (2.50) 单排 孔座	版本 REV.	A
X.XX ±0.20			投影 Projection		产品料号 PART NO.	XD-2510-NY-X	单位 UNITS	mm
X.XXX ±0.10					材料 MATERIAL		页次 SHEET	1/1
序号 No.	变更内容 MODIFY CONTENT	日期 MODIFY DATE						