

标记 MARK.	更改内容 MODIFICATION	日期 DATE	修改 DRAW	核准 APPROVE

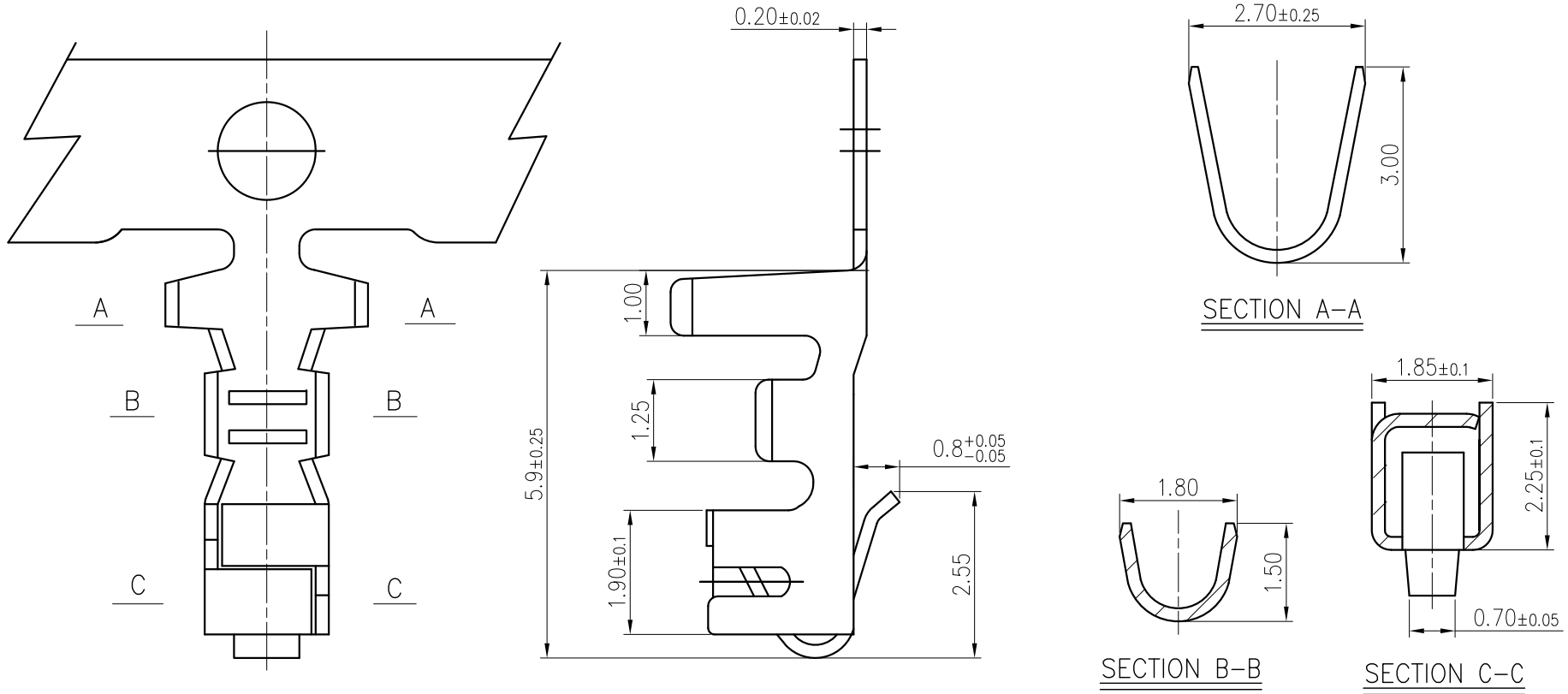

技术要求Specification:

1、材质：磷青铜，表面镀锡 Material:Phos.Bronze Tin-Plated

2、适用线规：AWG#30to#22
Applicable wire:AWG#30to#22

3、零件外观不得有有害毛刺、尖角、锐边和机械损伤;表面镀层应均匀、光亮、无雾斑、剥层等缺陷;
Parts may not have the appearance of harmful burrs,sharp corners,sharp edges and mechanical damage,surface coating should be uniform, bright,no fog spots,delamination and other defects.

4、适配SH25001-NY和SH25010-NY

TOLERANCE UNLESS OTHERWISE SPECIFIED		*: Inspection Item					
. X±0.30	X. ° ±1°	(NO.)	:Cp/Cpk and SPC Control Item				
. XX±0.20	. X° ±	材料 MATERIAL	磷青铜	名称 TITLE	XH2.5 端子		
. XXX±0.10	. XX° ±	料厚 THICK	0.20 mm	编号 DWG NO.	BX-XH2.54-DZ	单位 UNIT	mm
制图 DRAWING		料宽 WIDE		比例 SCALE	1:1	版本 REV.	A0
审核 CHECKED		日期 DATE		角法 PROJ.			
批准 APPROVE					规格书		