

SPECIFICATIONS

- 1、Current Rating: 3A AC, DC
- 2、Voltage Rating: 250V AC, DC
- 3、Temperatuer Range: $-25^{\circ}\text{C} \sim +85^{\circ}\text{C}$
- 4、Contact Resistance: $20\text{m}\Omega$ Max
- 5、Insulation Resistance: $1000\text{M}\Omega$ Min
- 6、Withstanding Voltang: 1000V AC/minute
- 7、Material: Wafer Nylon66, UL94V-0
PIN Brass Tin-plated

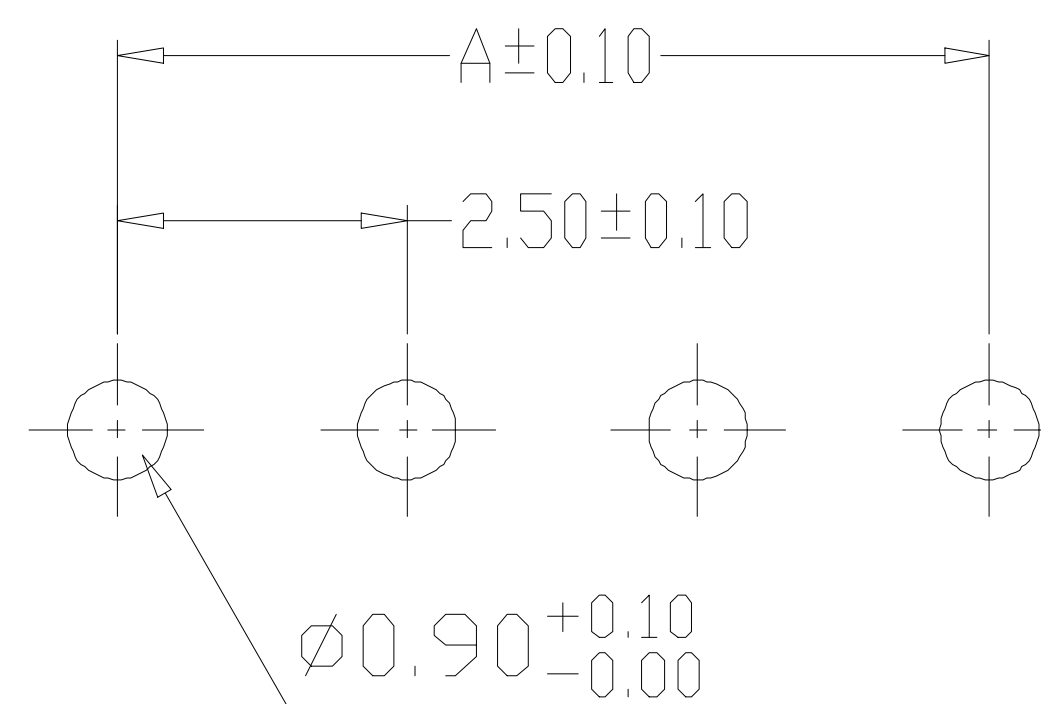
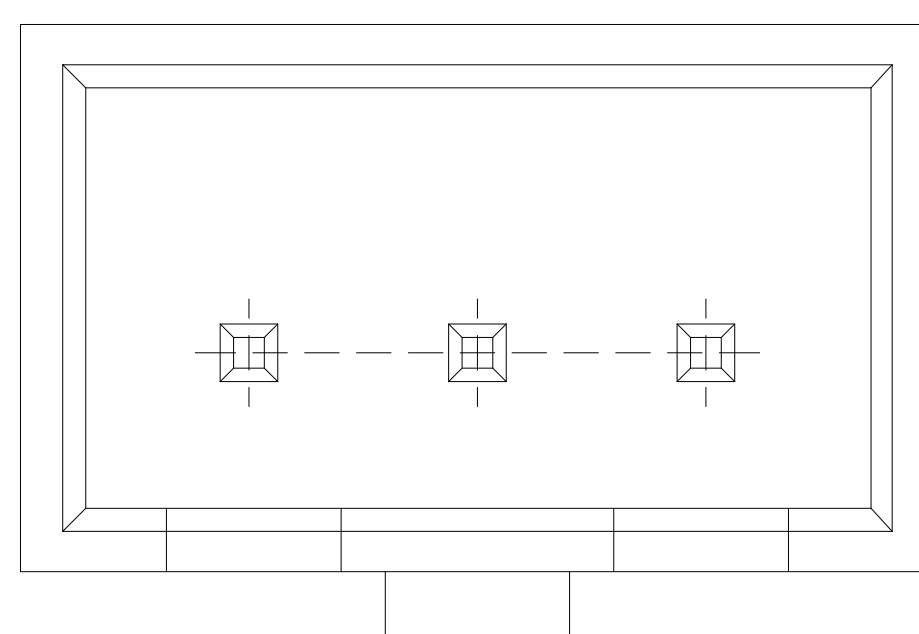
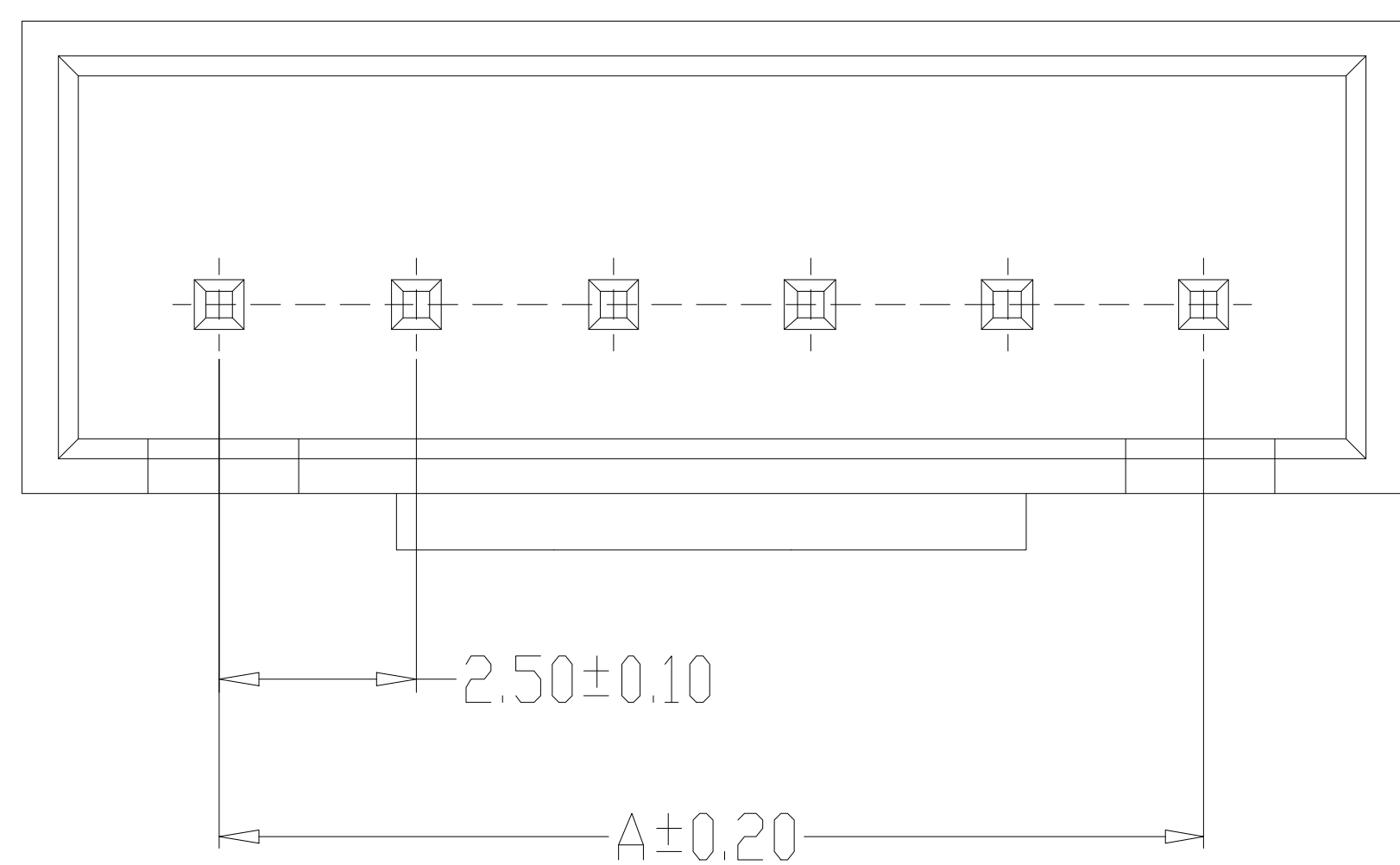

PCB LAYOUT

| 编号 | 尺寸 (mm) | |
|-----------|---------|-------|
| | A | B |
| A2504-02A | 2.50 | 7.50 |
| A2504-03A | 5.00 | 10.00 |
| A2504-04A | 7.50 | 12.50 |
| A2504-05A | 10.00 | 15.00 |
| A2504-06A | 12.50 | 17.50 |
| A2504-07A | 15.00 | 20.00 |
| A2504-08A | 17.50 | 22.50 |
| A2504-09A | 20.00 | 25.00 |
| A2504-10A | 22.50 | 27.50 |
| A2504-11A | 25.00 | 30.00 |
| A2504-12A | 27.50 | 32.50 |
| A2504-20A | 47.50 | 52.50 |

| 制图 DRAWN | 变更内容 DESCRIPTION | 日期 DATE | GENERAL TOLERANCE | | 制图 DRAWING | 料号 PART NO. | 版本 REV. | | | | |
|-------------|---------------------|----------------|-------------------|------------|---------------|----------------|------------|-------------|-------------------|--------------|-------------|
| | | | X.±0.25 | X.°±2° | | | | 审核 CHECK | 客户料号 CUTM. NO. | HA2.54 直针 5P | 页次 SHEET |
| .X±0.20 | .X°±1° | 核准 APPROVAL | 单位 UNITS | MM | 比例 SCALE | 1:1 | | | | | |
| | | | | | | | | .XX±0.15 | .XX°±0.5° | | |
| | | | .XXX±0.10 | .XXX°±0.5° | | | | | | | |

Bossie (博锡)