

NOTES:

1. MATERIALS AND FINISHES:

SMA JACK:
 BODY, HOUSING: BRASS, GOLD PLATING,
 CONTACT: BERYLLIUM COPPER, GOLD PLATING.
 INSULATOR: PTFE, NATURAL
 MHF(1) PLUG: PHOSPHOR BRONZE, GOLD PLATING
 CABLE: 1.13MM MICRO-COAX

2. ELECTRICAL:

A. IMPEDANCE: 50 OHMS
 B. FREQUENCY RANGE: DC - 3 GHz
 C. VSWR: 1.21:1 MAX @ DC - 3 GHz
 D. DIELECTRIC WITHSTANDING VOLTAGE: 200 VRMS, MIN.

3. PACKAGING:

A. QUANTITY: SINGLE PACK
 B. MARKING: BAG TO BE MARKED
 "AMPHENOL RF, 95-902-492-XXX, AND DATE CODE"

4. MHF(1) IS INTERMATABLE WITH U.FL.

THIRD ANGLE PROJ.

REVISIONS

REV	DESCRIPTION	DATE	ECN	APPR
A	RELEASE TO MFG.	21-Jun-18	08402	KEN
B	MHF(1) PLUG AND CABLE WERE CHANGED	10-Dec-18	10323	KEN

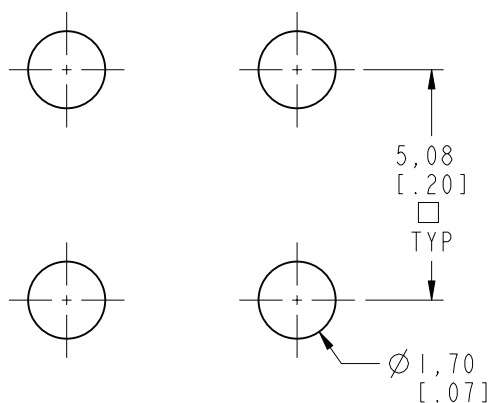
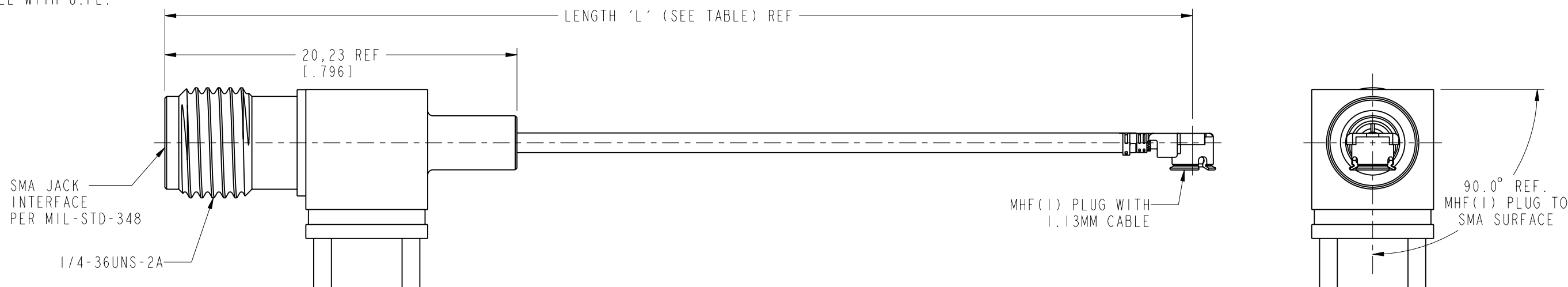

95-902-492-300	300.00 [11.81]
95-902-492-250	250.00 [9.84]
95-902-492-200	200.00 [7.87]
95-902-492-150	150.00 [5.91]
95-902-492-100	100.00 [3.94]
95-902-492-050	50.00 [1.97]
PART NUMBER	LENGTH IN MM (INCHES)

**RECOMMENDED
PCB MOUNTING HOLE**

CUSTOMER OUTLINE DRAWING
 ALL OTHER SHEETS ARE FOR INTERNAL USE ONLY

UNLESS OTHERWISE SPECIFIED, DIMENSIONS ARE IN METRIC AND TOLERANCES ARE: <0.5mm ±0.05mm 0.5 - 6mm ±0.1mm 6 - 30mm ±0.2mm 30 - 120mm ±0.3mm ANGLES ±1°	MATERIAL	DRAWN	DATE	TITLE		Amphenol RF www.amphenolrf.com
	SEE NOTES	S.DUAN	20-Dec-18	CABLE ASSY, SMA JACK TO MHF(1) PLUG 1.13 CABLE		
NOTICE - These drawings, specifications, or other data (1) are, and remain the property of Amphenol corp. (2) must be returned upon request; and (3) are confidential and not to be disclosed to any person other than those to whom they are given by Amphenol Corp. the furnishing of these drawings, specifications, or other data by Amphenol Corp., or to any other person to anyone for any purpose is not to be regarded by implication or otherwise in any manner licensing, granting rights to permitting such holder or any other person to manufacture, use or sell any product, process or design, patented or otherwise, that may in any way be related to or disclosed by said drawings, specifications, or other data.	REFERENCE	ENGINEER	DATE	SCALE: 4.0:1.0 SHEET 2 OF 2		DRAWING NO. 95-902-492-XXX
	EAR# 8413	N.BUDRIS	11-Jun-18	DWG SIZE B		ITEM NO. 95-902-492-XXX
	REF: 95-902-44847	APPROVED	S.HSIEH	DATE	REV B	PART NO. 95-902-492-XXX
CONFIGURATION LEVEL: In Work	FINISH	CAD FILE	25-Jan-18			