

## SPECIFICATION CONTROL DRAWING

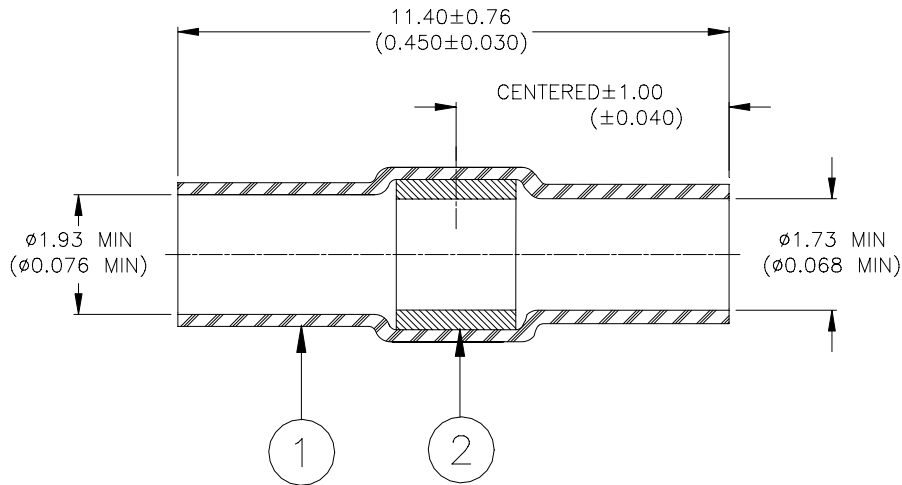

### MATERIALS

1. **INSULATION SLEEVE:** Heat-shrinkable, transparent blue, radiation cross-linked polyvinylidene fluoride.
2. **SOLDER PREFORM WITH FLUX:**  
     **SOLDER:** TYPE Sn63 per ANSI-J-STD-006.  
     **FLUX:** TYPE ROL1 per ANSI-J-STD-004.

### APPLICATION

1. This part is designed to be used in making a one-to-one in-line splice in wires having tin or silver-plated conductors and insulations rated for at least 125°C.  
     Wire Accommodation:  
         CMA Range: 500 to 950  
         Jacket Diameter: 0.76 to 1.65 (0.030 to 0.065)
2. Wires are to be stripped 3.81 to 5.08 (0.150 to 0.200) and centered under solder preform.
3. Part may be installed with Raychem hot-air or infrared heaters.

<b>tyco / Electronics / Raychem</b>		<b>Wire and Harnessing Products</b>		TITLE: <b>SOLDERSLEEVE WIRE SPLICE</b>			
307 Constitution Drive Menlo Park, CA 94025, USA							
UNLESS OTHERWISE SPECIFIED DIMENSIONS ARE IN MILLIMETERS. INCHES DIMENSIONS ARE BETWEEN BRACKETS.				DOCUMENT NO.: <b>D-110-0124</b>			
TOLERANCES: 0.00 N/A 0.0 N/A 0 N/A	ANGLES: N/A  ROUGHNESS IN MICRON	Tyco Electronics reserves the right to amend this drawing at any time. Users should evaluate the suitability of the product for their application.		DCR NUMBER: <b>D010096</b>	REPLACES: <b>N/A</b>		
DRAWN BY: M. FORONDA	DATE: 04-Apr.-01	PROD. REV. A	DOC ISSUE: 1	SCALE: None	SIZE: A	SHEET: 1 of 1	

If this document is printed it becomes uncontrolled. Check for the latest revision.