

| REV. | ECR/N NO./DESCRIPTION | DATE     | DRAWN | CHECKED | APPROVE |
|------|-----------------------|----------|-------|---------|---------|
| 9I   | SR13***               | 05/22'13 | Lxh   | Vito    | Barney  |
| 9J   | SR13***               | 07/15'13 | Lxh   | Vito    | Barney  |
| 9K   | SR13***               | 09/13'13 | Lxh   | Vito    | Barney  |

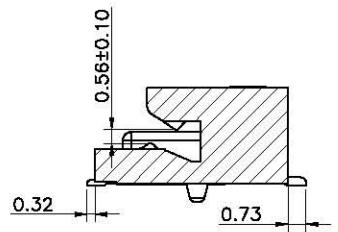

SECTION B-B  
SCALE 2:1

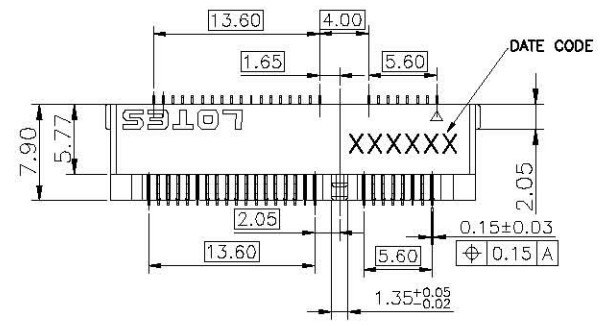
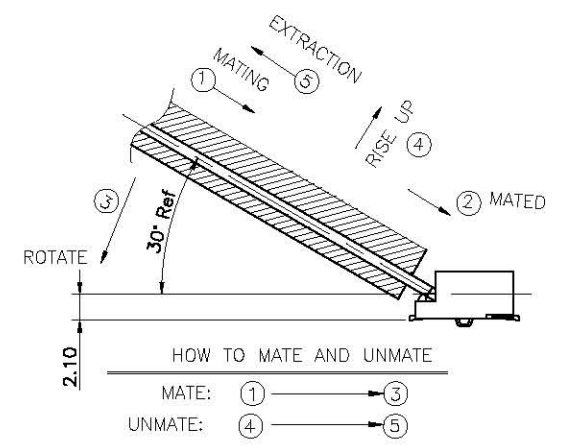

HOW TO MATE AND UNMATE

- MATE: ① → ③  
UNMATE: ④ → ⑤

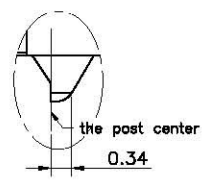
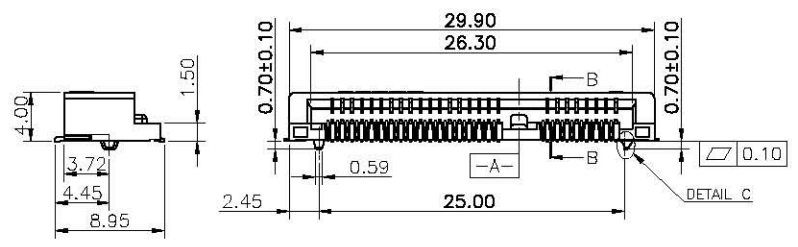

DETAIL C  
SCALE 5:1

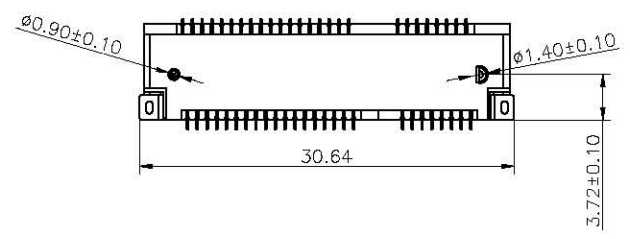

|                                     |                    |                           |                                          |  |           |
|-------------------------------------|--------------------|---------------------------|------------------------------------------|--|-----------|
| GENERAL TOLERANCES UNLESS SPECIFIED |                    | PART NO.<br>XDAP-0528-049 | 深圳市连欣科技有限公司                              |  |           |
| X ± 0.35                            | X° ± 3°            |                           | TEI: 0755-36610035 FAX: 0755-36610036    |  |           |
| XX ± 0.25                           | X° ± 2°            |                           | TITLE MINI PCI EXPRESS 4.0H 0.8PITCH 52P |  |           |
| XXX ± 0.15                          | XX° ± 1°           | APPROVED BY<br>Barney     | DWG NO.<br>AP-AAA-PCI-049                |  |           |
| CUSTOMER DRAWING                    |                    | CHECKED BY<br>Raymond     | A                                        |  |           |
| SIZE<br>A4                          | UNITS<br>MM [INCH] | DRAWN BY<br>XU            | SHEET<br>1 / 6                           |  |           |
|                                     |                    |                           | SCALE<br>5 : 3                           |  | REV<br>9K |

1 2 3 4 5 6 7 8

F

F

NOTES:

1.MATERIAL:

- 1).HOUSING: LCP BLACK OR WHITE UL94V-0.
- 2).CONTACT: BRASS.
- 3).PADS: BRASS .

2.FINISH:

2.1 CONTACTS:

- 1).50u"MIN Ni UNDER PLATED OVER ALL.
- 2).Au PLATING ON CONTACT AREA (SEE TABLE), AND ON SOLDER AREA

2.2 PADS:

- 1).60u"MIN Ni UNDER PLATED OVER ALL.
- 2).MATTE-Tin 100u"MIN ON SOLDER AREA.

3.MECHANICAL PERFORMANCE,

DURABILITY:50 CYCLES

MATING & UNMATING FORCE: 2.3 Kgf MAX.

4.ELECTRICAL PERFORMANCE,

- 4-1.VOLTAGE RATING: 50 V AC PER CONTACT.  
CURRENT RATING: 0.5 A.
- 4-2.LLCR:INITIAL 55mΩ MAX PER CONTACT..  
FINAL 20mΩ MAX
- 4-3.INSULATION RESISTANCE:  
500MΩ MIN
- 4-4.DIELECRIC WITHSTAND VOLTAGE:  
AC 300V FOR 1 MINUTE BETWEEN ADJACENT CONTACTS.  
NO BREAKDOWN OR FLASH.  
CURRENT LEAKAGE:1mA.

5. IR REFLOW:

THE PEAK TEMPRATURE ON THE BOARD SHALL BE MAINTAINED FOR 10 SECONDS AT 250°C±10°C AND REFLOW TEMP:230°C 30~45 SECONDS.

6. DC: XXXXXX

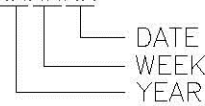

7. PRODUCT NO:AAA-PCI-\*\*\*-\*\*\*

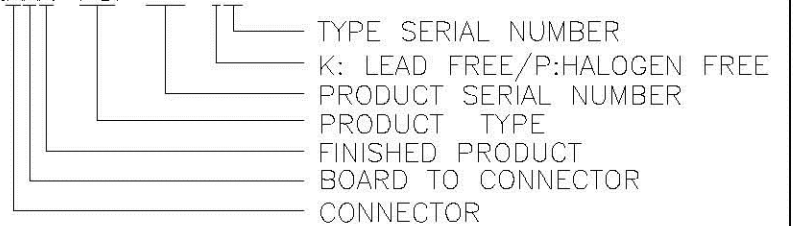

D

D

C

C

B

B

A

A

|                                     |                   |               |                                       |       |       |     |
|-------------------------------------|-------------------|---------------|---------------------------------------|-------|-------|-----|
| GENERAL TOLERANCES UNLESS SPECIFIED |                   | PART NO.      | 深圳市连欣科技有限公司                           |       |       |     |
| <del>X±0.35</del>                   | <del>X°±3°</del>  | XDAP-0528-049 | TEI: 0755-36610035 FAX: 0755-36610036 |       |       |     |
| <del>XX±0.25</del>                  | <del>X°±2°</del>  | APPROVED BY   | TITLE                                 |       |       |     |
| <del>XXX±0.15</del>                 | <del>XX°±1°</del> | Bamey         | MINI PCIEXPRESS                       |       |       |     |
| CUSTOMER DRAWING                    |                   | CHECKED BY    | DWG NO.                               |       |       |     |
|                                     |                   | Raymond       | AP-AAA-PCI-049                        |       |       |     |
| SIZE                                | UNITS             | DRAWN BY      |                                       | SHEET | SCALE | REV |
| A4                                  | MM[INCH]          | XU            |                                       | 2 / 6 | 5 : 2 | 9K  |

1 2 3 4 5 6 7 8

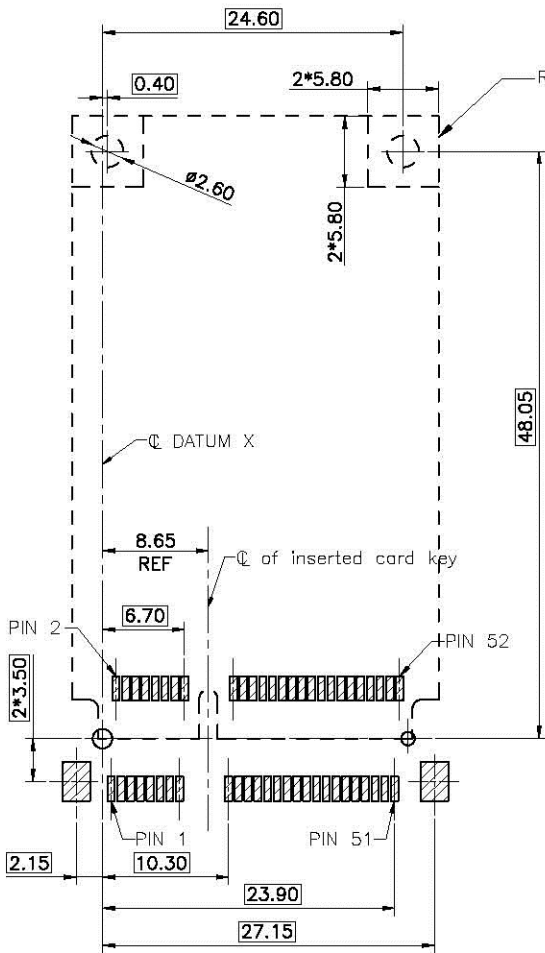

RECOMMENDED PCB LAYOUT  
GENERAL TOLERANCE ±0.05mm

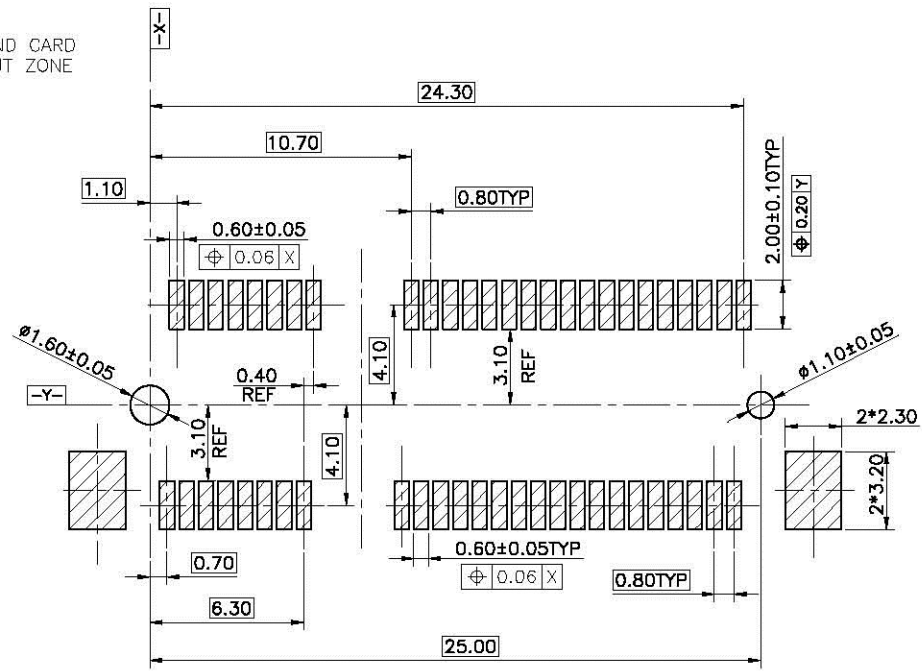

SCALE 2:1  
GENERAL TOLERANCE ±0.05mm

|                                     |                     |               |                                       |       |     |
|-------------------------------------|---------------------|---------------|---------------------------------------|-------|-----|
| GENERAL TOLERANCES UNLESS SPECIFIED |                     | PART NO.      | 深圳市连欣科技有限公司                           |       |     |
| <del>X ± 0.35</del>                 | <del>X° ± 3°</del>  | XDAP-0528-049 | TEI: 0755-36610035 FAX: 0755-36610036 |       |     |
| <del>XX ± 0.25</del>                | <del>X° ± 2°</del>  | APPROVED BY   | TITLE MINI PCI EXPRESS                |       |     |
| <del>XXX ± 0.15</del>               | <del>XX° ± 1°</del> | Barney        | 4.0H 0.8PITCH 52P                     |       |     |
| CUSTOMER DRAWING                    |                     | CHECKED BY    | DWG NO.                               |       |     |
|                                     |                     | Raymond       | AP-AAA-PCI-049                        |       |     |
| SIZE                                | UNITS               | DRAWN BY      | SHEET                                 |       |     |
| A4                                  | MM [INCH]           | XU            | 3 / 6                                 | SCALE | REV |
|                                     |                     |               | 5 : 3                                 | 9K    |     |

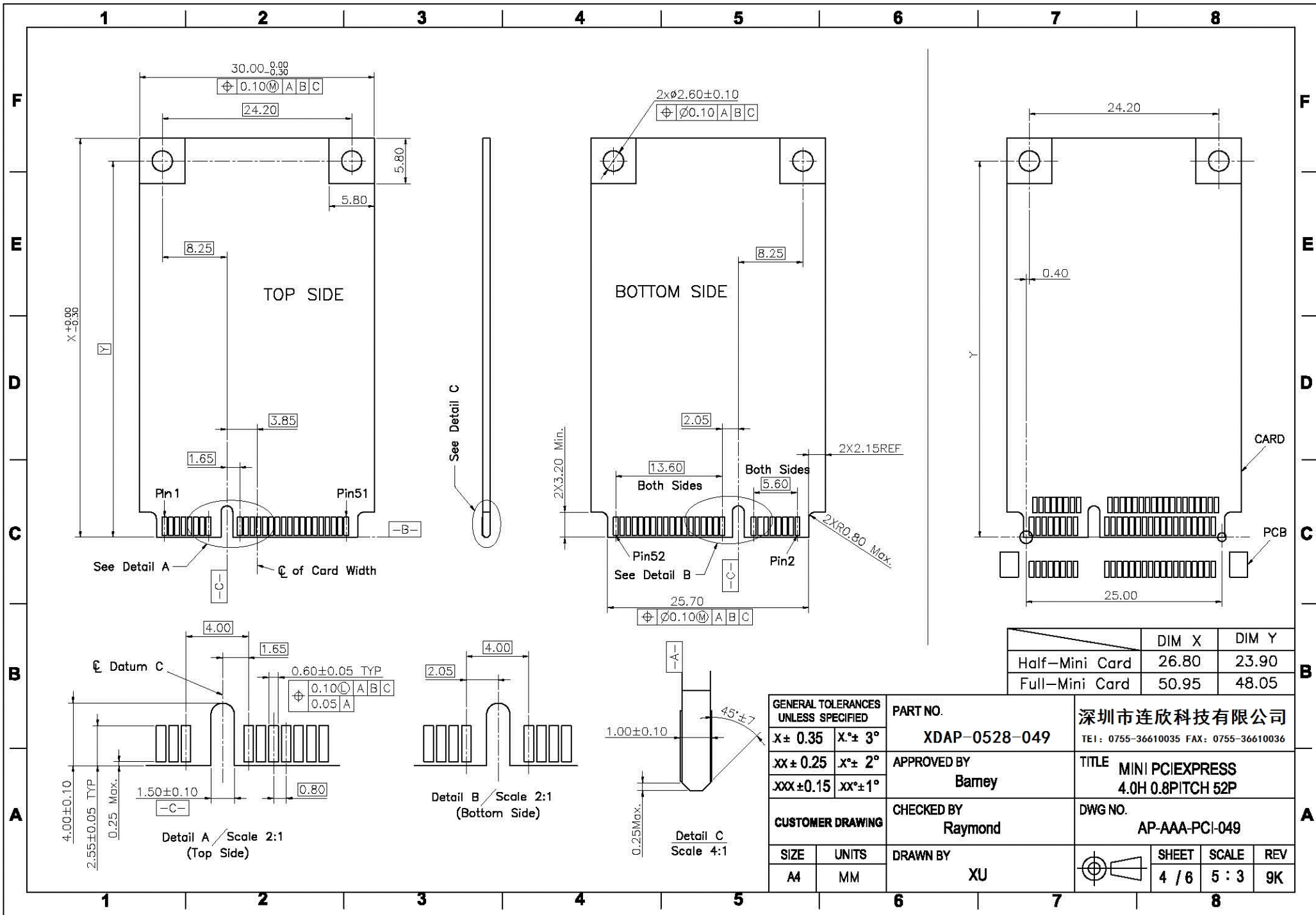

|                | DIM X | DIM Y |
|----------------|-------|-------|
| Half-Mini Card | 26.80 | 23.90 |
| Full-Mini Card | 50.95 | 48.05 |

|                                     |           |
|-------------------------------------|-----------|
| GENERAL TOLERANCES UNLESS SPECIFIED |           |
| X ± 0.35                            | X° ± 3°   |
| XX ± 0.25                           | X° ± 2°   |
| XXX ± 0.15                          | .XX° ± 1° |

|             |               |
|-------------|---------------|
| PART NO.    | XDAP-0528-049 |
| APPROVED BY | Barney        |
| CHECKED BY  | Raymond       |
| DRAWN BY    | XU            |

|                                          |       |     |
|------------------------------------------|-------|-----|
| 深圳市连欣科技有限公司                              |       |     |
| TEI: 0755-36610035 FAX: 0755-36610036    |       |     |
| TITLE MINI PCI EXPRESS 4.0H 0.8PITCH 52P |       |     |
| DWG NO. AP-AAA-PCI-049                   |       |     |
| SHEET                                    | SCALE | REV |
| 4 / 6                                    | 5 : 3 | 9K  |

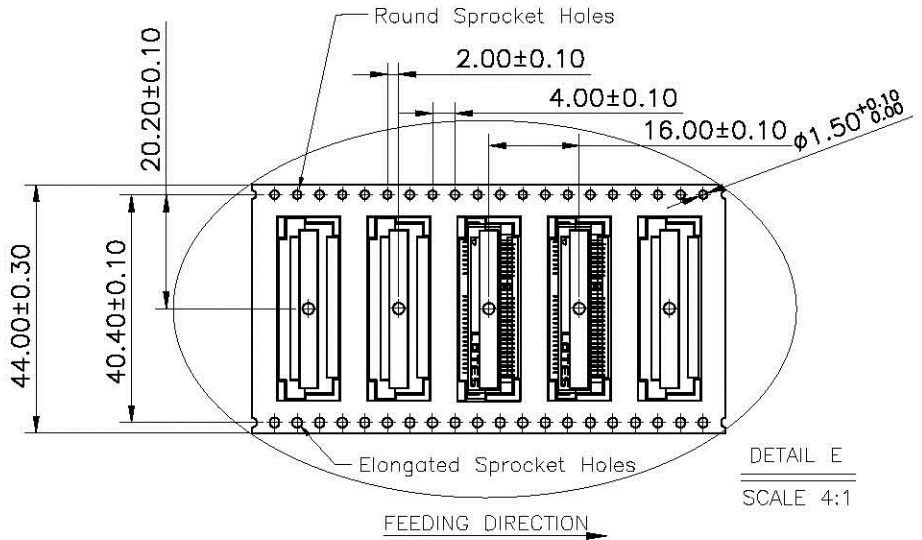
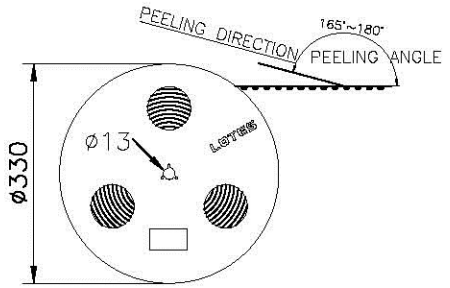
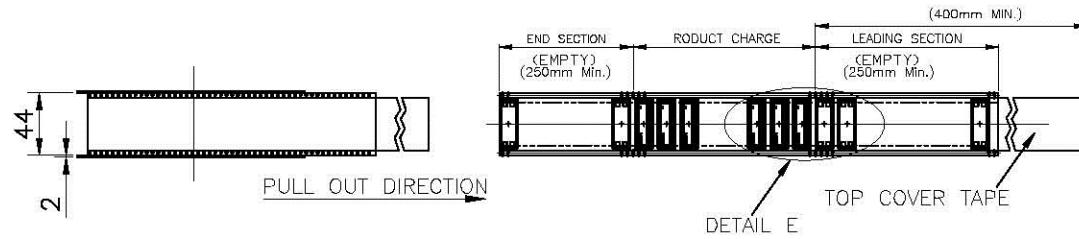

DETAIL E  
SCALE 4:1

AAA-PCI-049-K06/P07/P08/P06/K01/P01

NOTES:

1. MATERIAL :
  - 1.1 CARRY TAPE: PS
  - 1.2 COVER TAPE: PET
  - 1.3 SHIPPING CARTON: CORRUGATED FIBER
2. DIMENSION :
  - 2.1 REEL: W=44.5,  $\phi A=330$
  - 2.2 SHIPPING CARTON: L=335, W=335, H=300 (INNER)
3. QUANTITY :
  - 3.1 PRIMARY PACKING: 700 PCS/REEL
  - 3.2 SECONDARY PACKING: 6 REELS/CARTON(4200PCS)
4. WEIGHT :
  - 4.1 NET WEIGHT:4.956Kg/CARTON.
  - 4.2 GROSS WEIGUT:8.892Kg/CARTON.
5. PEELING RESISTANCE: 20gf~120gf.
6. PEELING SPEED: 300mm/minutes.

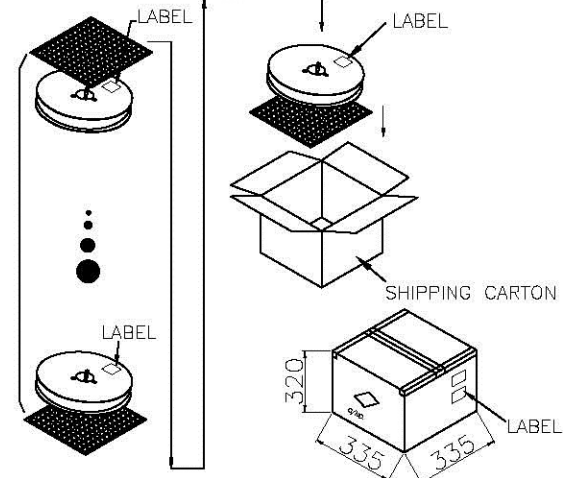

|                                     |          |               |  |                                       |  |
|-------------------------------------|----------|---------------|--|---------------------------------------|--|
| GENERAL TOLERANCES UNLESS SPECIFIED |          | PART NO.      |  | 深圳市连欣科技有限公司                           |  |
| X± 0.35                             | X°± 3°   | XDAP-0528-049 |  | TEL: 0755-36610035 FAX: 0755-36610036 |  |
| XX± 0.25                            | X°± 2°   | APPROVED BY   |  | TITLE                                 |  |
| XXX± 0.15                           | XX°± 1°  | Barney        |  | MINI PCIEXPRESS<br>4.0H 0.8PITCH 52P  |  |
| CUSTOMER DRAWING                    |          | CHECKED BY    |  | DWG NO.                               |  |
|                                     |          | Raymond       |  | AP-AAA-PCI-049                        |  |
| SIZE                                | UNITS    | DRAWN BY      |  | SHEET                                 |  |
| A4                                  | MM[INCH] | XU            |  | 5 / 6                                 |  |
|                                     |          |               |  | SCALE                                 |  |
|                                     |          |               |  | N/A                                   |  |
|                                     |          |               |  | REV                                   |  |
|                                     |          |               |  | 9K                                    |  |

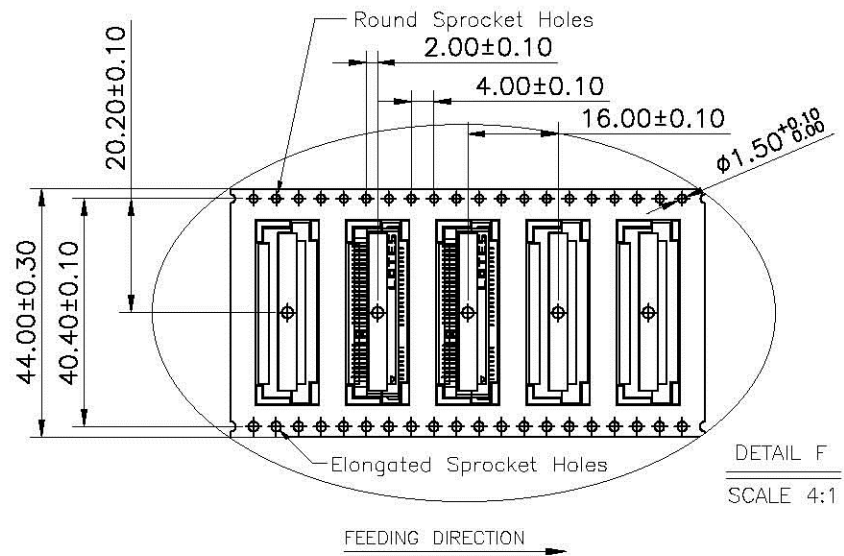
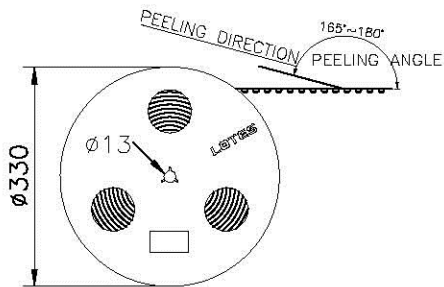
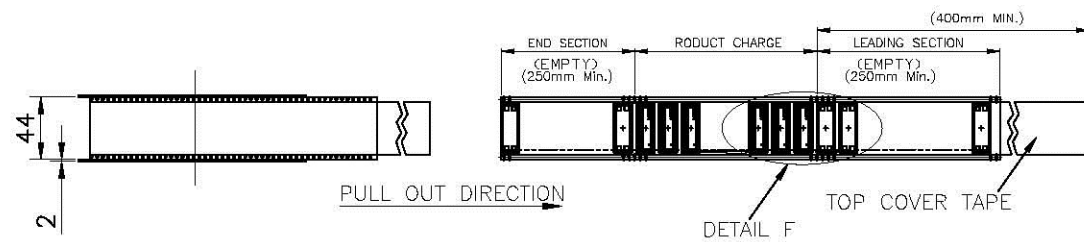

AAA-PCI-049-K01\_A/P06\_A/P01\_A

DETAIL F  
SCALE 4:1

NOTES:

1. MATERIAL :
  - 1.1 CARRY TAPE: PS
  - 1.2 COVER TAPE: PET
  - 1.3 SHIPPING CARTON: CORRUGATED FIBER
2. DIMENSION :
  - 2.1 REEL: W=44.5,  $\phi A=330$
  - 2.2 SHIPPING CARTON: L=335, W=335, H=300 (INNER)
3. QUANTITY :
  - 3.1 PRIMARY PACKING: 700 PCS/REEL
  - 3.2 SECONDARY PACKING: 6 REELS/CARTON(4200PCS)
4. WEIGHT :
  - 4.1 NET WEIGHT: 4.956Kg/CARTON.
  - 4.2 GROSS WEIGHT: 8.892Kg/CARTON.
5. PEELING RESISTANCE: 20gf~120gf.
6. PEELING SPEED: 300mm/minutes.

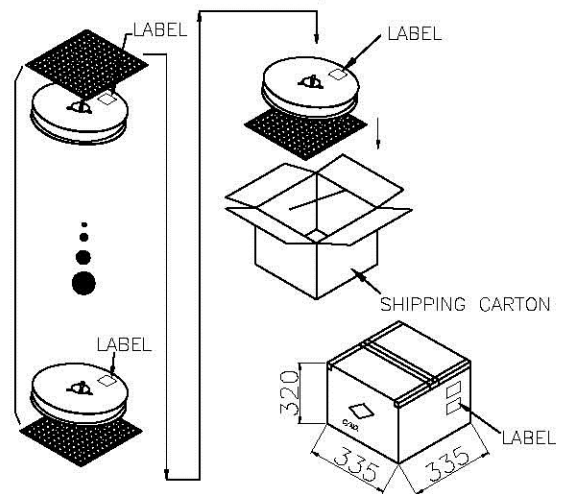

|                                     |                          |                                  |                                                        |              |            |           |
|-------------------------------------|--------------------------|----------------------------------|--------------------------------------------------------|--------------|------------|-----------|
| GENERAL TOLERANCES UNLESS SPECIFIED |                          | PART NO.<br><b>XDAP-0528-049</b> | 深圳市连欣科技有限公司                                            |              |            |           |
| X± 0.35                             | X°± 3°                   |                                  | TEL: 0755-36610035 FAX: 0755-36610036                  |              |            |           |
| XX± 0.25                            | X°± 2°                   | APPROVED BY<br><b>Barney</b>     | TITLE<br><b>MINI PCI EXPRESS<br/>4.0H 0.8PITCH 52P</b> |              |            |           |
| XXX± 0.15                           | .XX°± 1°                 | CHECKED BY<br><b>Raymond</b>     | DWG NO.<br><b>AP-AAA-PCI-049</b>                       |              |            |           |
| CUSTOMER DRAWING                    |                          | DRAWN BY<br><b>XU</b>            |                                                        | SHEET        | SCALE      | REV       |
| SIZE<br><b>A4</b>                   | UNITS<br><b>MM[INCH]</b> |                                  |                                                        | <b>6 / 6</b> | <b>N/A</b> | <b>9K</b> |