

SPECIFICATIONS

- 1、Current Rating: 3A AC, DC
- 2、Voltage Rating: 250V AC, DC
- 3、Temperatuer Range: -25℃~+85℃
- 4、Contact Resistance: 20mΩ Max
- 5、Insulation Resistance: 1000MΩ Min
- 6、Withstanding Voltang: 1000V AC/minute
- 7、Material: Wafer LCP、PA6T, UL94V-0
PIN Brass Tin-plated
Solder tad Phosphoric bronze Tin-plated

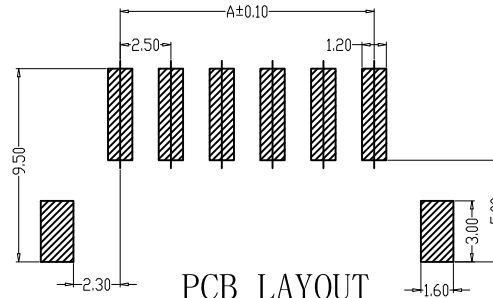
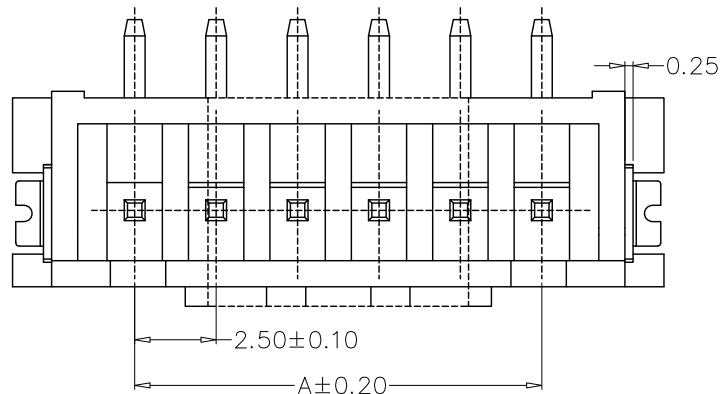
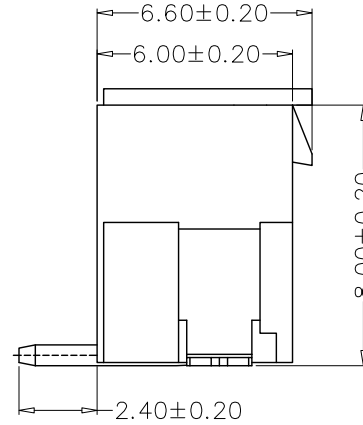
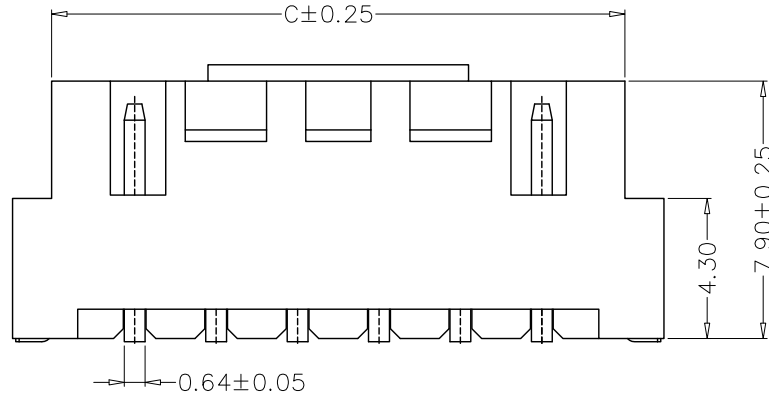

PCB LAYOUT

| 编 号 | 尺寸 (mm) | | |
|------------|---------|-------|-------|
| | A | B | C |
| A2504-02AB | 2.50 | 10.00 | 7.50 |
| A2504-03AB | 5.00 | 12.50 | 10.00 |
| A2504-04AB | 7.50 | 15.00 | 12.50 |
| A2504-05AB | 10.00 | 17.50 | 15.00 |
| A2504-06AB | 12.50 | 20.00 | 17.50 |
| A2504-07AB | 15.00 | 22.50 | 20.00 |
| A2504-08AB | 17.50 | 25.00 | 22.50 |
| A2504-09AB | 20.00 | 27.50 | 25.00 |
| A2504-10AB | 22.50 | 30.00 | 27.50 |
| A2504-11AB | 25.00 | 32.50 | 30.00 |
| A2504-12AB | 27.50 | 35.00 | 32.50 |
| A2504-20AB | 47.50 | 55.00 | 52.50 |

| | | | | | | | | | |
|-------------------|------------|----------|------------|--|-----------|---------------------|---------------|---------------------|-----|
| GENERAL TOLERANCE | | 制图 | 钱岳生 | | 料号 | A2504-nAB | | 版本 | A |
| X±0.25 | X*±2° | DRAWING | 2017、06、01 | | PART NO. | HA立贴 | | REV. | 1/1 |
| .X±0.20 | .X*±1° | 审核 | 张名 | | TITLE | WAFER SMT TYPE | | SHEET | 1/1 |
| .XX±0.15 | .XX*±0.5° | 核准 | 张名 | | 客户料号 | 深圳市金航标电子有限公司 | | www.kinghelm.com.cn | |
| .XXX±0.10 | .XXX*±0.5° | APPROVAL | 2017、06、05 | | CUTM. NO. | www.kinghelm.com.cn | | KH-A2504-04AB | |
| UNIT | MM | 比例 | SCALE | | 1:1 | | 0755-28190160 | | |