

REV.	ECN.NO.	MODIFY.CONTENT	DATE
A		NEW	2011/12/31

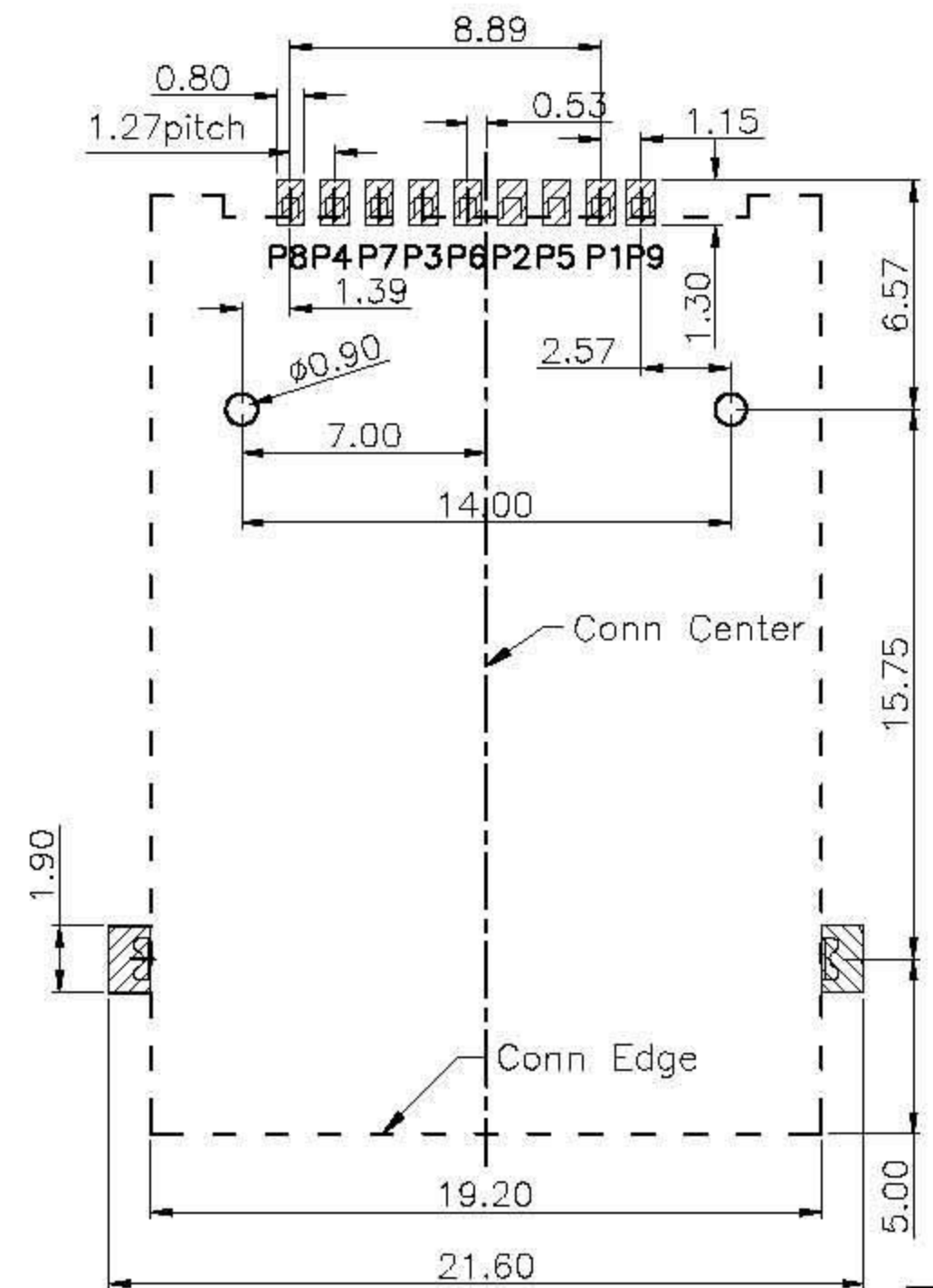

Specification:
 *Electrical Characteristics:
 Current Rating:1.5A.
 Withstanding Voltage:AC500V r.m.s.
 Insulation Resistance:1000Megohms Minimum at DC 500V
 Contact Resistance:100Miliohms Maximum.
 *Mechanical Characteristics:
 Mating Cycles:5000 Insertions.

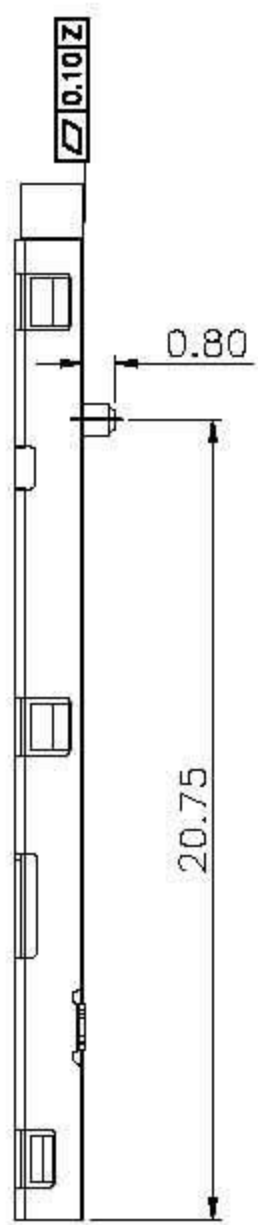
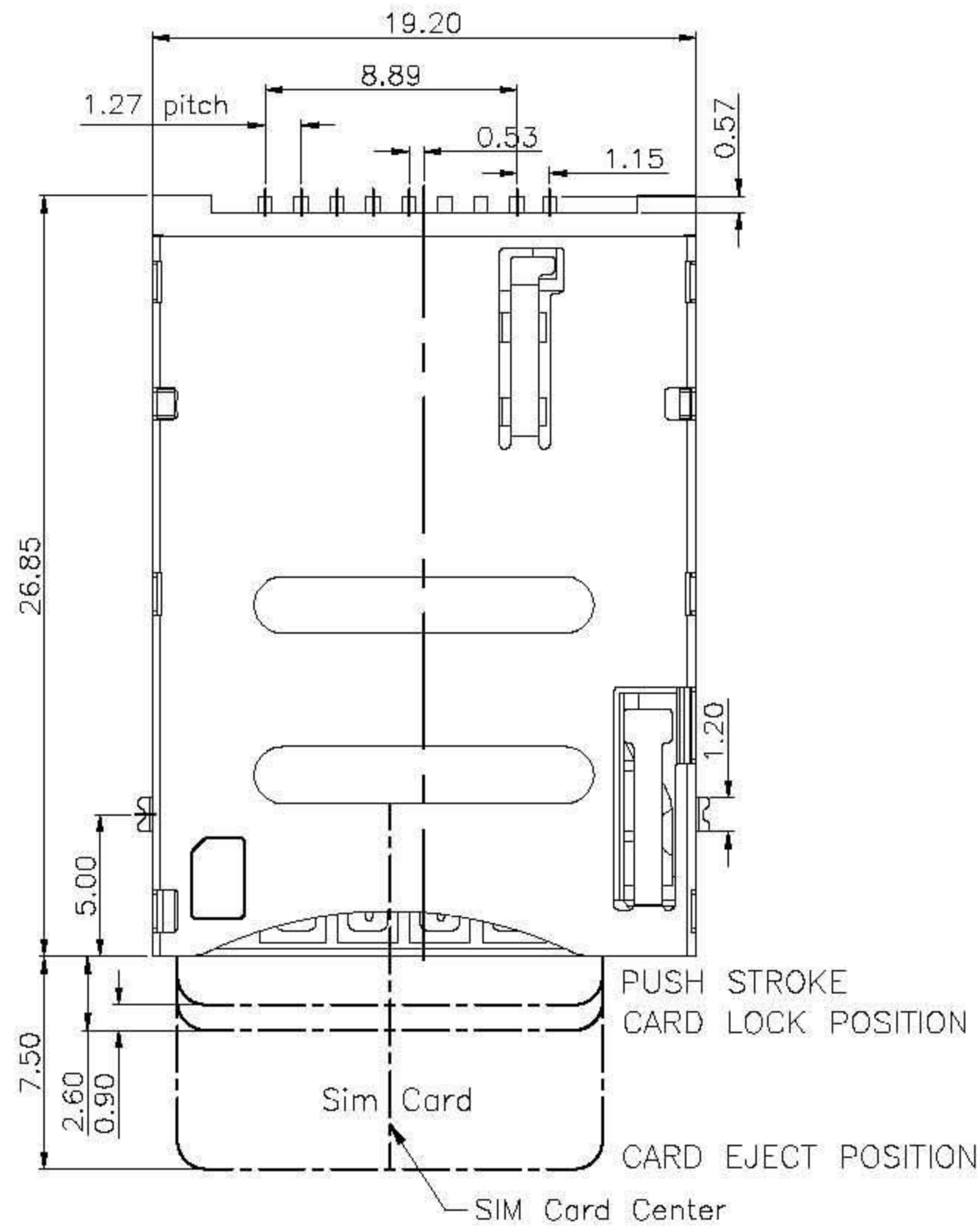
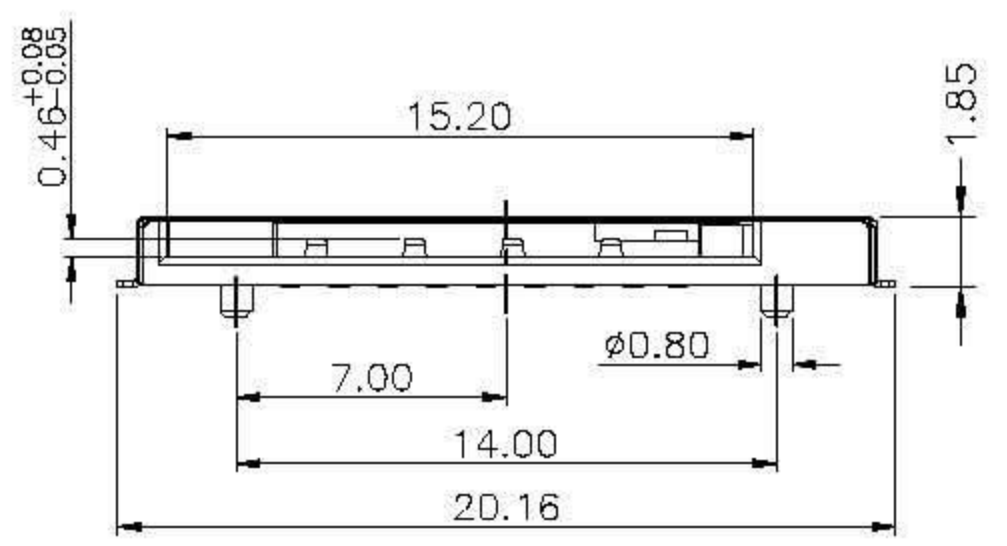

CONNECTOR TERMINAL NO	PIN NO
PIN 1	VCC:PWR SIGNAL AND GND
PIN 2	RST:RESET SIGNAL
PIN 3	CLK:CLOCKING SIGNAL
PIN 4	RESERVED
PIN 5	GND:PWR SIGNAL AND GND
PIN 6	VPP:PROGRAMMING VOLTAGE
PIN 7	I/O:SERIAL DATA INPUT/OUTPUT
PIN 8	RESERVED

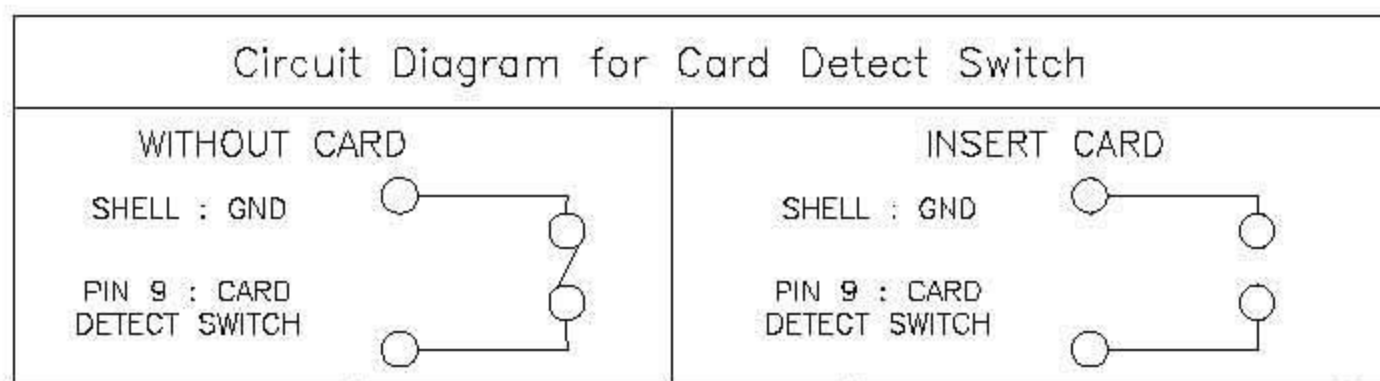

GENERAL TOLERANCE	DWG NO.	LZA1231-02	APPD:	WIND	Scale	1:1
X.±0.25	x.'±5'	Title	SIM CARD PUSH PUSH (8+1PIN)	CHKD:	UNIT	mm
.X±0.20	.x'±2'					
.XX±0.15	.xx'±1'	Part NO.	Date	2012/12/31		
.XXX±0.08	.xxx'±0.5'					
SHEET	1/1	L&X 深圳市连欣科技有限公司				