

客户确认	
日期	

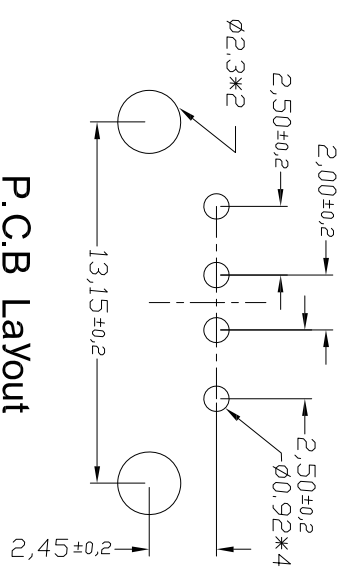
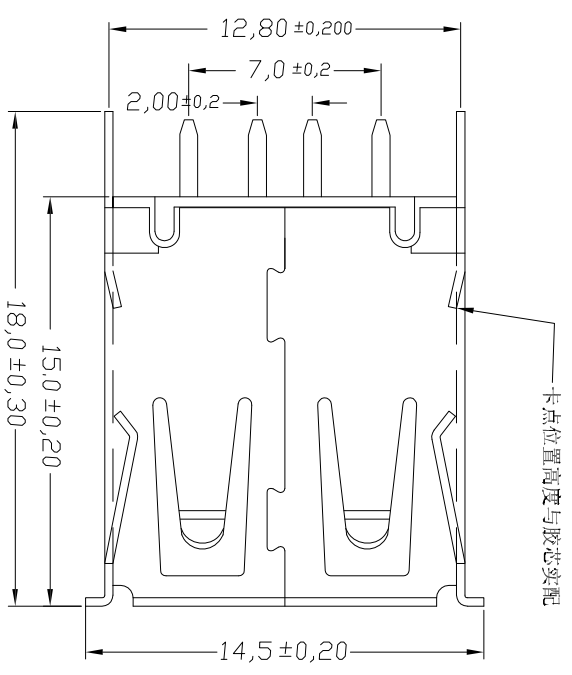
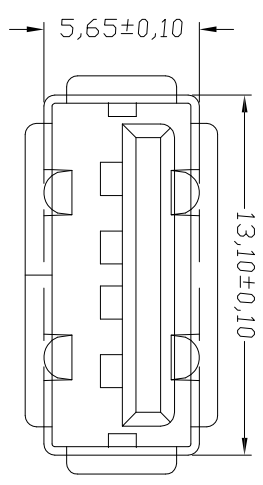
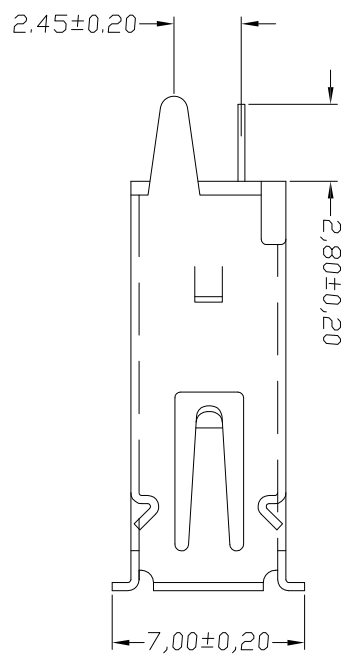

P.C.B Layout

- NOTES:
- MATERIAL:
 - Housing: thermoplastic plastics
 - terminals: Copper Alloy
 - Gold plated in contact area
 - Tin plated in termination
 - Nickel Plated overall
 - Shell: Steel & Copper Alloy
 - Nickel Plated overall
 - ELECTRICAL CHARACTERISTICS:
 - Rating Current : 1.5 Ampere
 - Rating Voltage : 30 V Max
 - Contact Resistance: 30 Milli ohms
 - Insulation Resistance: 1000 Mega ohms Min
 - MECHANICAL CHARACTERISTICS:
 - Connector Mating force: 35N MAX(3.57Kgf)
 - Connector Unmating force: 10N min(1.02Kgf)
 - Durability: 1500 Cycles.
 - ENVIRONMENT CHARACTERISTICS:
 - Operating temperature: 0°C to +50°C
 - Storage temperature: -20°C to +60°C

TOLERANCE TABLE	
.0	±0.30
.00	±0.20
.000	±0.05

APPROVED:	DATE:	Ckmtw 深圳市灿科盟实业有限公司 CHANKEMENG INDUSTRY CO., LTD
CHECKED:	DATE:	
DRAWN:	DATE:	TITLE:
SXA	2019-05-18	USB-A/F-1*4P H=15.0mm 180度直插 直脚
PROD. P/N	U-USBAS04P-F007	
UNIT	mm	SCALE
FILE NO.	Ckmtw-USB-00075	REV.
		HLMO