

注：本板为禁止传输、复制、编辑文件，以及用其内容进行交流

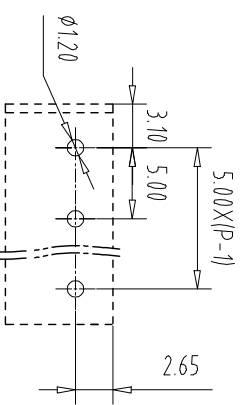
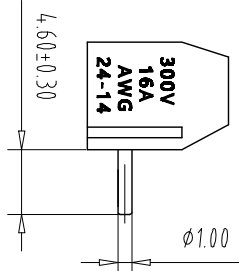
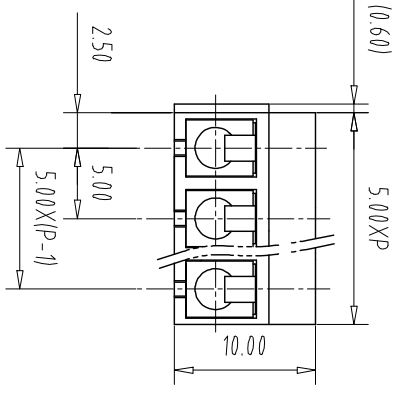
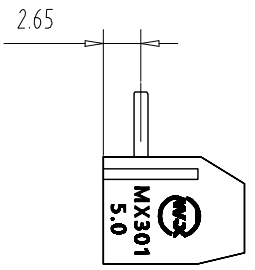
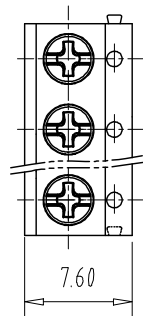

PCB Layout

Pitch	Range	In	Nominal Dimension	Range	
mm	Over 6	Over 10	Over 30	Over 60	Over 100
	TO 6	TO 10	TO 30	TO 60	TO 100
	TO 10	TO 24	TO 30	TO 60	TO 100
	±0.15	±0.20	±0.30	±0.50	±0.70
				±1.00	±1.30
					±2°

REV	ECN NO.	CONTENT	CHK	DATE

NOTES1:

- UL Standard
- 1.Rating voltage/current: 300V//16A
- 2.withstanding voltage: AC2000V//1Min
- 3.Torque value: M2.5, 3.54Lb.in
- 4.Wire range: 24~14AWG

Pollution Degree	3	2	2
Overvoltage Category	III	II	II
Rate Impulse Voltage(kV)	/	/	/
Rate Voltage(V)	/	250V	/
Rate Current(A)	/	17.5A	/

NOTES2:

- 1.Housing: PA66(UL94V-0)
- 2.Solder Pin: Copper alloy(Sn Plated)
- 3.Spring: Stainless Steel
- 4.Screw: Steel(M2.5,Zn Plated)

NOTES3:

- 1.Pitch: 5.0mm Poles: 02-22P
- 2.Stripping length: 6-7mm
- 3.Operating temperature: -40℃~+105℃
- 4.RoHS Compliance

How to order

MX301R - 5.0 - XXP - XXXX - XX - X - X

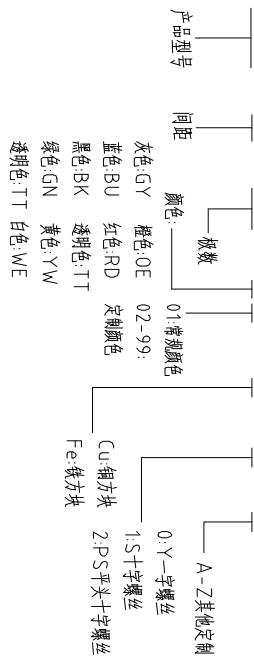

ITEM	NAME OF PART	NO. OF PART	Q'TY	MATERIAL	NOTE
DWG	CHK	DATE	SCALE	SHEET/OF	1/1
APP	DATE		1:1	A4	⊕
CIXI MAIXU ELECTRONICS CO.,LTD			NAME	MX301R-5.0-XXP	
MAIXU 慈溪市迈旭电子有限公司			DWGNO.		