

注：本板为禁止传输、复制、编辑、修改、以及用其内容进行交流

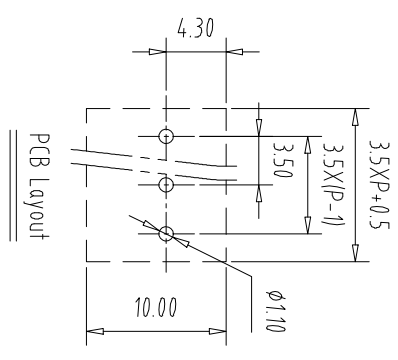
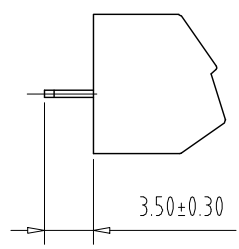
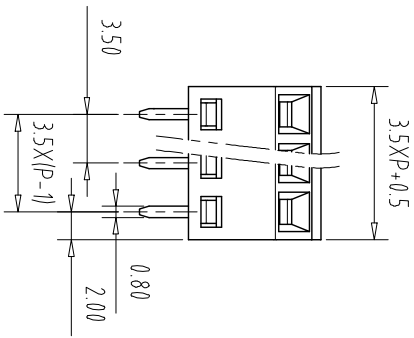
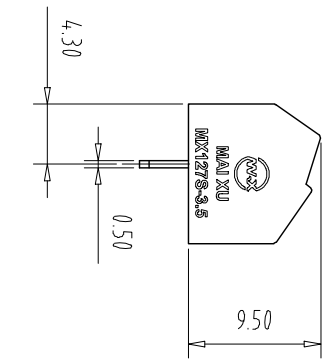
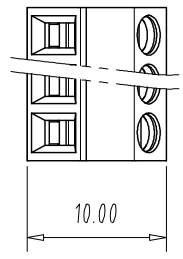

| REV | ECN NO. | CONTENT | CHK | DATE |
|-----|---------|---------|-----|------|
|     |         |         |     |      |

NOTES1:  
UL Standard

| 1.            | Use group | B | C | D    |
|---------------|-----------|---|---|------|
| Rated Current | 10A       | / | / | 10A  |
| Rated Voltage | 300V      | / | / | 300V |

- 2. Torque value: M2, 1.77LbIn
- 3. Wire range: 26~16AWG

IEC Standard

| 1.                       | Pollution Degree | 3     | 2     | 2     |
|--------------------------|------------------|-------|-------|-------|
| Overvoltage Category     | III              | III   | II    | II    |
| Rate Impulse Voltage(KV) | 2.5KV            | 2.5KV | 2.5KV | 2.5KV |
| Rate Voltage(V)          | 160V             | 200V  | 400V  | 400V  |
| Rate Current(A)          | 10A              | 10A   | 10A   | 10A   |

- 2. Torque value: M2, 0.2Nm
- 3. wire range: 0.2~1.5mm<sup>2</sup>

NOTES2:

- 1.Housing: PA66 (UL94V-0)
- 2.Cover: PA66 (UL94V-0)
- 3.Cage: Brass (Ni Plated)
- 4.Solder Pin: Copper alloy(Sn Plated)
- 5.Screw: Steel (M2,Zn Plated)

NOTES3:

- 1.Pitch: 3.5mm Poles: 02-24P
- 2.Stripping length: 5mm
- 3.Operating temperature: -40°C~+105°C
- 4.RoHS Compliance

How to order

MX127S - 35 - XXP - XXXX - XX - X - X

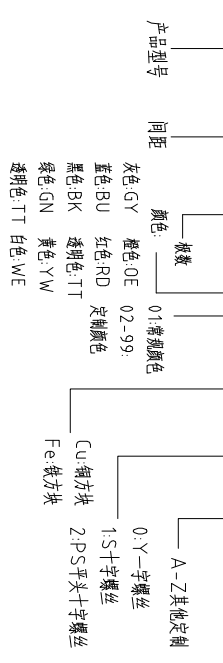

| Pitch Range In mm | Nominal Dimension Range In mm |       |       |       |       |
|-------------------|-------------------------------|-------|-------|-------|-------|
|                   | Over                          | TO    | Over  | TO    | Over  |
| 6                 | 10                            | 24    | 30    | 60    | 100   |
| 10                | 10                            | 24    | 30    | 60    | 100   |
| ±0.15             | ±0.20                         | ±0.30 | ±0.30 | ±0.50 | ±1.00 |

| ITEM                           | NAME OF PART | NO. OF PART | Q'TY           | MATERIAL | NOTE |
|--------------------------------|--------------|-------------|----------------|----------|------|
| DWG                            | CHK          | DATE        | SCALE          | SHEET/OF | 1/1  |
| APP                            | DATE         |             | 1:1            | A4       |      |
| CIXI MAIXU ELECTRONICS CO.,LTD |              |             | NAME           |          |      |
| 东莞市迈旭电子有限公司                    |              |             | MX127S-3.5-XXP |          |      |
| DWGNO.                         |              |             |                |          |      |