

## GT-TA089B-H050-L3

**G-Switch**

**Operating Force**

A=180gf  
B=250gf  
D=350gf

**Switch Height A=∅A**  
H050=5.0 A=3.2

**Switch Lifetime (Force)**

L3=300,000 Cycles  
L5=500,000 Cycles

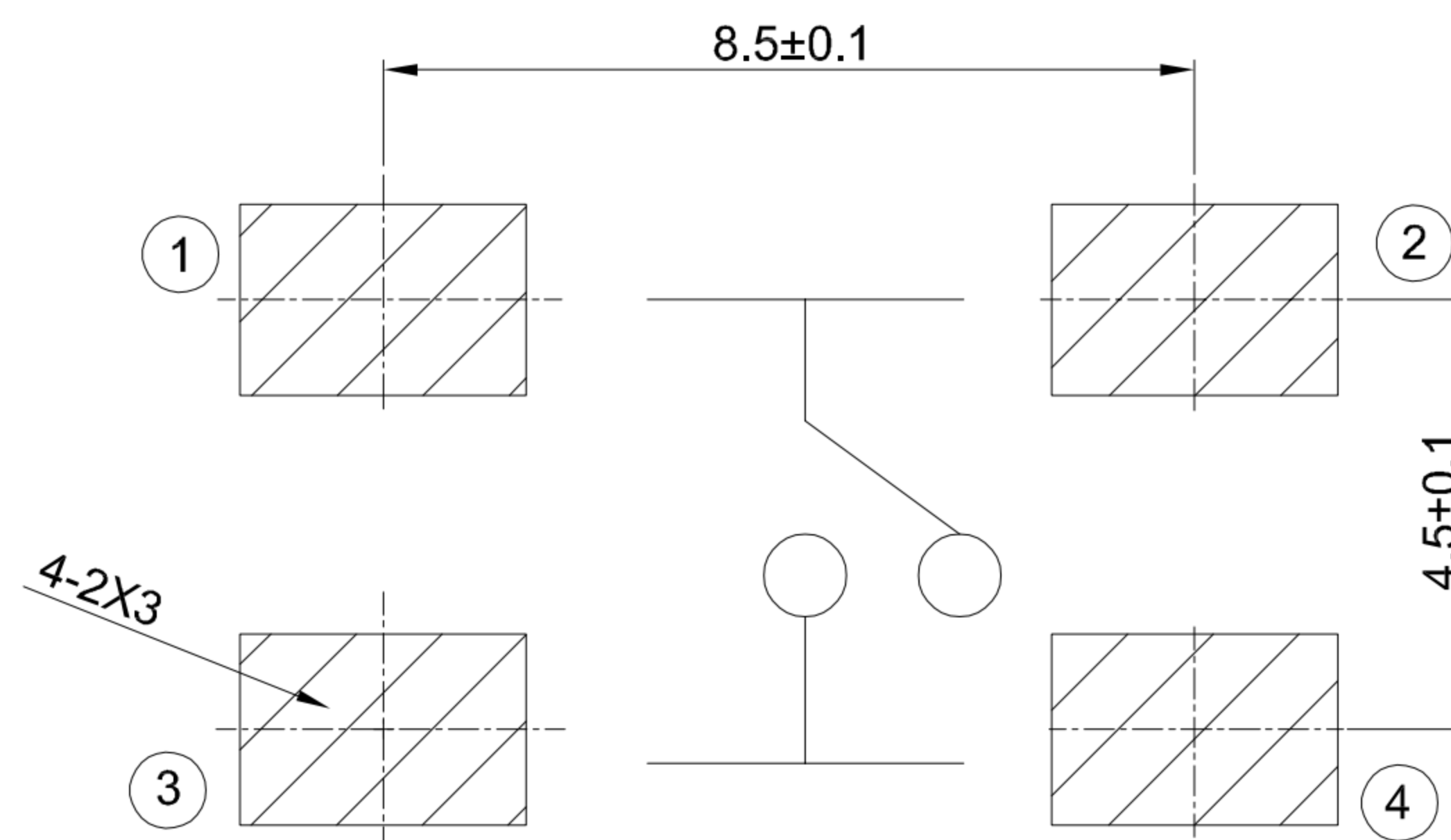
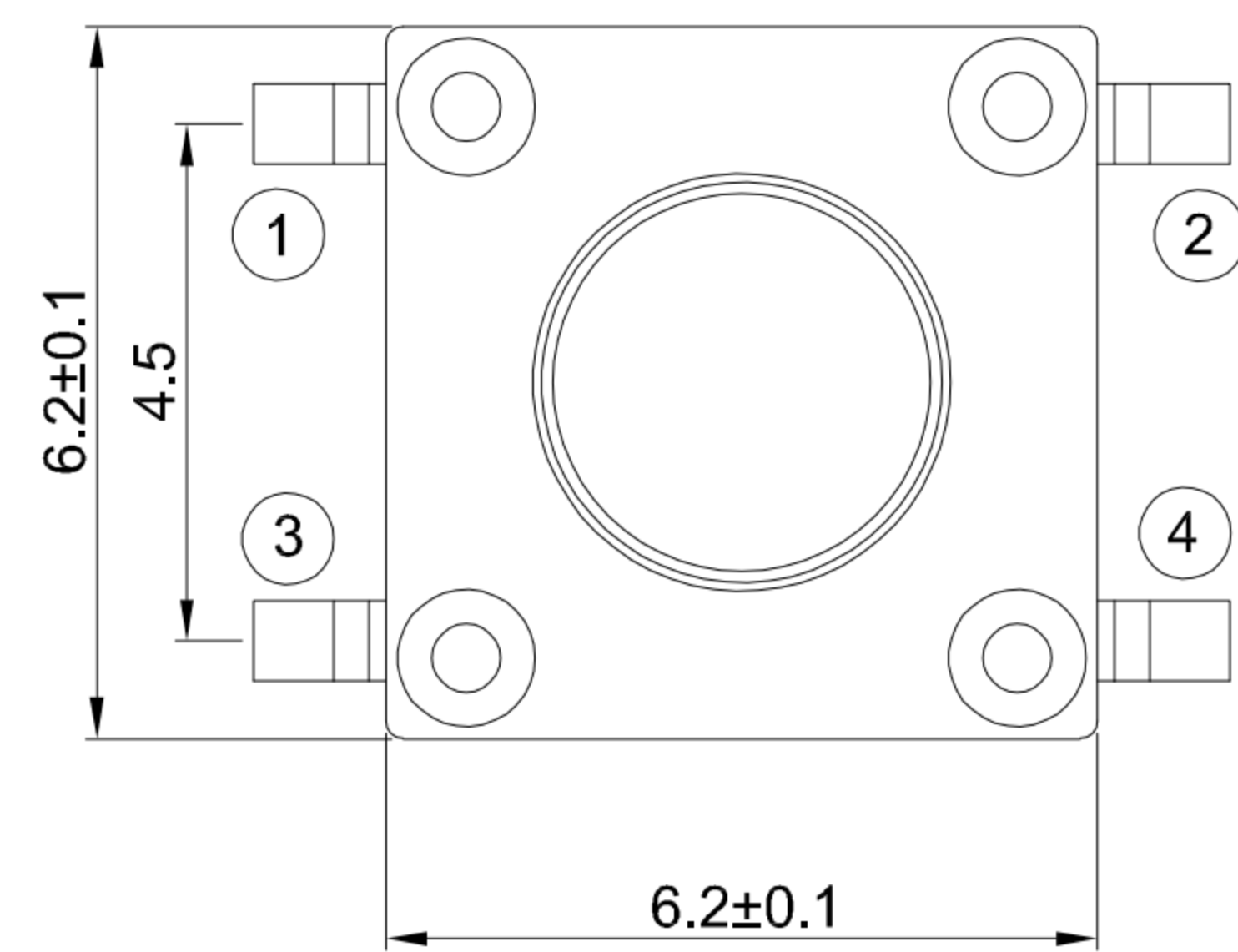

**RECOMMENDED PCB LAYOUT**  
TOLERANCE:±0.05

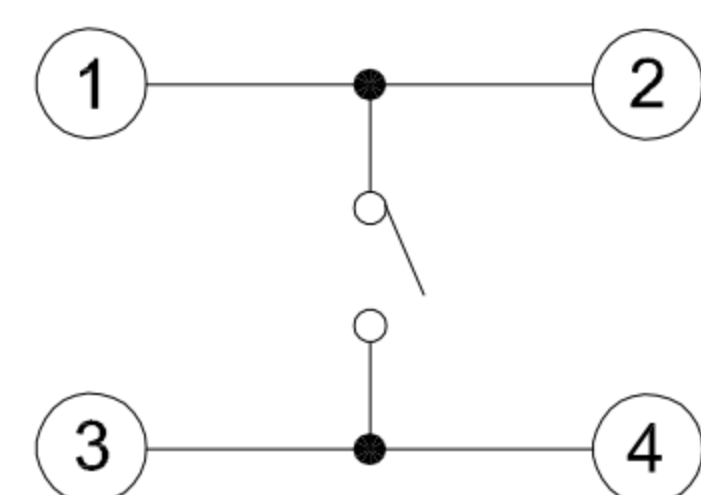

**CIRCUIT DIAGRAM**

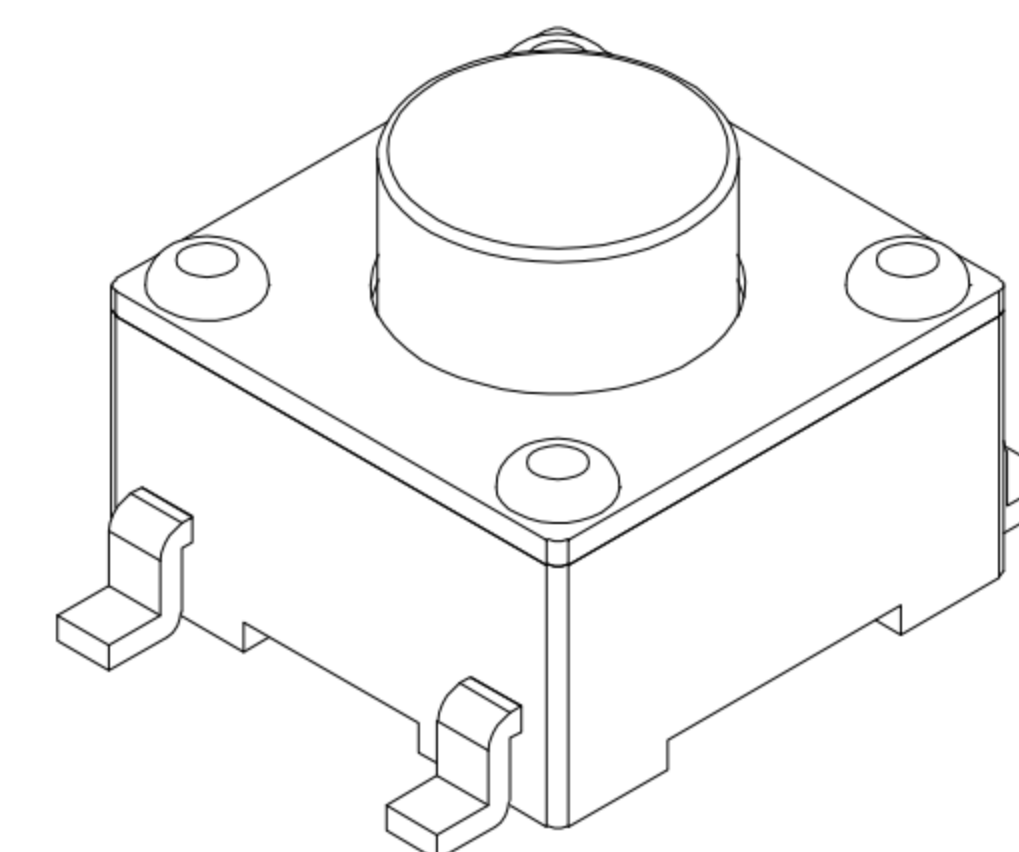

### G-Switch Specification:

1. Operating temperature range: -40°C ~ +85°C
2. Rating: 50mA, 12V DC
3. Insulation resistance: 100MΩ min. 100V DC
4. Dielectric strength: 250V AC for 1 min
5. Contact resistance: 100mΩ max.
6. Travel: 0.4±0.15mm

6	COVER	STAINLESS STEEL	Blue
5	STEM	SILICA GEL	
4	TAPE	POLYIMIDE	
3	CONTACT	STAINLESS STEEL	Ag PLATING
2	TERMINAL	COPPER ALLOY C2680	Ag PLATING
1	BASE	PA	
NO.	PART NAME	MATERIAL	REMARK

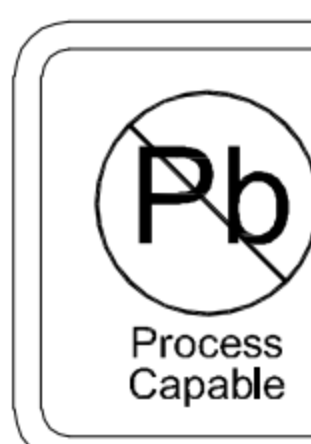

**RoHS**  
Compliant  
EU RoHS Standards



SCALE: 1:1 UNIT: mm  
SIZE: A4

Unless otherwise  
General Tolerance:  
X. /  
X.x ±0.05  
X.xx ±0.02  
X° ±0.5°

Title: Vertical Tact Switch Silica gel  
SMT 6.2×6.2×5.0mm IP65

Molde Code: GT-TA089A-H050-L3

DRAWN	CHECKED	APPROVED	DATE
Xia	Chen	Chen	2023.02.01



REV: A0 SHEET: 1/1