

02P-10P

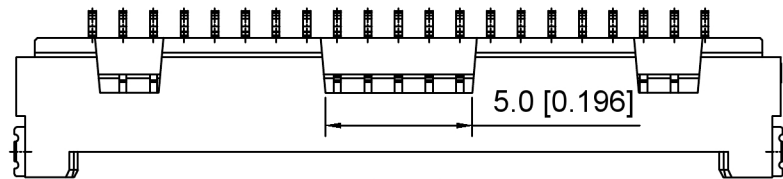

11P-20P  
(25P/30P:6.0±0.1)

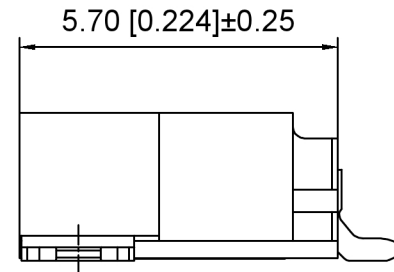
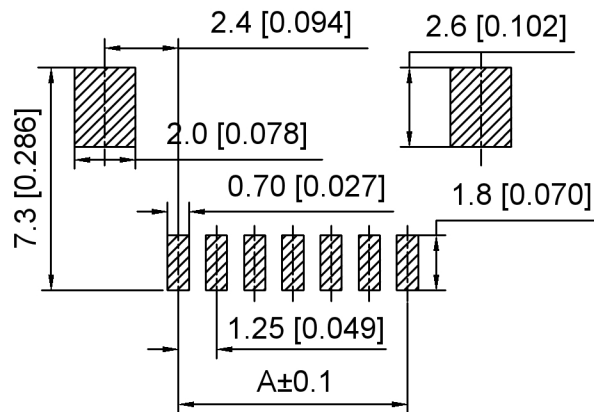
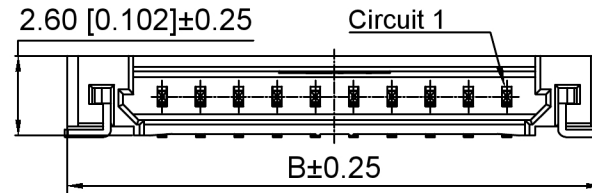

PCB Layout

Specifications:

规格:

Voltage rating: 150V AC/DC

额定电压: 150V AC/DC

Current rating: 1A AC/DC

额定电流: 1A AC/DC

Withstanding voltage: 500V AC/minute

耐受电压: 500V AC/分钟

Temperature range: -25°C-+85°C

温度范围: -25°C-+85°C

Insulation resistance: 500MΩ min

绝缘电阻: 500MΩ Min

Contact resistance: 30mΩ Max

接触电阻: 30mΩ Max

X9862 W R S -XX -6T SN

① ② ③ ④ ⑤ ⑥ ⑦

1. Series No
2. Category: W-Wafer
3. Welding Board Angle: R-Straight 90°
4. Welding Way: S-SMT
5. Row No. Pin No: XX-02P-30P
6. Material: 6T-PA6T UL94V-0 Beige
7. Plating: SN-Bright Tin Plating

Poles	DIM.(mm)	
	A	B
02	1.25	7.45
03	2.50	8.70
04	3.75	9.95
05	5.00	11.20
06	6.25	12.45
07	7.50	13.70
08	8.75	14.95
09	10.00	16.20
10	11.25	17.45
11	12.50	18.70
12	13.74	19.95
13	15.00	21.20
14	16.25	22.45
15	17.50	23.70
20	23.75	29.95
25	30.00	36.20
30	36.25	42.45

X9862WRS-XX-6TSN	PA6T	Brass	X9862H
PART NO	Material	Material(Pin)	SUITable XKB Housing

DSND	SCALE: N/A	MODEL TYPE: 1.25mm Crimp Style Connector
DWN	VIEW:	PART NO.: X9862WRS-XX-6TSN
CHKD	UNIT: mm/in	DWG NO.: X-X9862WRS-XX-6TSN
APPD	SIZE: A4	



XKB INDUSTRIAL PRECISION CO., LIMITED

广东星坤科技股份有限公司

△X	日期
△X	日期
△X	日期
MARK	DESCRIPTION

文件工程章

REVISIONS	DATE	REVISED	APPROVED	UNSPECIFIED TOLERANCES
				ANGLAR ±5°
				L ≤ 4 ±0.2
				4 < L ≤ 16 ±0.3
				16 < L ≤ 63 ±0.4
				L > 63 ±0.5

www.helloxkb.com www.helloxkb.cn www.xk-dg.cn

WEIGHT	SHEET	REVISION
	1/1	A0