



TAI-SAW TECHNOLOGY CO., LTD.

No. 3, Industrial 2nd Rd., Ping-Chen Industrial District,
Taoyuan, 324, Taiwan, R.O.C.

TEL: 886-3-4690038 FAX: 886-3-4697532

E-mail: tstsales@mail.taisaw.com Web: www.taisaw.com

Approval Sheet For Product Specification

Issued Date: 2007/07/18

Product Name: SAW Filter 1950 MHz

TST Parts No.: TA0235A

Customer Parts No.: _____

Company: _____
Division: _____
Approved by : _____
Date: _____

Checked by: Bob Chau

Approval by: Francis Chen

Date: 2007/07/18



TAI-SAW TECHNOLOGY CO., LTD.

No. 3, Industrial 2nd Rd., Ping-Chen Industrial District,
Taoyuan, 324, Taiwan, R.O.C.

TEL: 886-3-4690038 FAX: 886-3-4697532

E-mail: tstsales@mail.taisaw.com Web: www.taisaw.com

SAW Filter 1950 MHz for 3G Applications

MODEL NO.: TA0235A

REV. No.:4

A. Maximum Rating:

1. Input Power Level: 13 dB_m
2. DC voltage: 0 V
3. Operating Temperature: -40°C to +85°C
4. Storage Temperature: -40°C to +85°C

RoHS Compliant
 Lead free
 Lead-free soldering

B. Electrical Characteristics:

Parameter	Min.	Typ.	Max.	Unit
Center Frequency, Fc	-	1950	-	MHz
Insertion Loss, IL within 1920 ~1980 MHz	-	2.3	4	dB
Amplitude Ripple (p-p) within 1920 ~ 1980 MHz	-	1.4	2.4	dB
Attenuation (Reference level from 0 dB)				
DC ~ 1840 MHz	20.0	32.0	-	dB
1840 ~ 1900 MHz	10.0	21.0	-	dB
2000 ~ 2030 MHz	4.5	10.0	-	dB
2030 ~ 2060 MHz	20.0	47.0	-	dB
2060 ~ 5000 MHz	22.0	29.0	-	dB
VSWR within 1920 ~1980 MHz	-	1.7	2.4	
Source Impedance, Z_s	-	50	-	Ω
Load Impedance, Z_L	-	50	-	Ω

Note1. No matching network required for operation at 50 Ω

C. Frequency Characteristics:

Transfer function

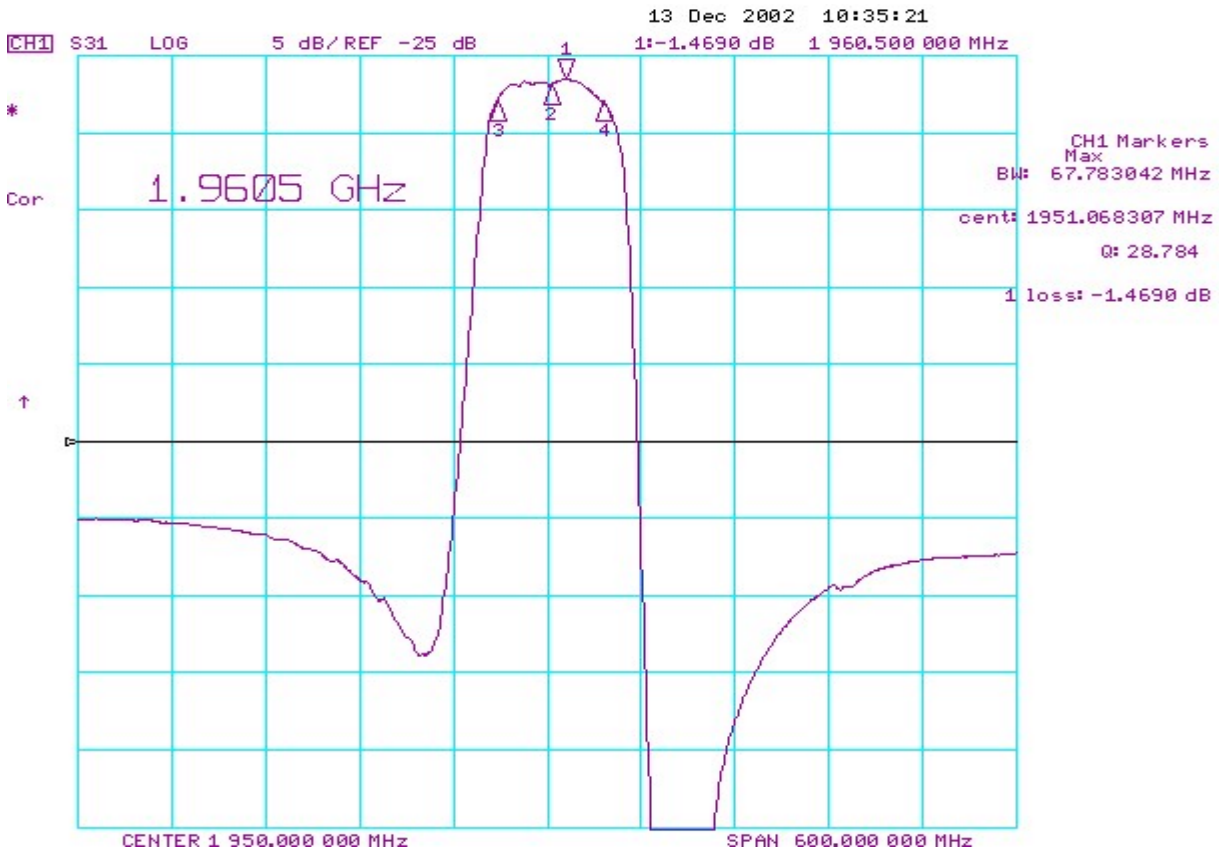

Wideband Response

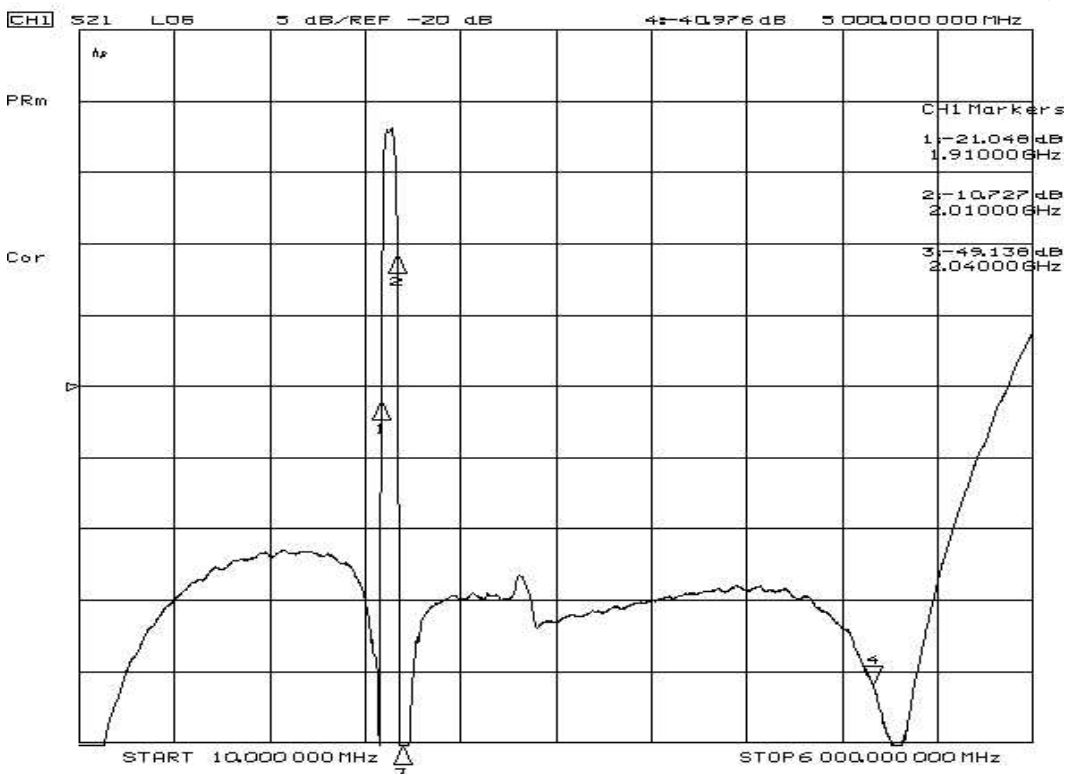

Input VSWR

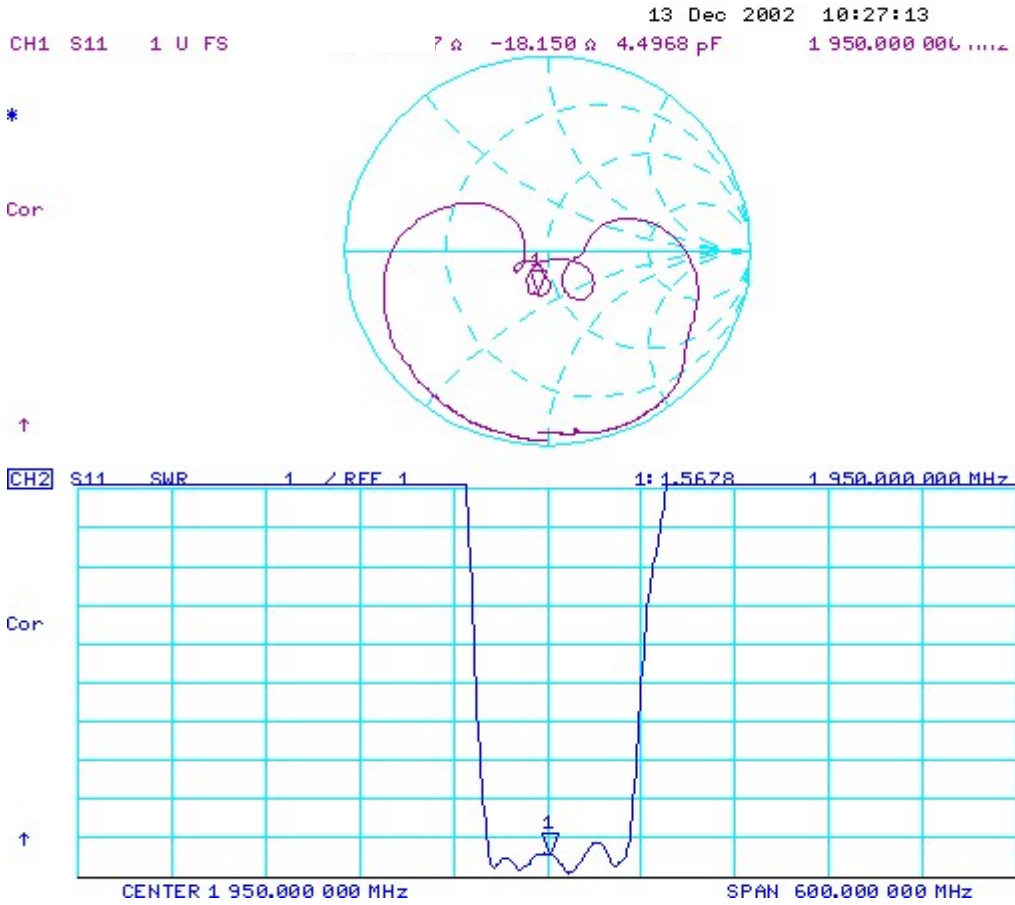

Output VSWR

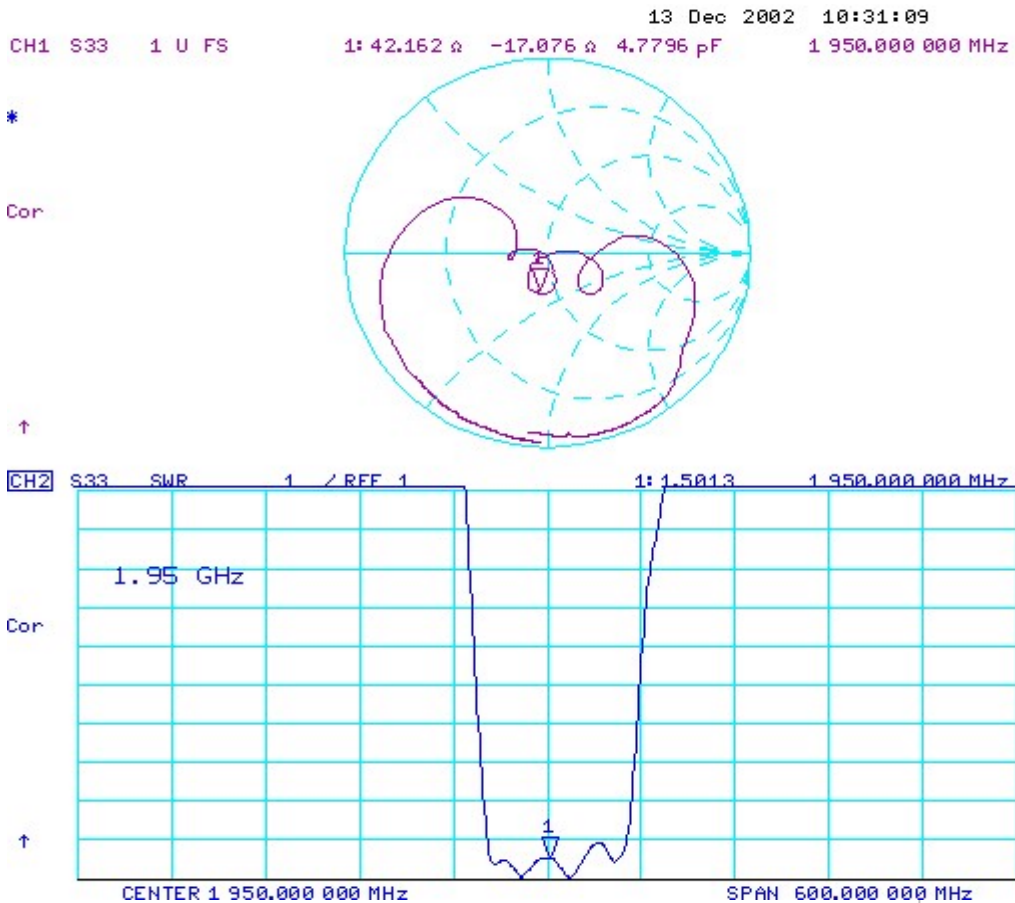

D. Measurement Circuit:

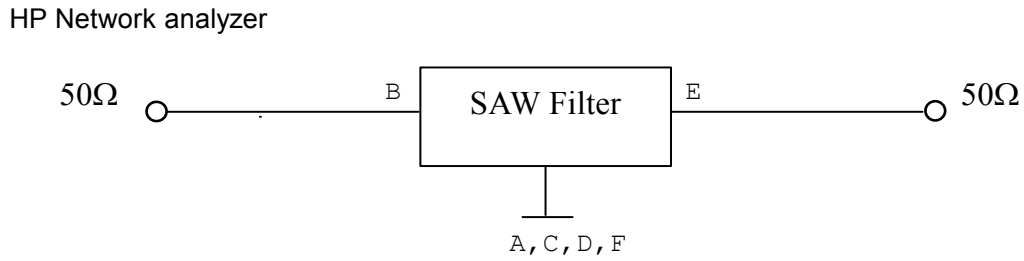

E. Outline Drawing:

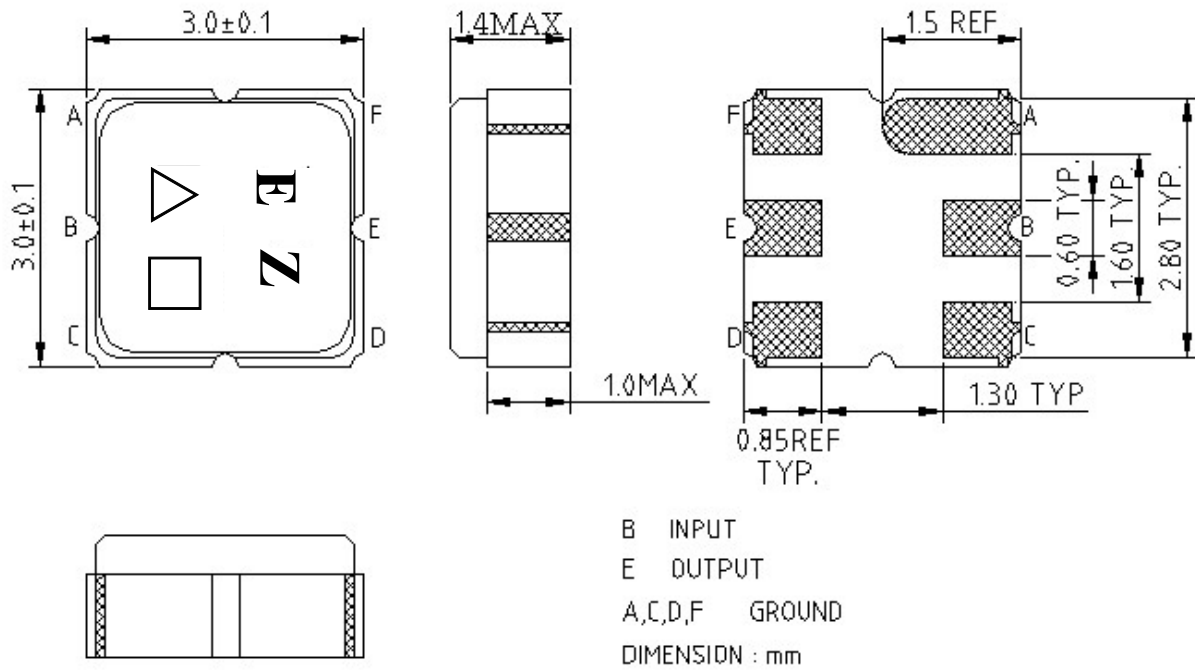

△ : Year Code (2006->6, ..., 2009->9)

□ : Date Code (Follow the table from planner each year)

F. Packing:

1. Reel Dimension

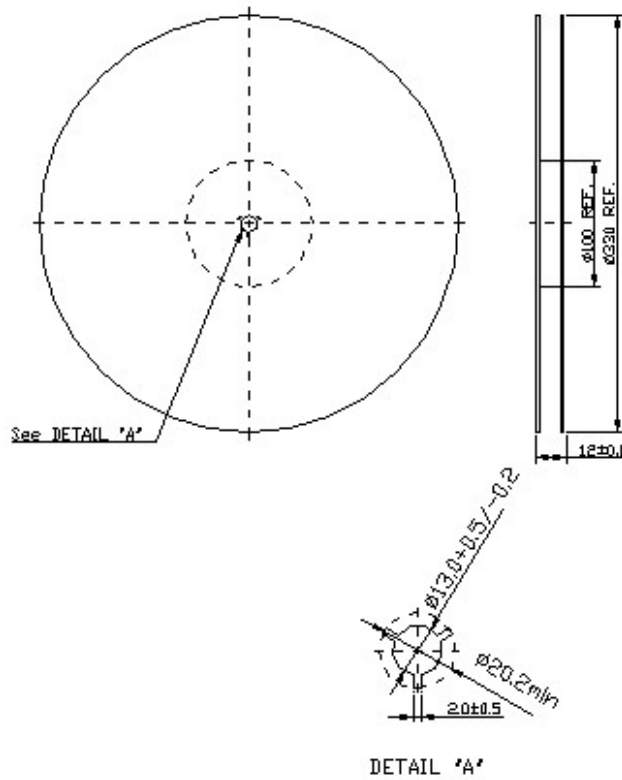

2. Tape Dimension

