

REV.	ECN. NO.	APPD.
A		

SPECIFICATIONS

Current Rating: 1A AC, DC
Voltage Rating: 250V AC, DC
Temperature Range: -25°C ~ +130°C
Contact Resistance: 20mΩ Max
Insulation Resistance: 1000MΩ Min
Withstanding Voltage: 1000V AC/minute
Material
Wafer: LCP UL94V-0
PIN: C2680 Tin-plated
Fixed piece: C2680 Tin-plated

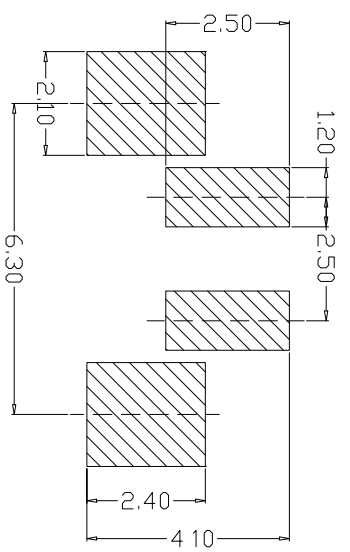
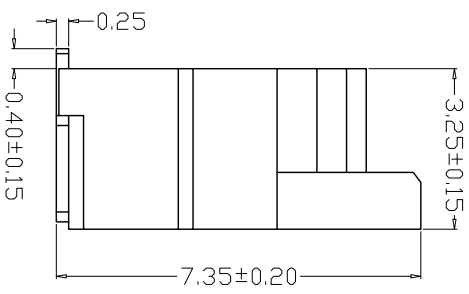
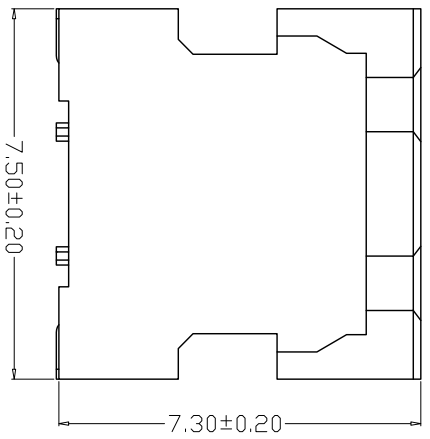
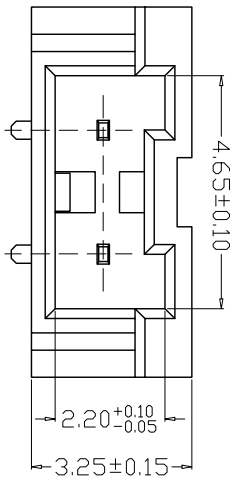
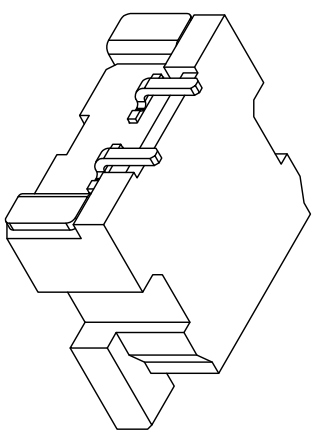

PCB LAYOUT

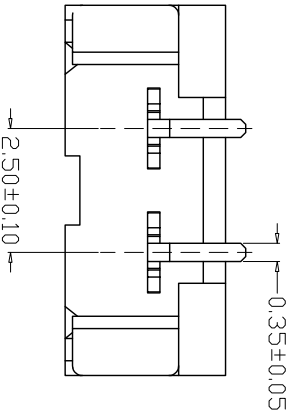

X. ±0.30	X.° ±5°	UNITS mm	NAME (INTENDED USE)	MINTRON CO., LTD.
X ±0.20	X° ±2°	MATL	PART NO. (INTENDED USE)	
.XX ±0.10	.XX° ±1°	FINISH	APPD: SUNNY	DWG NO.: MT25001-02A
.XXX ±0.05	.XXX° ±0.5°		QTY	CHKD: USA
FLAT CABLE CONNECTOR			DR: ZOE	2023-06-16
			2023-06-16	SHEET 1/1
				REV. A