

REV.	LOCAS.	DESCRIPTION	DATE	DRAWN
01	NEW	INITIAL RELEASE.	2006.04.24	杜金良
02		修正端子材料名稱	2006.10.23	杜金良
03		變更料號	2009.03.02	林澤云
04		變更圖號	2012.06.11	黃小燕

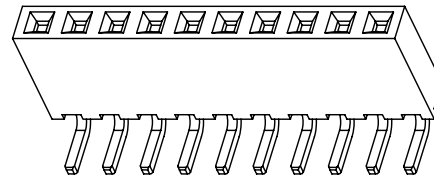

Specifications  
 Current Rating: 2Amp  
 Insulation Resistance: 1000MΩMin.  
 Dielectric Withstanding Voltage: 500VAC  
 Contact Resistance: 20mΩMax.  
 Operating Temperature: -40°C to +105°C  
 Materials  
 Contact Material: Phosphor Bronze  
 Insulator Material: High Temperature Thermoplastic, UL 94V-0 LCP or the equivalent material  
 All materials must meet Greenconn requirement for environment protection.

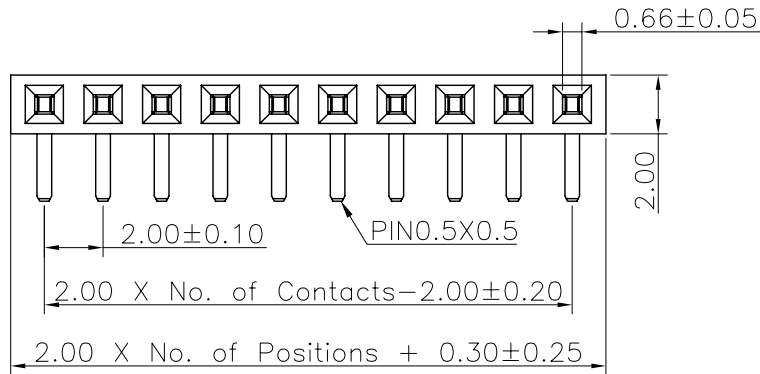
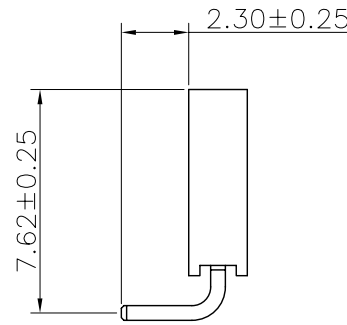
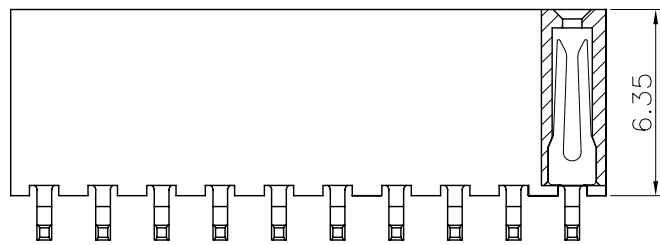

### Ordering Information



Recommended P.C.Board Layout  
 (Tolerance: ±0.05)

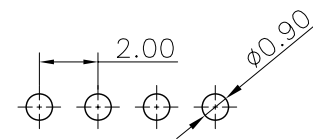

格稜股份有限公司  
**Greenconn Corporation**

GENERAL TOLERANCE	
X.*±5.0°	X.±0.30
.X*±3.0°	.X±0.25
.XX*±2.0°	.XX±0.15
.XXX*±1.0°	.XXX±0.10

DESIGN: 黃小燕	DATE: 2012.06.11
CHECKED: 劉北平	DATE: 2012.06.11
AUDITED: 李輝	DATE: 2012.06.11
APPROVED: cc_li	DATE: 2012.06.11

DWG. NO.	
CSFB107-CA1CA	
PART NO.	
CSFB107-XXXX A001C1AX	

TITLE.
2.00 FEMALE HEADER SINGLE ROW R/A DIP TYPE SIDE ENTRY

REV. 04	UNIT. mm	SCALE. 4:1	PAGE. 1/1	
---------	----------	------------	-----------	--