

1. Features

- Low profile
- Magnetic shielded
- SMT type, suitable for reflow soldering.



2. APPLICATIONS

- Portable communication equipment
- Notebook Computer
- DC/DC converters etc.

3. PRODUCT IDENTIFICATION

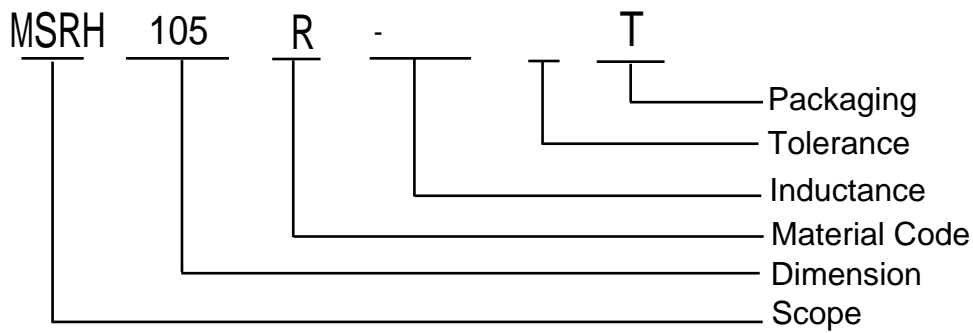

4. Shape and Dimensions

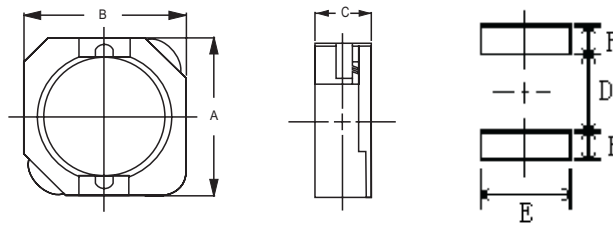

Unit: mm

| Part | A | B | C | D | E | F |
|----------|----------|----------|--------|-----|-----|-----|
| MSRH105R | 10.2±0.3 | 10.0±0.3 | 5.0MAX | 7.8 | 3.0 | 1.2 |

Appendix A: Electrical Characteristics
I. MSRH105R TYPE INDUCTORS ELECTRICAL CHARACTERISTICS&TEST CONDITIONS

| Part Number | L (μH) | Tolerance | Test Freq. | DCR(Ω)Max | Isat(A) |
|----------------|--------|-----------|------------|-----------|---------|
| MSRH105R-100MT | 10 | ±20% | 1kHz,0.25v | 0.026 | 5.35 |
| MSRH105R-120MT | 12 | ±20% | 1kHz,0.25v | 0.033 | 4.50 |
| MSRH105R-150MT | 15 | ±20% | 1kHz,0.25v | 0.041 | 4.15 |
| MSRH105R-180MT | 18 | ±20% | 1kHz,0.25v | 0.046 | 3.85 |
| MSRH105R-220MT | 22 | ±20% | 1kHz,0.25v | 0.061 | 3.60 |
| MSRH105R-270MT | 27 | ±20% | 1kHz,0.25v | 0.069 | 3.25 |
| MSRH105R-330MT | 33 | ±20% | 1kHz,0.25v | 0.084 | 2.95 |
| MSRH105R-470MT | 47 | ±20% | 1kHz,0.25v | 0.130 | 2.38 |
| MSRH105R-680MT | 68 | ±20% | 1kHz,0.25v | 0.201 | 1.90 |
| MSRH105R-820MT | 82 | ±20% | 1kHz,0.25v | 0.227 | 1.75 |
| MSRH105R-101MT | 100 | ±20% | 1kHz,0.25v | 0.253 | 1.61 |
| MSRH105R-151MT | 150 | ±20% | 1kHz,0.25v | 0.370 | 1.39 |
| MSRH105R-181MT | 180 | ±20% | 1kHz,0.25v | 0.419 | 1.24 |
| MSRH105R-221MT | 220 | ±20% | 1kHz,0.25v | 0.500 | 1.17 |
| MSRH105R-271MT | 270 | ±20% | 1kHz,0.25v | 0.672 | 0.97 |
| MSRH105R-331MT | 330 | ±20% | 1kHz,0.25v | 0.812 | 0.89 |
| MSRH105R-471MT | 470 | ±20% | 1kHz,0.25v | 1.289 | 0.77 |
| MSRH105R-102MT | 1000 | ±20% | 1kHz,0.25v | 1.989 | 0.56 |

Products with other electrical characteristic can be provided upon customer's request. Please contact your local sales.